



## Altham Grove, Harlow, CM20 2PW

Geoffrey Matthew Estates are delighted to offer this very well presented, three bedroom, end of terrace house in the ever popular residential area of Altham Grove. Ideally located, backing onto the town park, the house offers easy access to the mainline station and local schools and amenities. Benefitting from three good size bedrooms, spacious lounge and kitchen and a generous rear garden. This property is certain to prove popular. Early viewings are highly recommended!

Offers In The Region Of £375,000

# Altham Grove, Harlow, CM20 2PW



- Three Bedrooms
- Backing Onto Town Park
- End Of Terrace
- Close To Train Station
- Generous Rear Garden
- Close To Schools & Amenities

## Entrance

## Hallway

## living Room

19'7 x 11'1 (5.97m x 3.38m)

## Kitchen

10'1 x 10'10 (3.07m x 3.30m)

## Kitchen (Continued)

7'3 x 6'10 (2.21m x 2.08m)

## First Floor Landing

## Bedroom

12'1 x 11' (3.68m x 3.35m)

## Bedroom

10' x 8'11 (3.05m x 2.72m)

## Bedroom

8'8 x 7'10 (2.64m x 2.39m)

## Bathroom

7'3 x 7'10 (2.21m x 2.39m)

## Agents Note

The front of the property is pedestrianised. On street parking only

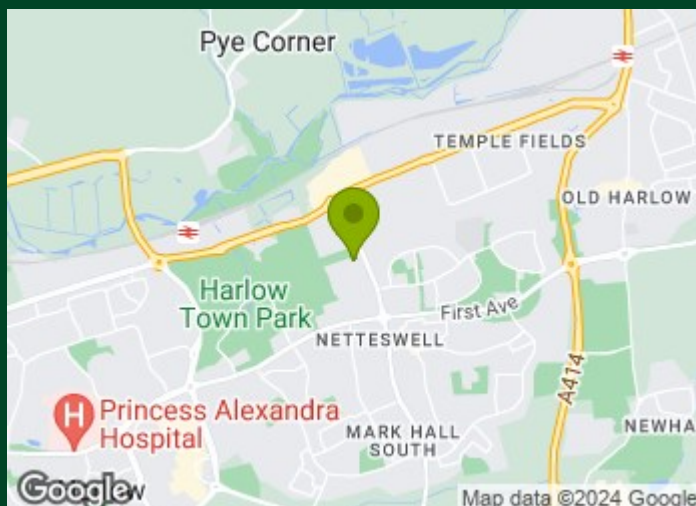

## Directions



# Floor Plan

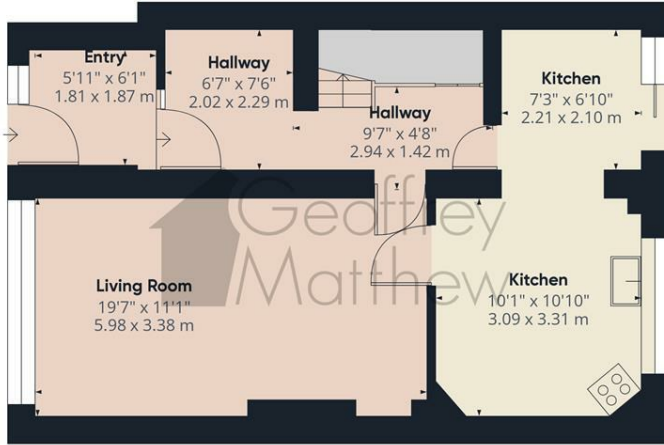

Floor 0

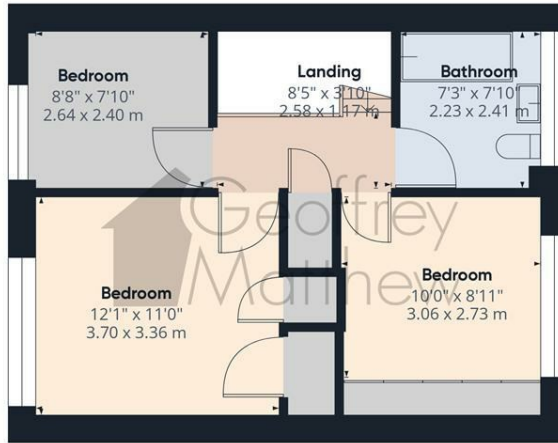

Floor 1



Approximate total area<sup>(1)</sup>  
972.05 ft<sup>2</sup>  
90.31 m<sup>2</sup>

(1) Excluding balconies and terraces

While every attempt has been made to ensure accuracy, all measurements are approximate, not to scale. This floor plan is for illustrative purposes only.

GIRAFFE360

## Council Tax Details

Harlow Band C

These particulars, whilst believed to be accurate are set out as a general outline only for guidance and do not constitute any part of an offer or contract. Intending purchasers should not rely on them as statements of representation of fact, but must satisfy themselves by inspection or otherwise as to their accuracy. No person in this firm's employment has the authority to make or give any representation or warranty in respect of the property.

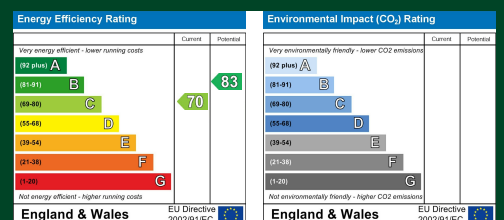

Old Harlow: 01279 444988 Email: harlow@geoffreymatthew.co.uk  
Great Ashby: 01438 740111 Email: greatashby@geoffreymatthew.co.uk