



## Morningtons, Harlow, CM19 4QH

OFFERS BETWEEN £425,000 - £450,000!

Geoffrey Matthew Estates are delighted to offer this beautifully presented, three bedroom, semi detached family home in the much sought after residential location of Morningtons. Set in a quiet cul-de-sac, the property has been lovingly updated by the current owners and the property enjoys spacious living accommodation, integral garage and driveway and a tiered garden with an outbuilding, with power connected, housing the hot tub.

This property is sure to prove popular so early viewings are highly recommended!

**Price Guide £425,000**

# Morningtons, Harlow, CM19 4QH



- Three Bedroom Semi Detached House
- Quiet Cul-De-Sac
- Garage & Driveway
- Conservatory
- Fitted Kitchen
- Viewing Recommended

## Accommodation Comprises:

### Hallway

### W.C

### Living Room

18' x 11'7 (5.49m x 3.53m )

### Kitchen

17'11 x 8'6 (5.46m x 2.59m)

### Sun Room

8'9 x 9'8 (2.67m x 2.95m)

### Landing

### Bedroom

13'9 x 8'11 (4.19m x 2.72m)

### Bedroom

13'10 x 8'10 (4.22m x 2.69m)

### Bedroom

11'1 x 8'9 (3.38m x 2.67m)

### Bathroom

5'7 x 7' (1.70m x 2.13m)

### Garage

16'4 x 8'6 (4.98m x 2.59m)

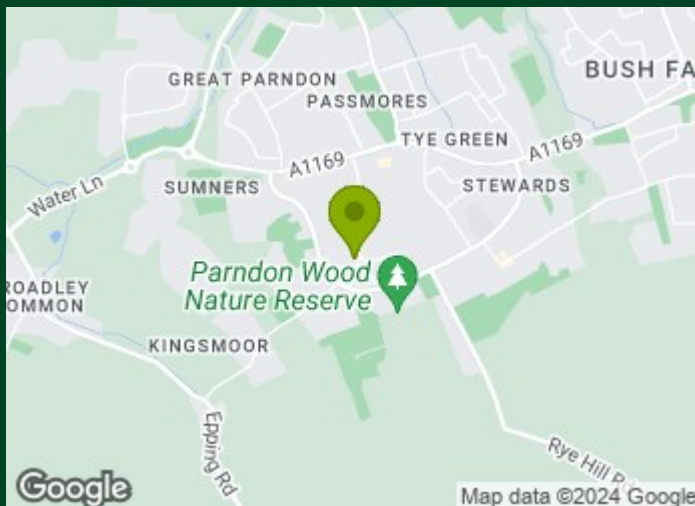

## Directions



# Floor Plan

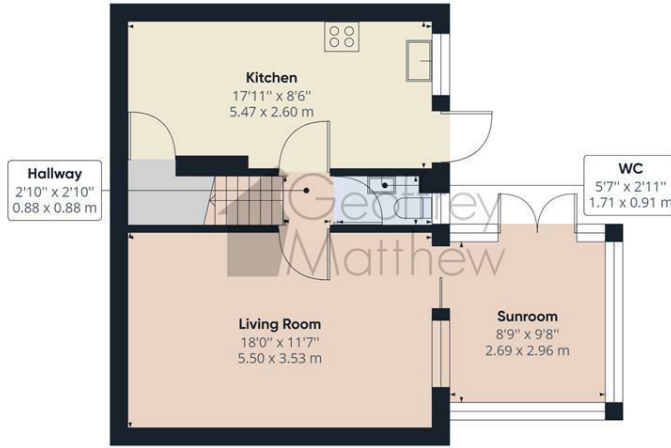

Floor 0

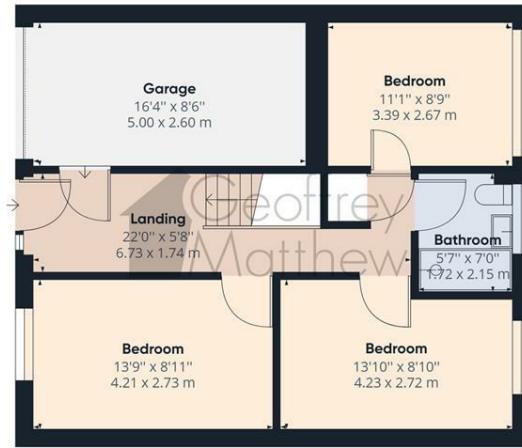

Floor 1



Approximate total area<sup>(1)</sup>  
1145.32 ft<sup>2</sup>  
106.40 m<sup>2</sup>

(1) Excluding balconies and terraces

While every attempt has been made to ensure accuracy, all measurements are approximate, not to scale. This floor plan is for illustrative purposes only.

GIRAFFE360

## Council Tax Details

Harlow Band C

These particulars, whilst believed to be accurate are set out as a general outline only for guidance and do not constitute any part of an offer or contract. Intending purchasers should not rely on them as statements of representation of fact, but must satisfy themselves by inspection or otherwise as to their accuracy. No person in this firm's employment has the authority to make or give any representation or warranty in respect of the property.

