



## Wisteria House North Street

Salisbury, SP5 5EN

£510,000



A lovely well proportioned detached house in the heart of this thriving and attractive village. Wisteria House is a modern family home which has a long list of appealing features, only truly appreciated by an internal viewing. The property is naturally double glazed with oil fired heating, benefits include two reception rooms, useful utility/boiler room, master bedroom with ensuite and cloakroom. The light and airy accommodation comprises entrance hall, sitting room, dining room, 4.45m kitchen, utility room, three double bedrooms, two bathrooms and cloakroom. Outside Wisteria House has two generous parking spaces and an attractive and manageable rear garden.



## Location

Located in Broad Chalke, Wisteria House is a very short walk to the village pub and shop/post office, the village is lucky to have an outstanding primary school as well as church and village hall. The setting provides access to great walking through the Chalke Valley with Wilton and Salisbury both within easy reach.

## Directions

Proceed from Salisbury to Coombe Bissett turning right onto the Stratford Tony Road, follow this road through Bishopstone and Croucheston. On reaching Broad Chalke follow the High Road past the shop and pub and as it bends right, turning into North Street, Wisteria House can be found on the right-hand side.

## Front Door

### Entrance Hall

Stairs to first floor. Radiator. Laminate floor.

### Cloakroom

White WC and wash hand basin with tiled splash back. Radiator. Laminate floor.

### Lounge 13'9" x 17'8" (4.2m x 5.4m )

Double glazed window to front aspect and doors to rear garden. Two radiators. Television aerial point.

### Dining Room 11'1" x 8'2" (3.4m x 2.5m )

Double glazed window to front aspect. Radiator and wall lights.

### Kitchen 14'7" x 9'10" (4.45m x 3m )

Matching wall and base units with worksurface over. Space for electric range style cooker, integral dishwasher and fridge, there is also space for fridge/freezer. Inset 1 ¼ bowl stainless steel sink unit with mixer tap. Tiled splash backs, radiator, double glazed window to rear aspect and ceiling spotlights.

### Utility 6'6" x 6'0" (2m x 1.85m )

Base unit with stainless steel sink unit with mixer tap over. Plumbing and space for washing machine. Floor mounted Grant oil fired boiler, radiator and part glazed door to the rear garden.

## First Floor Landing

Double glazed windows to front and rear aspects. Access to loft space, full height airing cupboard with pressurized hot water tank and two radiators.

### Master Bedroom 14'7" x 10'5" (4.45m x 3.2m )

Double glazed window to front aspect. Radiator.

#### Ensuite

White suite comprising Wc, pedestal basin and corner shower enclosure with thermostatic controls and 'wet wall' splash backs. Obscure double-glazed window to rear aspect, radiator and ceiling spotlights.

### Bedroom Two 13'9" x 9'10" (4.2m x 3m )

Double glazed window to front aspect. Radiator.

### Bedroom Three 11'5" ext to 13'9" x 7'6" (3.5m ext to 4.2m x 2.3m )

Double glazed window to rear aspect. Radiator.

### Family Bathroom 7'8" x 6'6" (2.35m x 2m )

White suite comprising WC, pedestal basin and pannelled bath with mixer/shower attachment over. Tiled splash back, obscure double-glazed window to rear aspect, heated towel rail and ceiling spotlights.

## Outside

To the front of the house is a well-stocked flower bed with a step leading up to the front door. Outside light.

To one side of the house is a shared driveway (one other property) leading to the rear, this driveway splits and provides two very generous parking spaces and rear pedestrian access.

Immediately outside the kitchen and sitting room doors is a generous patio area which stretches the entire width of the house with a gate to the drive/parking, outside light and tap. Beyond is an L-shaped level lawn with a lovely range of well stocked flower beds. The garden is very well enclosed by wall and wooden fencing. Garden shed and oil tank.

## Agent's Note

Foul drainage is via a private treatment plant, split between 3 properties, with a current maintenance charge of £500 per annum.

## Area Map



## Floor Plans

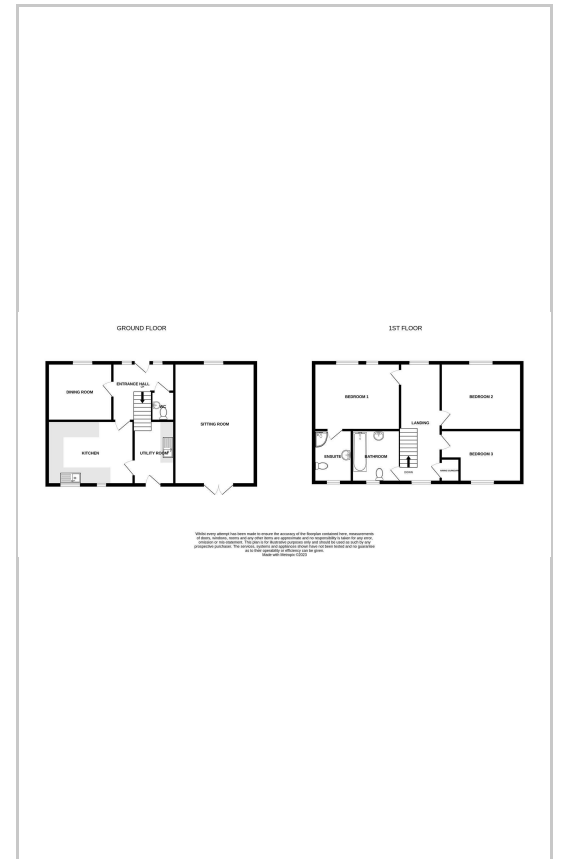

## Energy Efficiency Graph

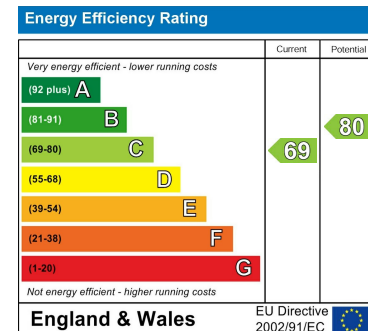

These particulars, whilst believed to be accurate are set out as a general outline only for guidance and do not constitute any part of an offer or contract. Intending purchasers should not rely on them as statements of representation of fact, but must satisfy themselves by inspection or otherwise as to their accuracy. No person in this firm's employment has the authority to make or give any representation or warranty in respect of the property.

St Mary's House Netherhampton Business Park, Salisbury, SP2 8PU

Tel: 01722 411151 Email: enquiries@venditum.co.uk <https://www.venditum.co.uk>