

St. Martins Place

Birmingham City Centre

B15 1EF

Offers over £450,000

Luxurious Penthouse Apartment

Wrap-Around Roof Terrace

969 Sq. Ft.

24 Hour Resident Services Concierge



Property Description

DESCRIPTION A fantastic opportunity to purchase a stunning three-bedroom PENTHOUSE apartment in St Martin's Place.

St Martin's Place is Birmingham's most exclusive luxury residential development, located in one of the city's highest sought-after postcodes, minutes from the main business and professional district. 228 exquisitely designed, spacious apartments complete with smart features, and impressive floor to ceiling windows that create a welcoming, light ambience, St Martin's Place exudes style and sophistication.

An unrivalled destination within the second city, all residents benefit from access to the first-class services of the neighbouring Park Regis Hotel, coupled with a full suite of exclusive on site and hotel facilities including state-of-the-art gym, WiFi lounge, private cinema, spa, bar and restaurant. These landmark luxury residences offer a truly unique living experience in the heart of the second city, designed to appeal to the most discerning, executive tenant.

St Martins Place epitomises the ultimate in luxury, high end city living inviting residents to live like a VIP in the heart of Birmingham, with an array of hotel services at their fingertips. Its destination entrance creates a hotel style arrival experience, welcoming you into an impressive grand double height lobby with sumptuous interior features and exceptional concierge service.

A FIRST FOR BIRMINGHAM St Martins Place is the first development to bring private superior hotel services to Birmingham's executive residential sector. Residents benefit from an unrivalled menu of available services from the neighbouring Park Regis Hotel, ordered as required via an exclusive hotel app or the onsite, 24-hour concierge. With options including room service, ironing and dry cleaning, for the busy professional this means peace of mind that their home doesn't become neglected in favour of their busy work life, and they need never be short of a freshly pressed suit.

SERVICES AVAILABLE INCLUDE * Apartment cleaning and bed-turning



Floor Layout

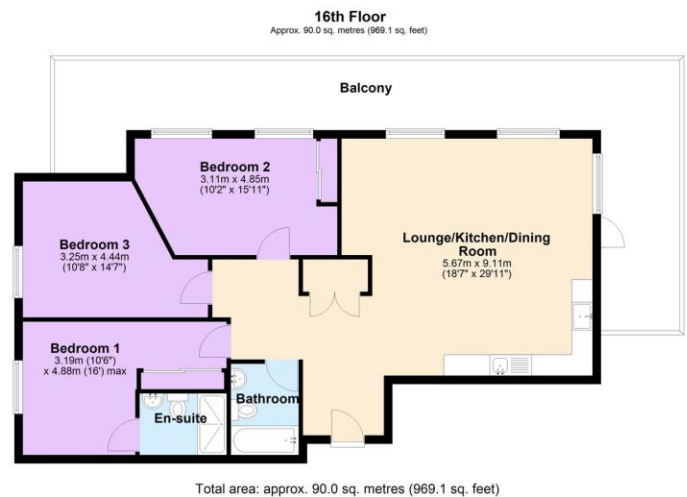

Total approx. floor area 969 sq ft (90 sq m)

Whilst every attempt has been made to ensure the accuracy of the floor plan contained here, measurements of doors, windows, rooms and any other items are approximate and no responsibility is taken for any error, omission, or mis-statement. This plan is for illustrative purposes only and should be used as such by any prospective purchaser. The services, systems and appliances shown have not been tested and no guarantee as to their operability or efficiency can be given. Made with Metropix ©2019.

Energy Efficiency Rating			
Score	Energy rating	Current	Potential
92+	A		
81-91	B		
69-80	C	70 C	70 C
55-68	D		
39-54	E		
21-38	F		
1-20	G		

Birmingham City Centre Branch

0121 6044060

info@jameslaurenceuk.com

33 Ludgate Hill, Birmingham, B3 1EH

James Laurence
James Laurence

Agents Note: Whilst every care has been taken to prepare these sales particulars, they are for guidance purposes only. All measurements are approximate are for general guidance purposes only and whilst every care has been taken to ensure their accuracy, they should not be relied upon and potential buyers are advised to recheck the measurements