



**Oliver
Minton**
Sales & Lettings

The Enclosure Arches Hall
Latchford, Nr Standon, SG11 1QY
Price Guide £1,100,000



The Enclosure, Arches Hall

Latchford, Nr Standon, SG11 1QY

Oliver Minton Village & Rural Homes are delighted to offer this stunning semi-detached barn conversion, superbly appointed within the Arches Hall farm complex. 'The Enclosure' is a wonderful 4 bedroom, 4 bathroom semi-detached 'character' home, built to an exceptionally high standard in 2020. This luxurious family home offers superb, well-designed accommodation throughout and boasts a wealth of high specification features combined with a stylish, modern interior. The ground floor offers a magnificent open plan kitchen/living area with two sets of bi-fold doors leading to a the secluded garden and patio. On the ground floor there are two bedrooms, both with en-suites and a utility area with WC. An impressive glass panelled staircase leads to the upper floor where there is a balcony with panoramic views over open paddocks & countryside, an office/study area, master bedroom with en suite and dressing area. There is one further bedroom and a separate family bathroom. The gated driveway provides parking for several cars and is complemented by a large double garage size section of a nearby storage barn with double doors to front. The super garden back directly on to paddocks, where further land and the large semi-detached open barn is available by separate negotiation.

SUMMARY





Floor Plan

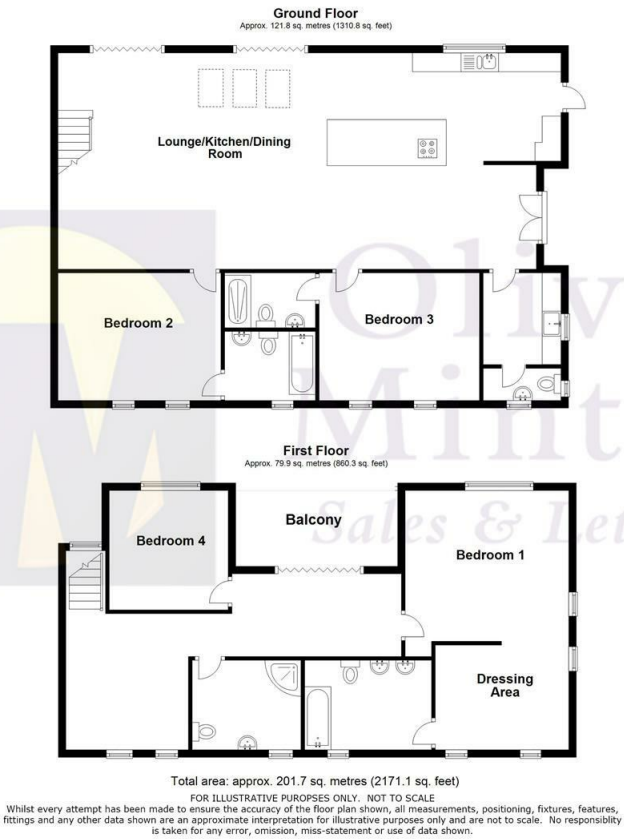

NOTICE: Whilst every effort has been made to ensure the accuracy of these sales details, they are for guidance purposes only and prospective purchasers or lessees are advised to seek their own professional advice as well as to satisfy themselves by inspection or otherwise as to their correctness.

No representation or warranty whatever is made in relation to this property by Oliver Minton or its employees, nor do such sales details form part of any offer or contract.

Area Map



Energy Efficiency Graph

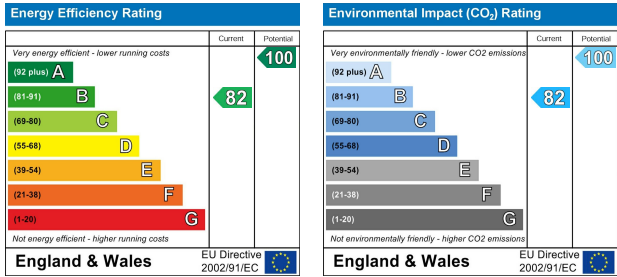

28 High Street, Puckeridge, Hertfordshire, SG11 1RN

01920 822999

Email: puckeridge@oliverminton.com

Tenure: Freehold

Council Tax Band: F

Viewing Arrangements:

Strictly by appointment

View all our properties at www.oliverminton.com