



£1,250 PCM Armidale Place | Bath Buildings | Montpelier | BS6 5BQ

www.kendallharper.com | lettings@kendallharper.com

Kendall Harper

Armidale Place | Bath Buildings | Montpelier | BS6 5BQ

We are delighted to offer this stylish one bedroom apartment which offers a fine example of contemporary city living.

The property is well presented throughout and the accommodation comprises an entrance hall and utility cupboard, a spacious open plan lounge/diner with a Juliet balcony offering far reaching views over Montpelier and the city beyond. There is also a double bedroom and a modern bathroom suite.

This modern development is located in the heart of Montpelier close to the local shops and amenities along Cheltenham Road and Picton Street and is ideal for someone wanting to live within close proximity to the City Centre. The property also benefits from a secure communal bike store. The water rates charge is £25 per month in addition to the monthly rent.

Suitable for a single occupant or a professional couple and viewings are highly recommended!



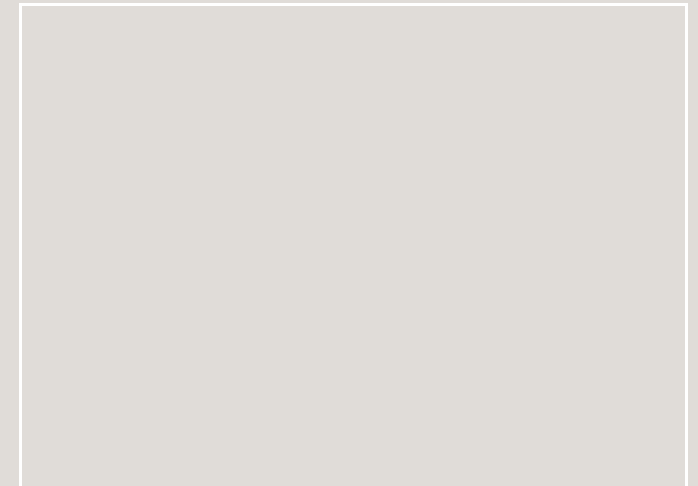
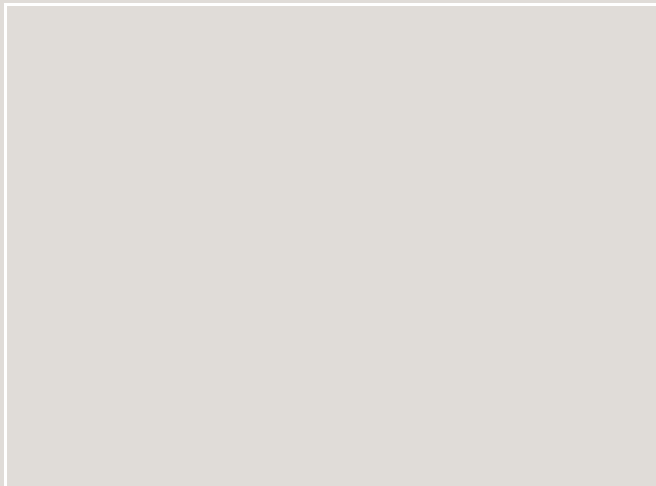

Energy Efficiency Rating		
	Current	Potential
Very energy efficient - lower running costs		
(92 plus) A		
(81-91) B	79	81
(69-80) C		
(55-68) D		
(39-54) E		
(21-38) F		
(1-20) G		
Not energy efficient - higher running costs		
England & Wales	EU Directive 2002/91/EC	

These particulars, whilst believed to be accurate, are set out as a general outline only for guidance and do not constitute any part of an offer or contract. Intending purchasers should not rely on them as statements of representation of fact, but must satisfy themselves by inspection or otherwise as to their accuracy. No person in this firm's employment has the authority to make or give any representation or warranty in respect of the property.

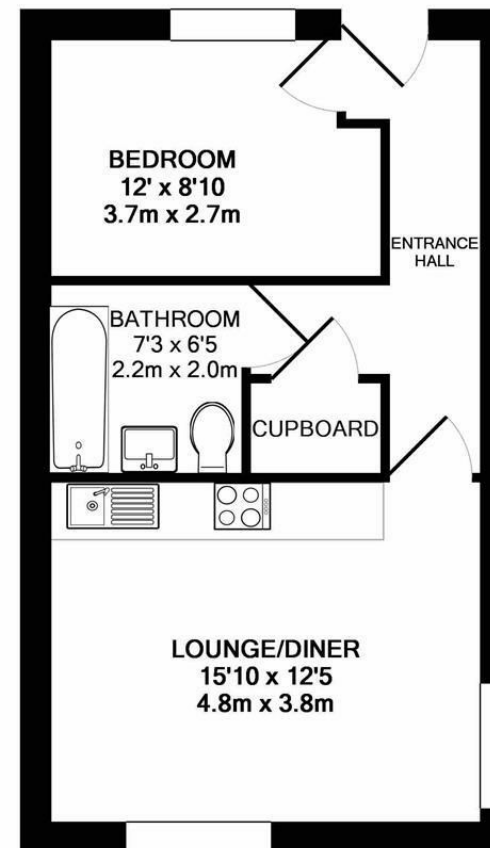

TOTAL APPROX. FLOOR AREA 444 SQ.FT. (41.2 SQ.M.)

Whilst every attempt has been made to ensure the accuracy of the floor plan contained here, measurements of doors, windows, rooms and any other items are approximate and no responsibility is taken for any error, omission, or mis-statement. This plan is for illustrative purposes only and should be used as such by any prospective purchaser. The services, systems and appliances shown have not been tested and no guarantee as to their operability or efficiency can be given
Made with Metropix ©2018