



£800 PCM Midland Mews | Waterloo Road | Bristol | BS2 0PL

www.kendallharper.com | lettings@kendallharper.com

Kendall Harper

A well presented one bed apartment that has just been redecorated throughout, situated on the top floor of this purpose built block close to Old Market, Temple Meads train station and Cabot Circus.

The accommodation comprises an entrance hall with two storage cupboards, an open plan lounge/kitchen/diner with appliances, a double bedroom and a modern bathroom.

Benefits include, double glazing and secure bike storage as well as residents permit parking in the area.

Suitable for a single occupant or a professional couple and viewings are highly recommended!



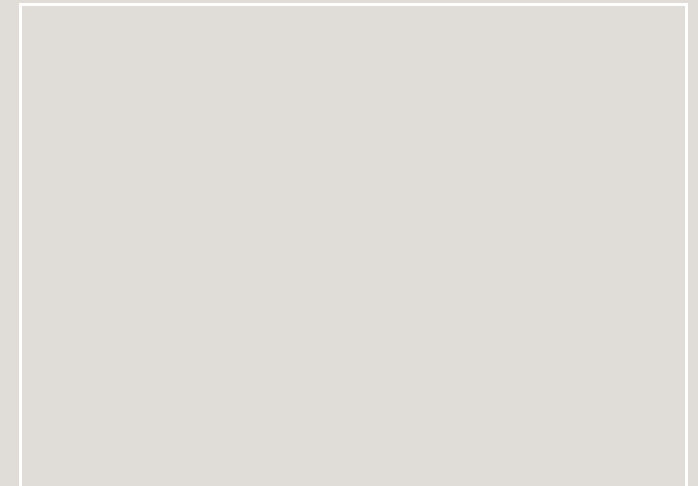
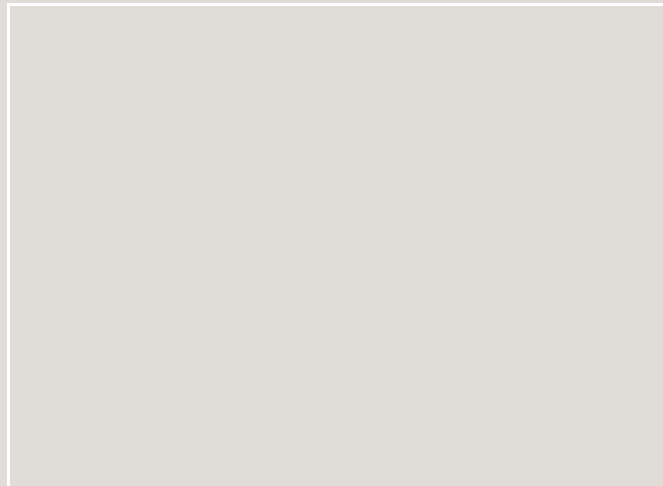
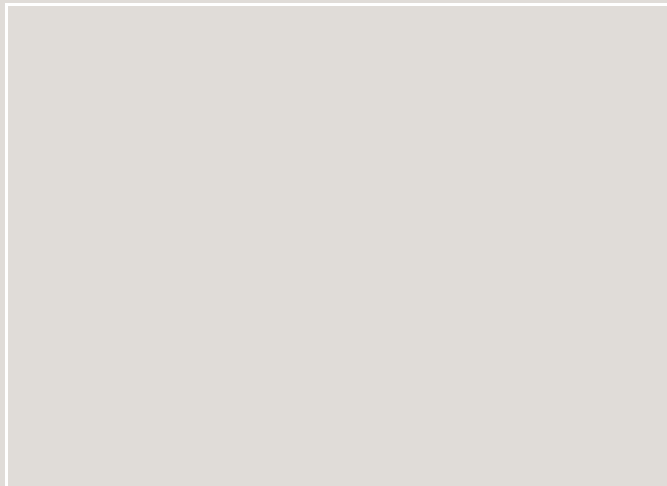

Energy Efficiency Rating		
	Current	Potential
Very energy efficient - lower running costs		
(92 plus) A		
(81-91) B		
(69-80) C	77	77
(55-68) D		
(39-54) E		
(21-38) F		
(1-20) G		
Not energy efficient - higher running costs		
England & Wales	EU Directive 2002/91/EC	

These particulars, whilst believed to be accurate, are set out as a general outline only for guidance and do not constitute any part of an offer or contract. Intending purchasers should not rely on them as statements of representation of fact, but must satisfy themselves by inspection or otherwise as to their accuracy. No person in this firm's employment has the authority to make or give any representation or warranty in respect of the property.

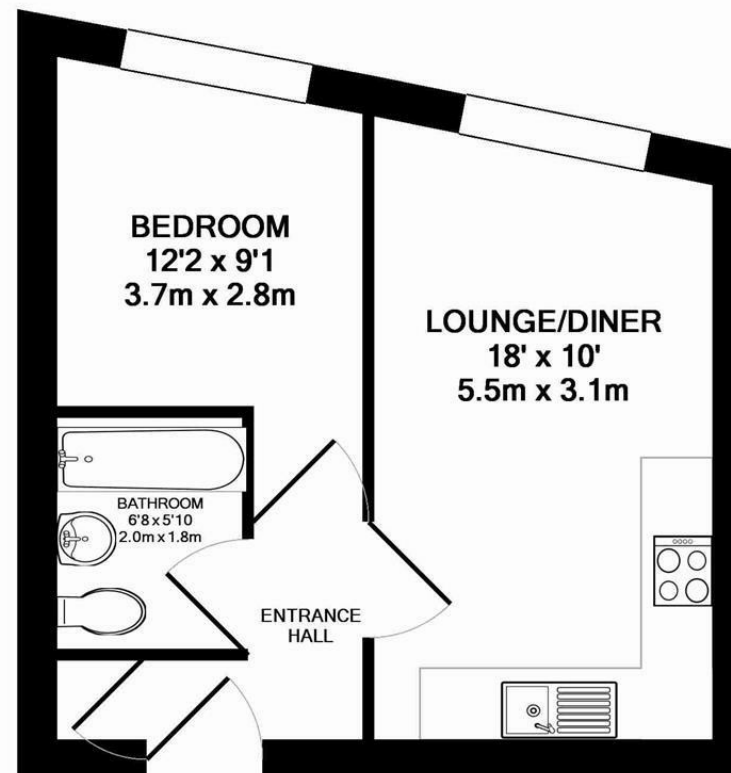

TOTAL APPROX. FLOOR AREA 347 SQ.FT. (32.3 SQ.M.)

Whilst every attempt has been made to ensure the accuracy of the floor plan contained here, measurements of doors, windows, rooms and any other items are approximate and no responsibility is taken for any error, omission, or mis-statement. This plan is for illustrative purposes only and should be used as such by any prospective purchaser. The services, systems and appliances shown have not been tested and no guarantee as to their operability or efficiency can be given

Made with Metropix ©2014