



£3,250 PCM Shellard Road | Filton | Bristol | BS34 7LX

[www.kendallharper.com](http://www.kendallharper.com) | [lettings@kendallharper.com](mailto:lettings@kendallharper.com)

Kendall Harper

A superb five bed student house, recently refurbished throughout. On the ground floor the accommodation briefly comprises an entrance hall, two downstairs double bedrooms, a shower room and an open plan lounge/kitchen. On the first floor there are three further double bedroom and a modern bathroom. To the outside there is driveway parking for up to three cars and a private rear garden. Included in the refurbishment was new electrics throughout, a new gas central heating system and gas boiler, two new bathrooms, a new kitchen with new appliances, new decoration throughout and new carpets and flooring throughout. A refurbishment was completed in July 2021. Available on 22nd July 2024 and viewings are highly recommended!

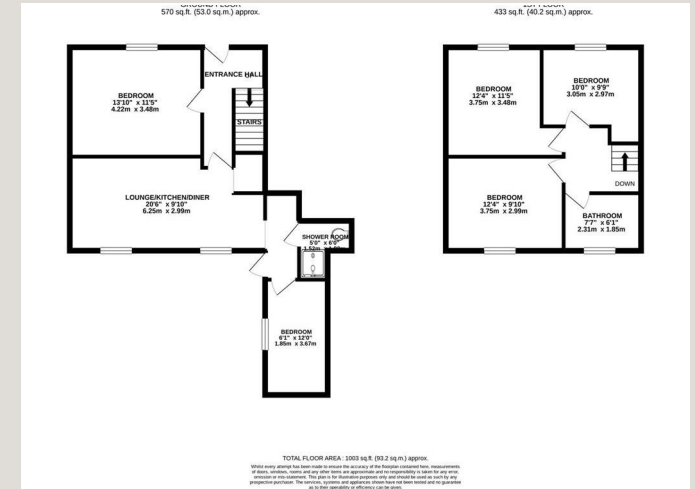

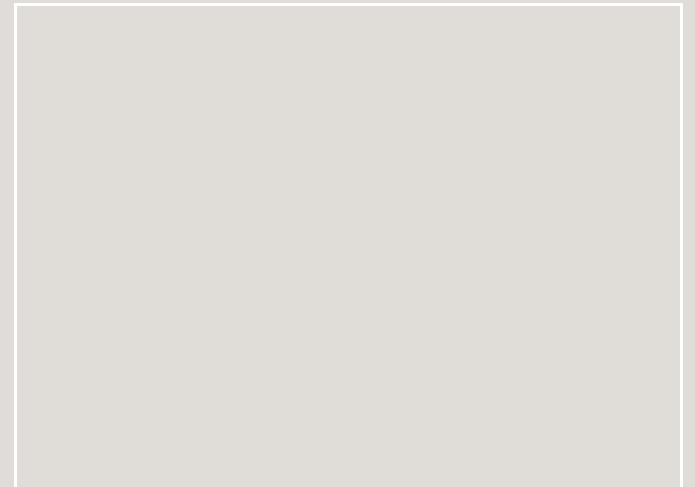
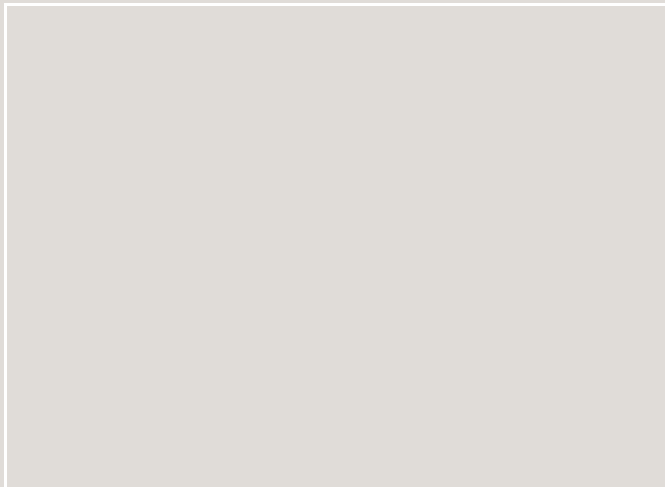
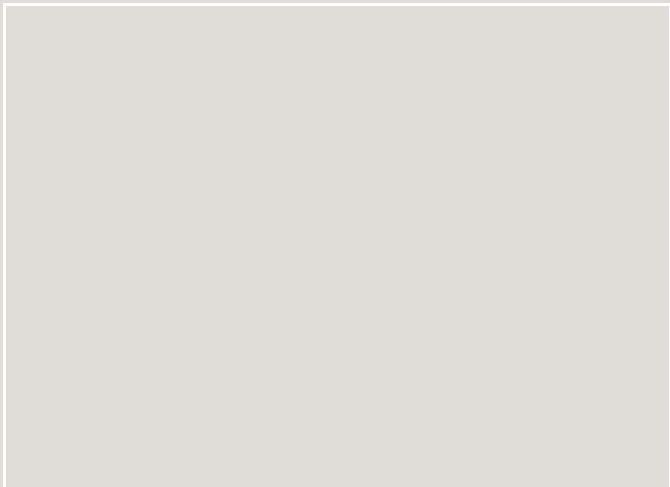
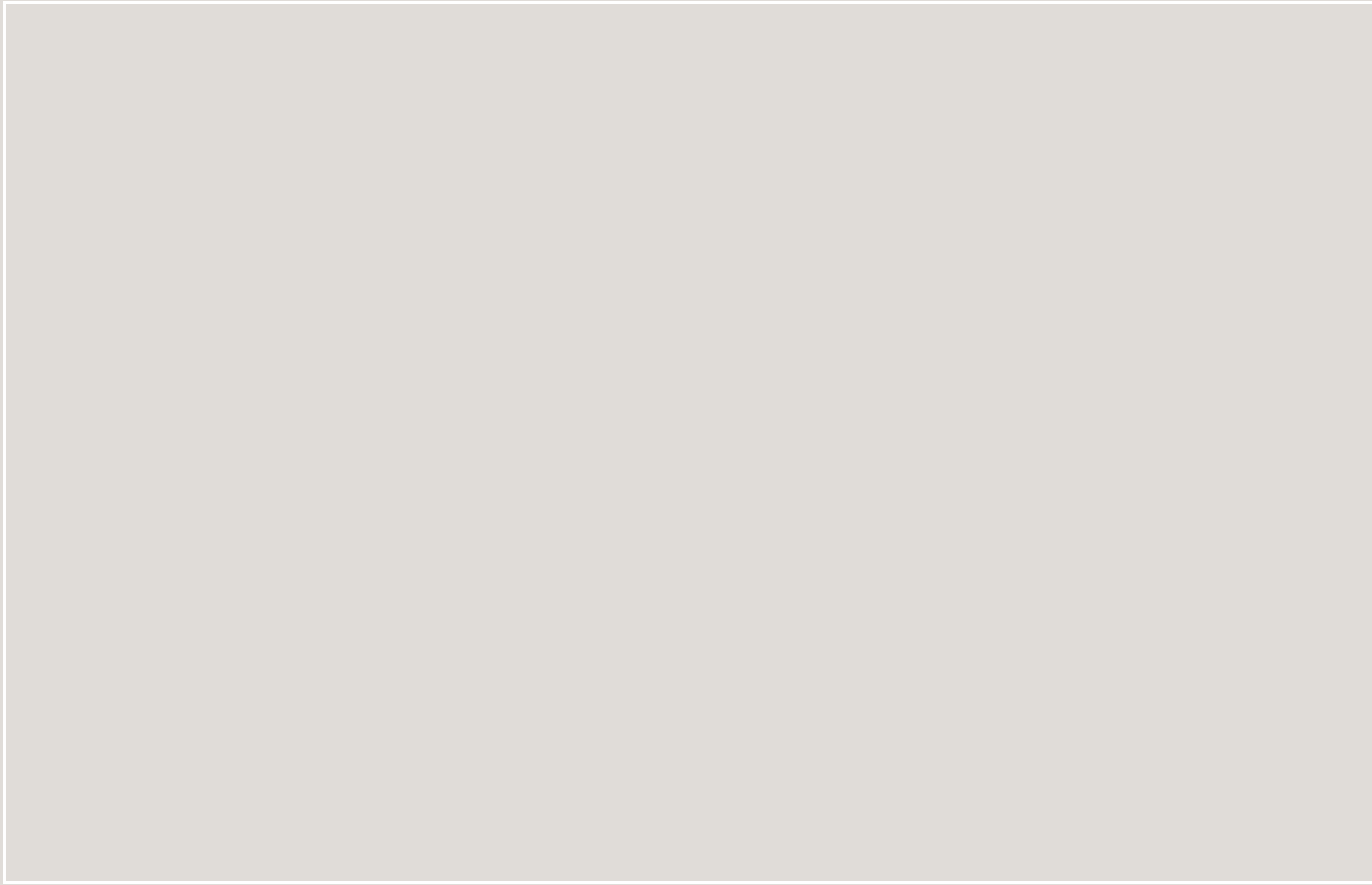



Energy Efficiency Rating		
	Current	Potential
<i>Very energy efficient - lower running costs</i>		
(92 plus) <b>A</b>		<b>82</b>
(81-91) <b>B</b>		
(69-80) <b>C</b>		
(55-68) <b>D</b>	<b>56</b>	
(39-54) <b>E</b>		
(21-38) <b>F</b>		
(1-20) <b>G</b>		
<i>Not energy efficient - higher running costs</i>		
<b>England &amp; Wales</b>	EU Directive 2002/91/EC	

These particulars, whilst believed to be accurate, are set out as a general outline only for guidance and do not constitute any part of an offer or contract. Intending purchasers should not rely on them as statements of representation of fact, but must satisfy themselves by inspection or otherwise as to their accuracy. No person in this firm's employment has the authority to make or give any representation or warranty in respect of the property.

