

First Floor

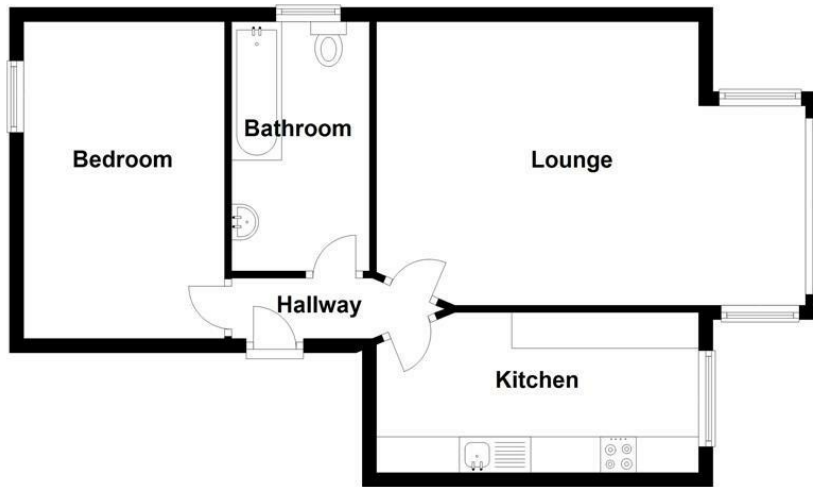

This floorplan is for illustration purposes only. The room sizes, locations of doors, windows and other features are approximate.
Plan produced using PlanUp.

Energy Efficiency Rating		Current	Potential
<i>Very energy efficient - lower running costs</i>			
(92 plus) A			77
(81-91) B			
(69-80) C			
(55-68) D			
(39-54) E		64	
(21-38) F			
(1-20) G			
<i>Not energy efficient - higher running costs</i>			
England & Wales		EU Directive 2002/91/EC	

Environmental Impact (CO ₂) Rating		Current	Potential
<i>Very environmentally friendly - lower CO₂ emissions</i>			
(92 plus) A			81
(81-91) B			
(69-80) C			
(55-68) D			
(39-54) E		63	
(21-38) F			
(1-20) G			
<i>Not environmentally friendly - higher CO₂ emissions</i>			
England & Wales		EU Directive 2002/91/EC	

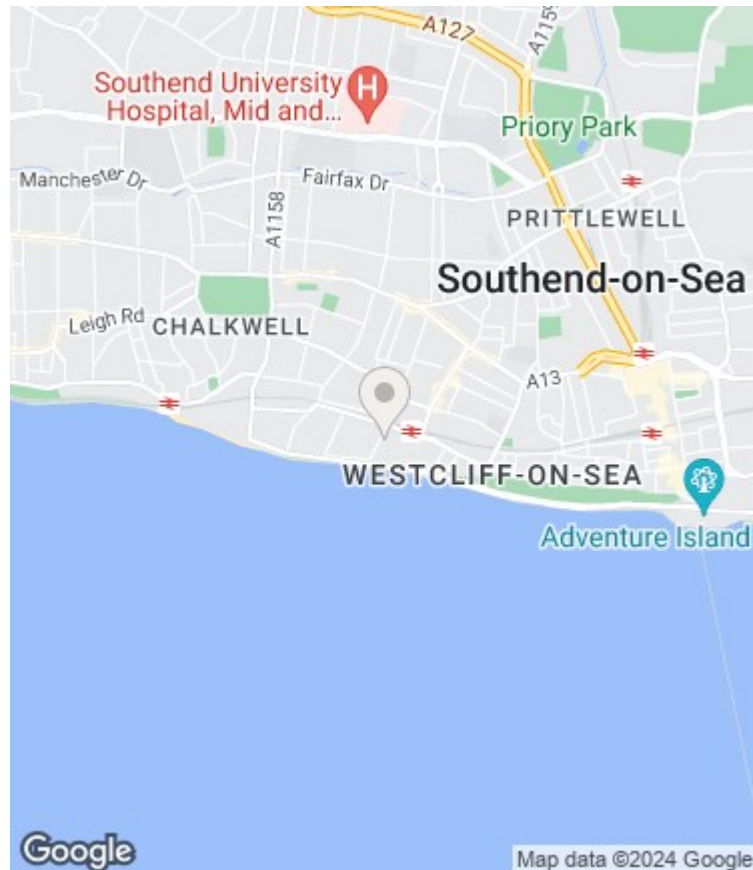

Viewing

Please contact our Sales & Letting Office on 017027 10555 if you wish to arrange a viewing appointment for this property or require further information.

These particulars, whilst believed to be accurate are set out as a general outline only for guideline and do not constitute any part of an offer or contract. Intending purchasers should rely on them as statements of representation of fact, but must satisfy themselves by inspection or otherwise as to their accuracy. No person in this firm's employment has the authority to make or give any representations

Turner Estates 34 Broadway, Leigh-on-Sea, Essex, SS9 1AJ
01702710555
info@turnerestates.co.uk





PALMERSTON ROAD, Westcliff-On-Sea SS0 7TB

£180,000



First Floor Flat

**Short Walk To
Seafront And
Mainline Station**

**Spacious One
Double bedroom
Double Glazing**

**Seaviews From
The Lounge
Gas Central
Heating**

**Modern Kitchen
And Bathroom
No Onward Chain**





Accommodation
Comprises

Hall

Lounge/Diner
17'9" into bay x 11'4"

Kitchen
13'5" x 7'3"

Bedroom
12'7" x 8'0"

Bathroom
9'2" x 4'0"

Agents Notes

