



HENRY ADAMS

London | Surrey | Sussex | Hampshire

Flat 8 Allfrey Plat, Lower Street, Pulborough, RH20 2BU



Henry Adams Lettings is pleased to offer a newly converted first floor studio apartment located close to the village shops and amenities. Accommodation comprises an entrance hall, shower room, living room/bedroom, kitchen with oven and fridge, off road parking for one car, communal gardens and laundry. EPC - C.

For more information or to view this property please contact  
Henry Adams Lettings Limited

HENRY ADAMS

London | Surrey | Sussex | Hampshire

£450.00pcm

T: 01903 745511  
E: [storringtonlettings@henryadams.co.uk](mailto:storringtonlettings@henryadams.co.uk)

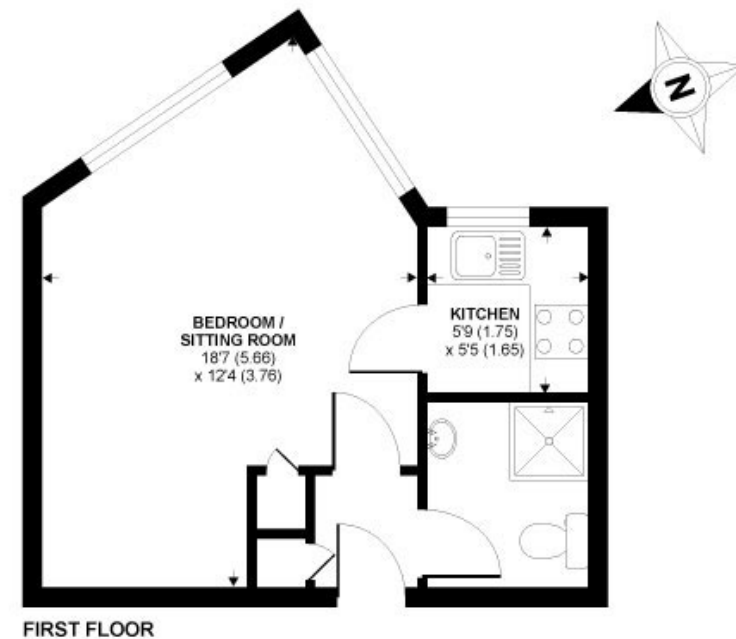

## 8, Allfrey Plat, Pulborough, West Sussex

APPROX. GROSS INTERNAL FLOOR AREA 274 SQ FT 25.4 SQ METRES

Whilst every attempt has been made to ensure the accuracy of the floor plan contained here, measurements of doors, windows and rooms are approximate and no responsibility is taken for any error, omission or misstatement. These plans are for representation purposes only as defined by RICS Code of Measuring Practice and should be used as such by any prospective purchaser. Specifically no guarantee is given on the total square footage of the property if quoted on this plan. Any figure given is for initial guidance only and should not be relied on as a basis of valuation.

Copyright [nichecom.co.uk](http://nichecom.co.uk) 2013 Produced for Henry Adams REF : 387364

**Agents Notes** - We endeavour to make our particulars accurate and reliable. They are for guidance only and are intended to give a fair overall summary of the property. They do not form part of any contract or offer, and should not be relied upon as a statement or representation of fact. Measurements, areas and distances are approximate only. Photographs may include lifestyle shots and pictures of local views. Also there may be internal/external photographs including chattels not included with the property for sale. No undertaking is given as to the structural condition of the property, or any necessary consents or the operating ability or efficiency of any service, system or appliance. Intending purchasers must satisfy themselves with regard to each of these points. If there is any particular aspect of the property about which you would like further information, please contact us, especially before you travel to the property.

Live Proof