



Waterman Way, E1W

£870,000

 2  1  1  C

- Freehold House
- On The Ornamental Canal
- Garden
- Garage
- Gated Parking Space
- Chain Free



Ea2 are pleased to present this freehold two bedroom house originally constructed as a three bedroom property on the Ornamental Canal in West Wapping. Kitchen, reception, garden, garage and gated parking space. A perfect family home. Being offered Chain Free.

Approximately 0.6 Miles from the picturesque St. Katharine's Docks offering a wide range of Restaurants, Wine Bars, Coffee Shops & Pubs. 0.4 Miles from Wapping Overground Station offering great access to the City, Shoreditch & Canary Wharf. Conveniently located for Wapping Lane that has a selection of convenience stores.



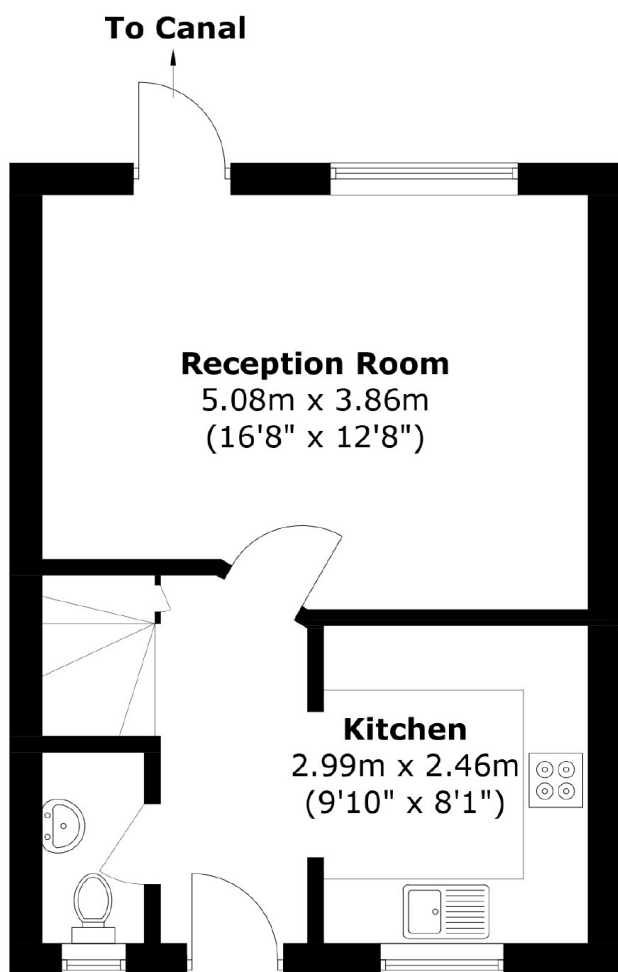

Ground Floor

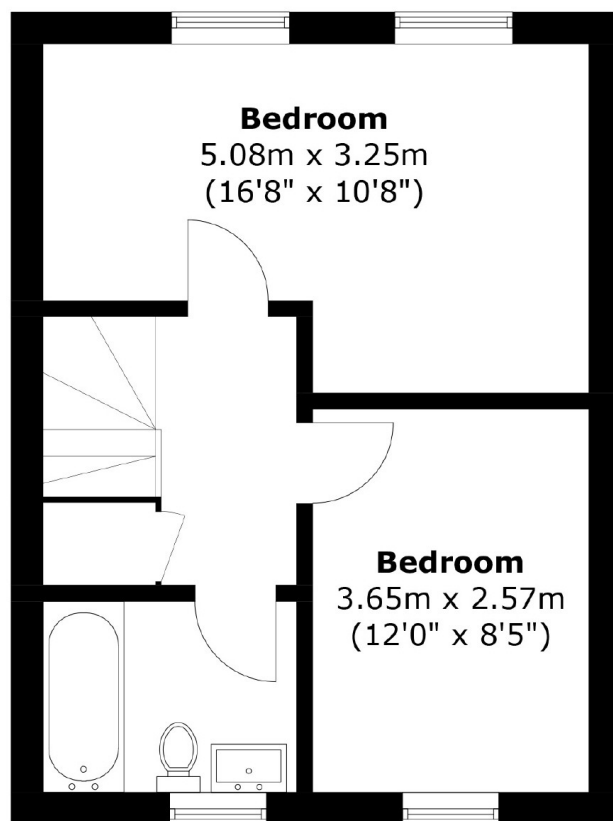

First Floor

Total area: Approx. 71.1 sq. meters (765.3 sq. feet)

35A Wapping High Street,
London, E1W 1NR
020 7665 5589
ea2group.com