



Folgate Street, E1

£650,000

 2  1  2  C

- Two Bedrooms
- Two Bathrooms
- 24 Hour Concierge
- Allocated Parking Space
- Residents Gym
- Chain Free



****Offers in Excess of £650,000**** EA2 are pleased to offer for sale this modern built 2 Bedroom 2 Bathroom Apartment set in this highly sought-after building in the heart of Spitalfields. The apartment benefits from a fully fitted and separated Kitchen, a generously sized Reception, 2 Double Bedrooms and 2 Bathrooms. The building further benefits from a 24-hour concierge service, a Residents gym and an underground secure parking. Offered Chain Free.

Bishops Court on Folgate Street is centrally located in Spitalfields and in close proximity to the City and Shoreditch. Located just off Bishopsgate, it is just 5 minutes walk to Liverpool Street Station (Circle, Metropolitan, Hammersmith & City and Central lines and National Rail). Spitalfields Market and the surrounding area is renowned for its array of superb restaurants, boutique shops, restaurants and vibrant nightlife. With the Crossrail at Liverpool Street the property will also have fast and convenient access to London's major airports making it an exceptional investment for the future.



Folgate Street

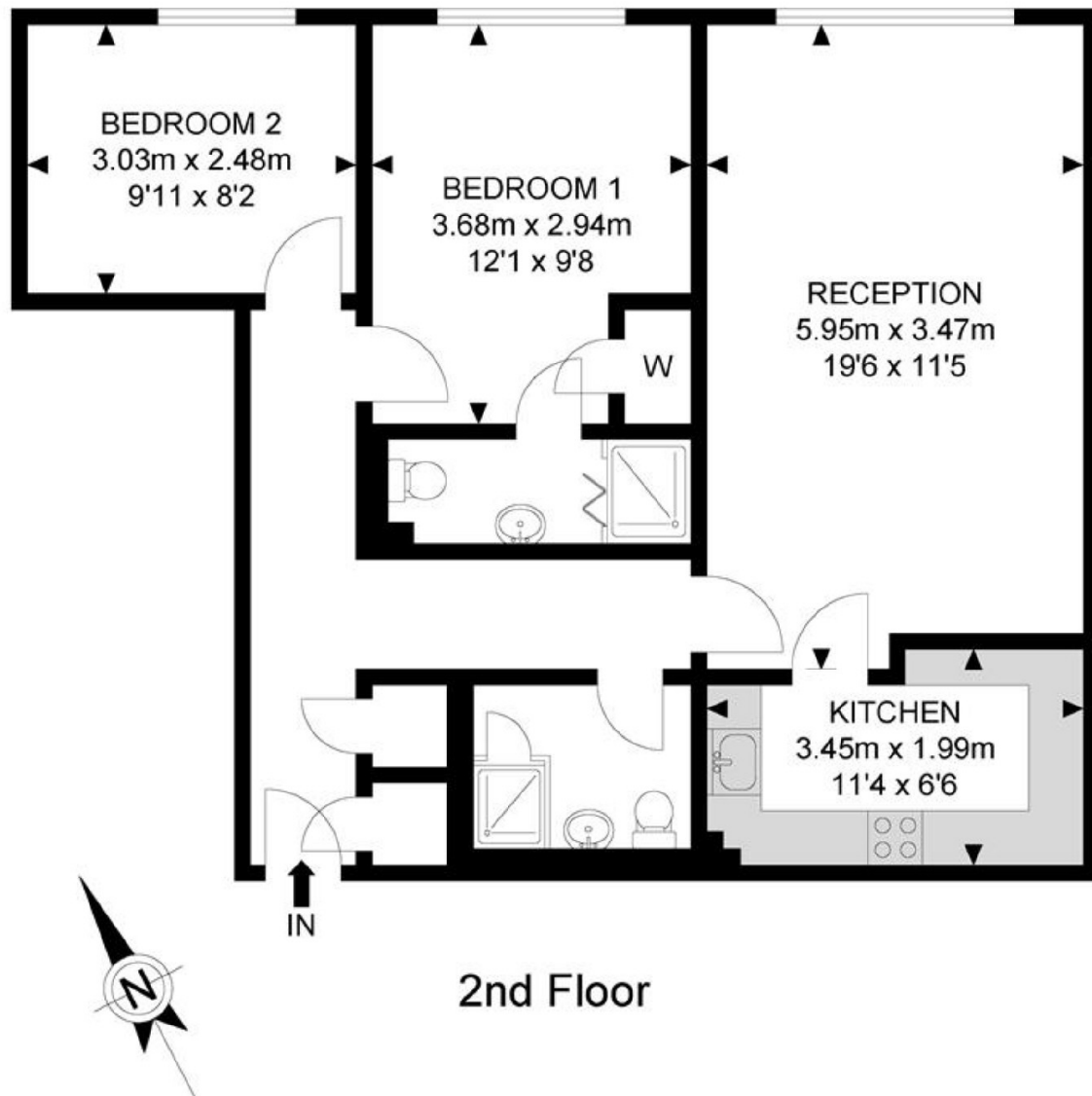

2nd Floor

APPROX. GROSS INTERNAL FLOOR AREA 696.42 SQ FT / 64.70 SQM

Whilst every attempt has been made to ensure the accuracy of the floor plan contained here, measurements of doors, windows, rooms and any other items are approximates and no responsibility is taken for any error, omission or mis-statement. This plan is for illustrative purposes only and should be used as such by any prospective purchaser. The service, system and appliances shown have not been tested and no guarantee as to their operability or efficiency can be given.

© SpacePhoto

Photography and Floor Plan

35A Wapping High Street,
London, E1W 1NR
020 7665 5589
ea2group.com