



ea²

020 7702 3456
enquiries@ea2group.com
www.ea2group.co.uk

35a Wapping High Street, Wapping, London E1W 1NR



Tradewinds Court
Wapping, E1W

- Modern Built 1st Floor Apartment
- 1 Double Bedroom
- Lounge with South Facing Balcony
- Fitted Kitchen
- 3 Piece Bathroom Suite

£425,000

Tradewinds Court, E1W 2JB

Total Internal Area: 465 sq. ft / 43.2 sq. meters

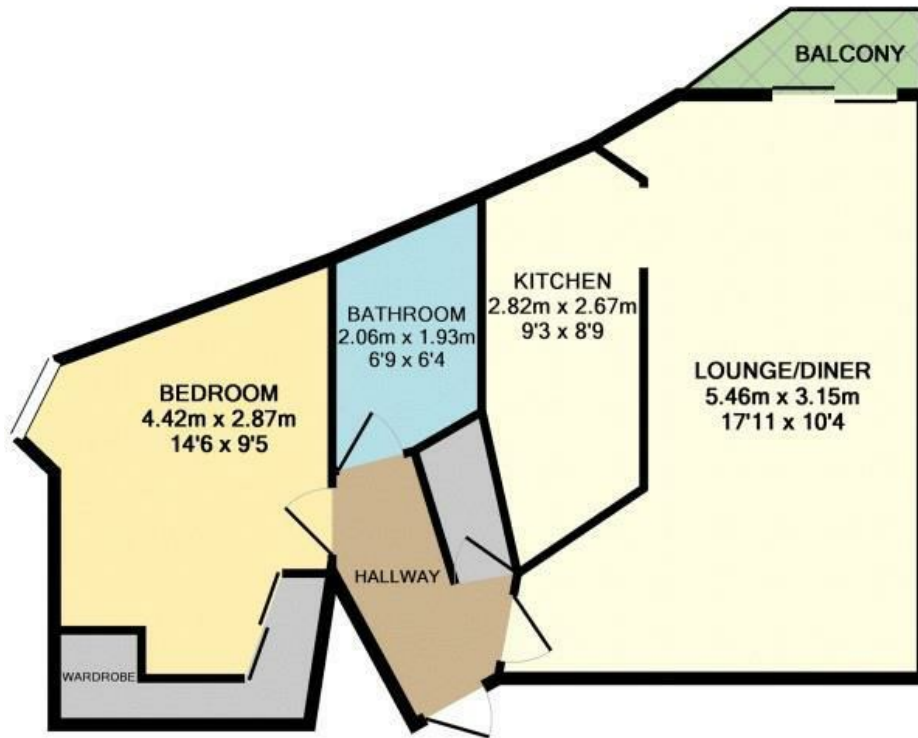

First floor

Whilst every attempt has been made to ensure the accuracy of the floor plan contained here, measurements of doors, windows, rooms and any other items are approximate and no responsibility is taken for any error, omission, or mis-statement. This plan is for illustrative purposes only and should be used as such by any prospective purchaser. The services, systems and appliances shown have not been tested and no guarantee as to their operability or efficiency can be given.
Made with Metropix ©2018

Energy Efficiency Rating		
	Current	Potential
Very energy efficient - lower running costs		
(92 plus) A		
(81-91) B		
(69-80) C	72	80
(55-68) D		
(39-54) E		
(21-38) F		
(1-20) G		
Not energy efficient - higher running costs		
England & Wales	EU Directive 2002/91/EC	



ea2 Ltd have prepared these sales particulars as a general guide only. ea2 Ltd have not carried out a detailed survey, nor tested any services, appliances or fittings. Information regarding the length of lease, ground rent and service charge is provided by the seller and believed to be correct. Any purchaser is strongly advised to obtain verification from their legal advisor or surveyor.