



ea²

020 7702 3456
enquiries@ea2group.com
www.ea2group.co.uk

35a Wapping High Street, Wapping, London E1W 1NR



Discovery Walk
Wapping, E1W

Ea2 Estate Agency are proud to offer for sale this bright and modern Studio Apartment on the 2nd floor of this popular and Secure Development with Parking in the heart of Wapping. The apartment comprises of a large Reception/living area with a pull out bed and a Juliet balcony overlooking Tobacco Dock and offering stunning Canal views, a separated fully fitted Kitchen and a modern Bathroom. Allocated Parking Space in a secure underground Parking. Ideally located in the heart of Wapping, only a short walk away from Tower Bridge, Tower of London and the City. Long lease. Offered Chain Free. Perfect for a first-time buyer or an investor.

Asking Price
£300,000

Discovery Walk, Wapping, E1W 2JG

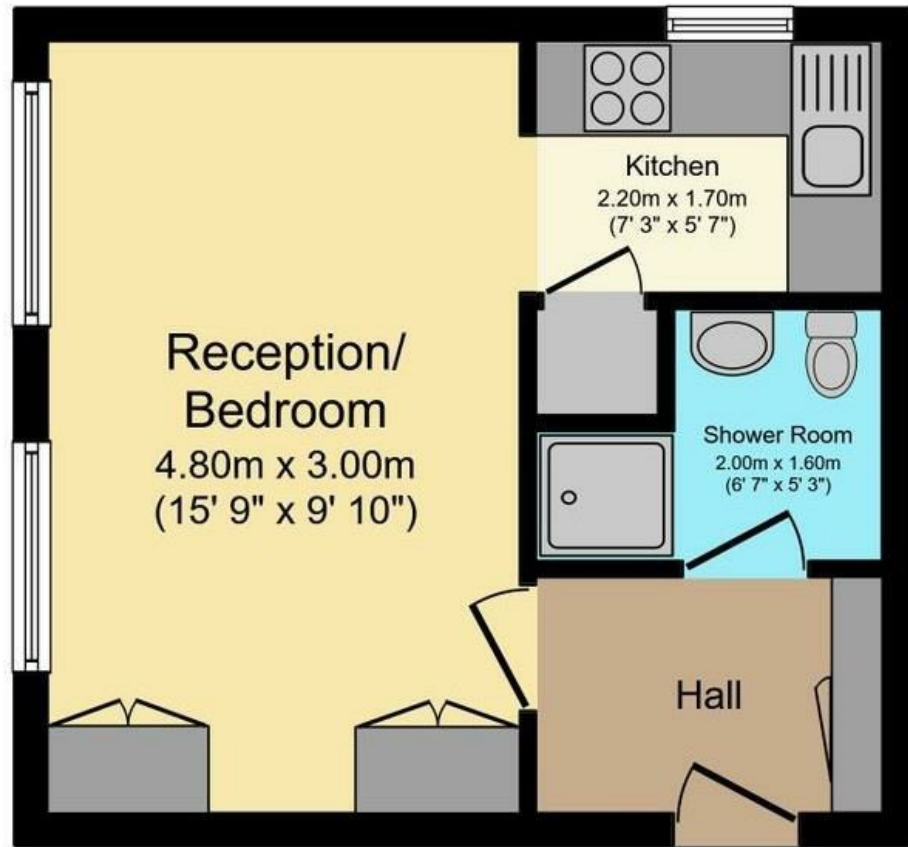

2nd Floor

Total floor area 26.0 sq. m. (280 sq. ft.) approx

ea2 Ltd have prepared these sales particulars as a general guide only. ea2 Ltd have not carried out a detailed survey, nor tested any services, appliances or fittings. Information regarding the length of lease, ground rent and service charge is provided by the seller and believed to be correct. Any purchaser is strongly advised to obtain verification from their legal advisor or surveyor.

Tenure: Share of Freehold - 963 years remaining
 Service Charges: Approx. £1,655pa
 Allocated Parking Space

Energy Efficiency Rating		
	Current	Potential
Very energy efficient - lower running costs		
(92 plus) A		
(81-91) B		82
(69-80) C	72	
(55-68) D		
(39-54) E		
(21-38) F		
(1-20) G		
Not energy efficient - higher running costs		
England & Wales	EU Directive 2002/91/EC	

