



## 40 Langdale Road, Bramhall, Stockport, SK7 1DN

Hibbert Homes are delighted to offer this beautifully presented 4 bedroom detached property. Nestled in the charming area of Bramhall, this delightful house on Langdale Road offers the perfect blend of comfort and convenience. With four well-proportioned bedrooms, this property is ideal for families or those seeking extra space. The two reception rooms provide ample room for relaxation and entertaining, making it a wonderful home for gatherings with friends and family.

Langdale Road is situated in a peaceful neighborhood, yet it remains close to local amenities, schools, and transport links, making it an excellent choice for those who appreciate both tranquility and accessibility. This property presents a fantastic opportunity to create a warm and welcoming home in a sought-after area. Do not miss the chance to make this lovely house your own.

Photos and video are for guidance purposes only. Property will be offered UNFURNISHED.

Council Tax Band - E  
EPC Rating - E  
Available From - 15th September 2025

**£2,250 PCM**



Approx Gross Internal Area  
149 sq m / 1603 sq ft

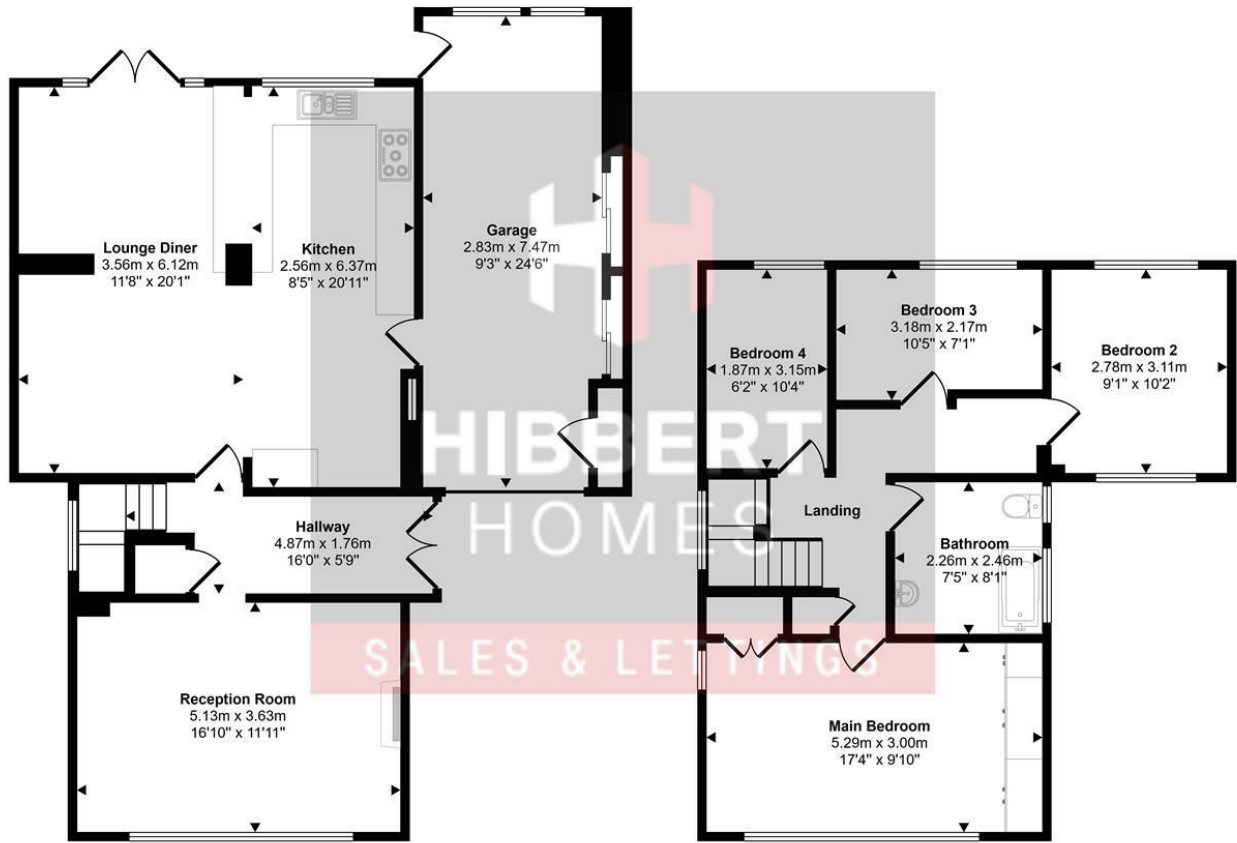

This floorplan is only for illustrative purposes and is not to scale. Measurements of rooms, doors, windows, and any items are approximate and no responsibility is taken for any error, omission or mis-statement. Icons of items such as bathroom suites are representations only and may not look like the real items. Made with Made Snappy 360.



Energy Efficiency Rating		
	Current	Potential
Very energy efficient - lower running costs		
(92 plus) A		
(81-91) B		
(69-80) C		
(55-68) D		
(39-54) E		
(21-38) F		
(1-20) G		
Not energy efficient - higher running costs		
	53	78
England & Wales	EU Directive 2002/91/EC	

Environmental Impact (CO <sub>2</sub> ) Rating		
	Current	Potential
Very environmentally friendly - lower CO <sub>2</sub> emissions		
(92 plus) A		
(81-91) B		
(69-80) C		
(55-68) D		
(39-54) E		
(21-38) F		
(1-20) G		
Not environmentally friendly - higher CO <sub>2</sub> emissions		
England & Wales	EU Directive 2002/91/EC	