



Apartment 21A, 232, Quay 5 Ordsall Lane, Salford, M5 3NB

Hibbert Homes are delighted to offer This Beautifully presented, Two Double Bedroom Apartment, boasting lots of light, Secure gated parking. Located minutes from Salford Quays and Manchester City Centre, transport links,

Offered Part furnished, this spacious property comprises of an entrance hallway leading to the open plan kitchen, living area. A spacious bedroom and main bathroom with shower over the bath, leading on to the Second Double Bedroom.

Further benefits include: Secure gated parking space. Secure intercom entry system, and electric heating.

EPC Rating C
Council Tax Band B
Available from 27th June 2024

£1,150 PCM

Approx Gross Internal Area
55 sq m / 591 sq ft

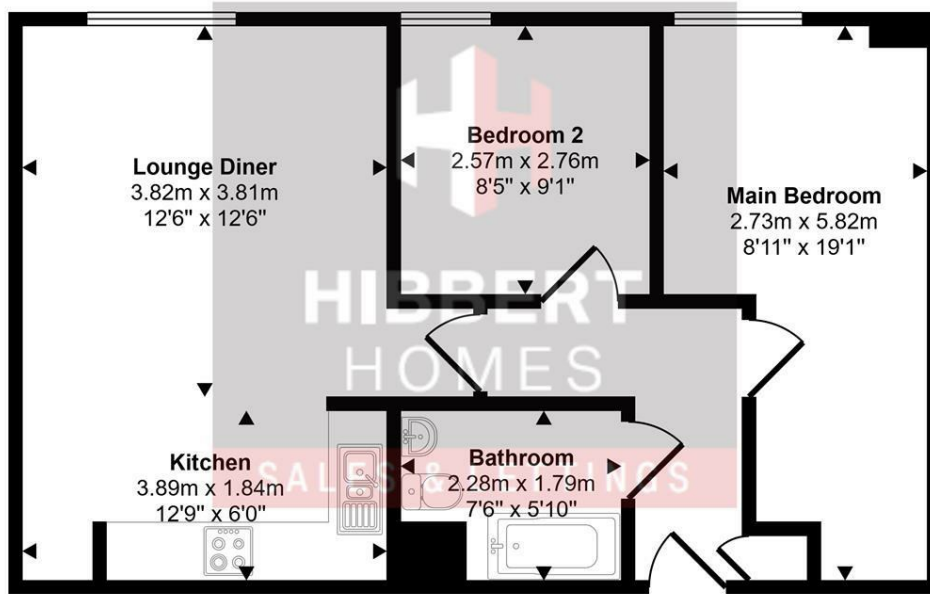

Floorplan

This floorplan is only for illustrative purposes and is not to scale. Measurements of rooms, doors, windows, and any items are approximate and no responsibility is taken for any error, omission or mis-statement. Icons of items such as bathroom suites are representations only and may not look like the real items. Made with Made Snappy 360.



Energy Efficiency Rating		
	Current	Potential
Very energy efficient - lower running costs		
(92 plus) A		
(81-91) B		
(69-80) C		
(55-68) D		
(39-54) E		
(21-38) F		
(1-20) G		
Not energy efficient - higher running costs		
England & Wales	EU Directive 2002/91/EC	

Environmental Impact (CO ₂) Rating		
	Current	Potential
Very environmentally friendly - lower CO ₂ emissions		
(92 plus) A		
(81-91) B		
(69-80) C		
(55-68) D		
(39-54) E		
(21-38) F		
(1-20) G		
Not environmentally friendly - higher CO ₂ emissions		
England & Wales	EU Directive 2002/91/EC	