



159 Woodsmoor Lane, Stockport, SK3 8TH

Hibbert Homes are delighted to present semi-detached house on Woodsmoor Lane, Stockport! This property boasts two large reception rooms, three double bedrooms, and a well-appointed bathroom, offering ample space for comfortable living. With 1,476 sq ft of living area, this home has been refurbished throughout presents a beautiful home decorated with elegance.

Situated in an excellent location of Woodsmoor, there are plenty of schools within walking distance and local amenities just on your doorstep, making this property perfect for those seeking convenience and accessibility. The spacious rooms provide a sense of openness, allowing you to create the perfect living environment for you and your family.

This property further features a brilliantly spacious garden, boasting privacy for entertaining guests or simply enjoying some relaxation.

To view please call Hibbert Homes 0161 480 0099.
Available from 7th May 2025.
EPC Rating C
Council Tax Band D

- SPACIOUS ROOMS
- THREE DOUBLE BEDROOMS
- LARGE GARDEN
- BRILLIANT LOCATION

£1,900 PCM

Approx Gross Internal Area
137 sq m / 1476 sq ft

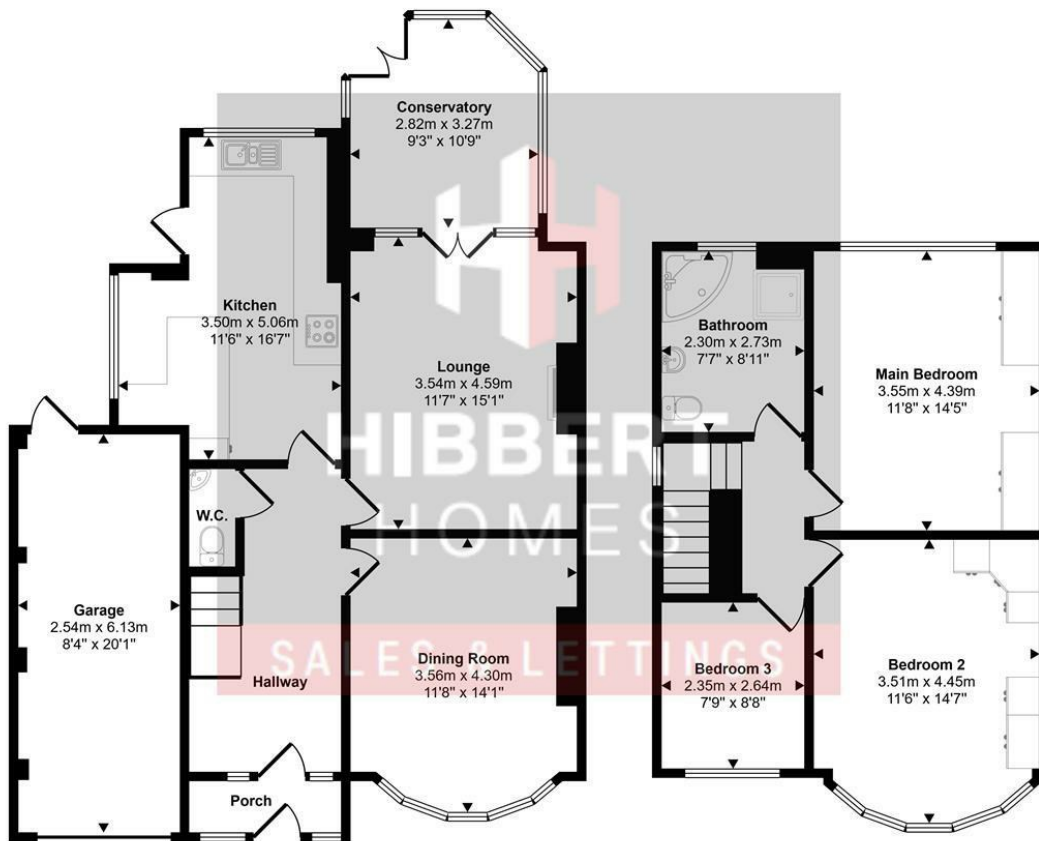

This floorplan is only for illustrative purposes and is not to scale. Measurements of rooms, doors, windows, and any items are approximate and no responsibility is taken for any error, omission or mis-statement. Icons of items such as bathroom suites are representations only and may not look like the real items. Made with Made Snappy 360.



| Energy Efficiency Rating | | |
|---|-------------------------|-----------|
| | Current | Potential |
| Very energy efficient - lower running costs | | |
| (92 plus) A | | |
| (81-91) B | | |
| (69-80) C | | |
| (55-68) D | | |
| (39-54) E | | |
| (21-38) F | | |
| (1-20) G | | |
| Not energy efficient - higher running costs | | |
| England & Wales | EU Directive 2002/91/EC | |

| Environmental Impact (CO ₂) Rating | | |
|---|-------------------------|-----------|
| | Current | Potential |
| Very environmentally friendly - lower CO ₂ emissions | | |
| (92 plus) A | | |
| (81-91) B | | |
| (69-80) C | | |
| (55-68) D | | |
| (39-54) E | | |
| (21-38) F | | |
| (1-20) G | | |
| Not environmentally friendly - higher CO ₂ emissions | | |
| England & Wales | EU Directive 2002/91/EC | |

