



Brookfield Avenue | Offerton
Price Guide £258,000

Bedrooms 3

Bath 1

Reception 1

Parking here

Area
714.00 sq ft

Type here

Approx Gross Internal Area
66 sq m / 714 sq ft

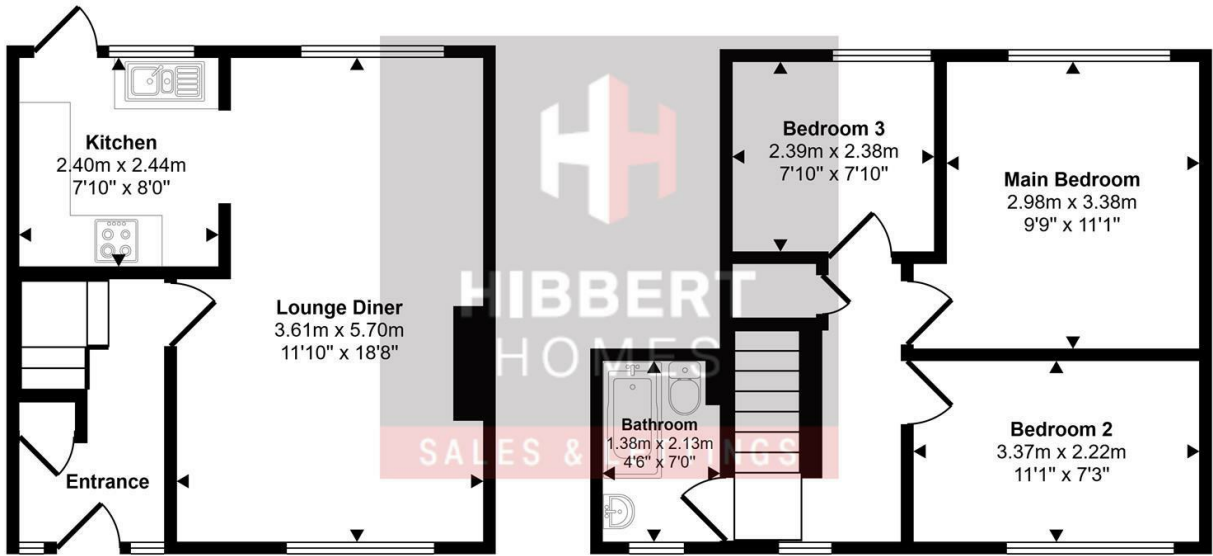

Ground Floor
Approx 31 sq m / 337 sq ft

First Floor
Approx 35 sq m / 377 sq ft

This floorplan is only for illustrative purposes and is not to scale. Measurements of rooms, doors, windows, and any items are approximate and no responsibility is taken for any error, omission or mis-statement. Icons of items such as bathroom suites are representations only and may not look like the real items. Made with Made Snappy 360.

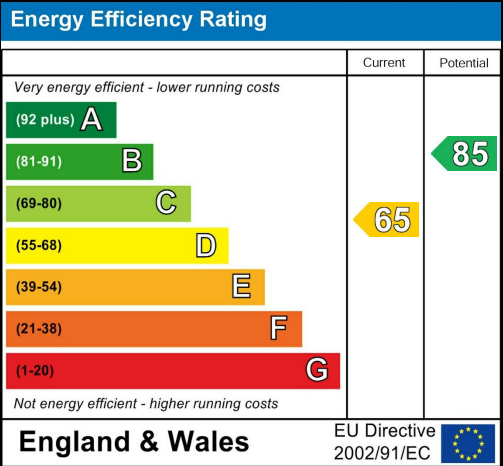

HIBBERT
HOMES

SALES & LETTINGS

21 Bramhall Lane South | Bramhall | SK7 1AQ
t:0161 480 0099
e: enquiries@hibberthomes.com
www.hibberthomes.com

- CHAIN FREE
- SOUTH FACING GARDEN
- OPEN-PLAN DOWNSTAIRS
- LOCAL TO STOCKPORT CENTRE

- MODERN THROUGHOUT
- THREE BEDROOMS
- OFF-ROAD PARKING

Hibbert Homes are pleased to bring to the market this modernly designed property, located on Brookfield Avenue. This home benefits from open-living space and is sold chain free! This home is set within a brilliant location, with an array of shops and amenities within walking distance, and Stockport Town Centre very nearby too.

The property briefly comprises from an inviting hallway upon entrance, heading into an open-plan living/dining space, with a contemporary kitchen sharing this space too. Heading upstairs, this property offers Three Bedrooms, two of which are large Double Bedrooms. A modernised main bathroom with a bath and shower head completes the upstairs of this property.

This garden benefits greatly from a spacious private garden, facing in a southerly direction and therefore attracting sunlight onto this spot all day long, making this garden ideal for entertaining guests or simply enjoying some relaxation in the sun.

To book your viewing for this brilliant home today, please contact Hibbert Homes Bramhall on 0161 480 0099 enquiries@hibberthomes.com.

