

Approx Gross Floor Area = 736 Sq. Feet

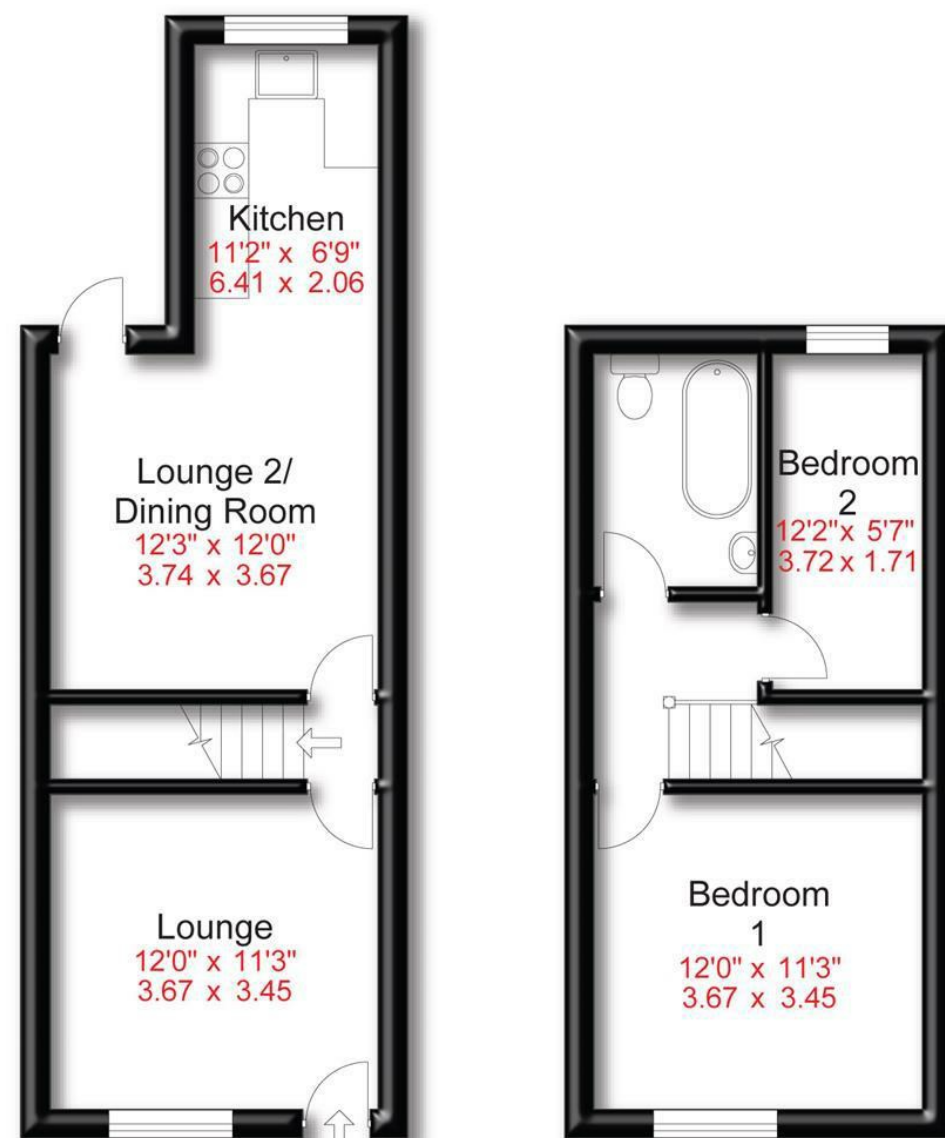

Ground Floor

First Floor

Energy Efficiency Rating		
	Current	Potential
Very energy efficient - lower running costs		
(92 plus) A		
(81-91) B		
(69-80) C		
(55-68) D		
(39-54) E		
(21-38) F		
(1-20) G		
Not energy efficient - higher running costs		
England & Wales	EU Directive 2002/91/EC	



Llanfair Road | Edgeley
Asking Price £220,000



SALES & LETTINGS

21 Bramhall Lane South | Bramhall | SK7 1AQ

t: 0161 480 0099

e: enquiries@hibberthomes.com

www.hibberthomes.com

Bedrooms 2

Bath 1

Reception 1

Parking here

Area
0.00 sq ft

Type here



- Large Victorian End-Terraced
- Extended Modern Kitchen
- Generous Master Bedroom
- Modern Bulkhead Bathroom
- Ample On-Street Parking
- Two Spacious Reception Rooms
- Basement Cellar
- Second Double Bedroom
- Enclosed Lawned Rear Garden
- Extremely Sought After Location

Hibbert Homes are pleased to bring this brilliant 2 bedroom semi-detached property to the market, boasting excellent room sizes, while being situated in an excellent location too.

The property briefly comprises from two large reception rooms downstairs, with an extended kitchen towards the rear too. Upstairs, the property includes two large double bedrooms and the main bathroom, with a large garden found at the rear of the property.

This property is available from March 2024 as it is currently tenanted, and is sold with no onward chain. Viewings are highly recommended, so please contact Hibbert Homes on 0161 480 0099 enquiries@hibberthomes.com

