

15a Wilmslow Road, Cheadle, SK8 1DW

Hilbert Homes are delighted to offer this office space in the Heart of Cheadle Hulme with all its local amenities on your doorstep this makes for the perfect home for your company activities.

The building provides flexible office accommodation, Entrance on Wilmslow road, leading to the stairway, kitchen bathroom/ Hallway leading on two rooms to host important meetings, workshops or office space.

Available NOW, Furnished/ Unfurnished negotiated upon Interest.

Lease length negotiable 3/5 years, 3 Months Deposit, EPC Rating D.

The Tenant will be responsible for the Landlord's legal costs associated with the new Lease.

£950 PCM

Approx Gross Internal Area
45 sq m / 486 sq ft

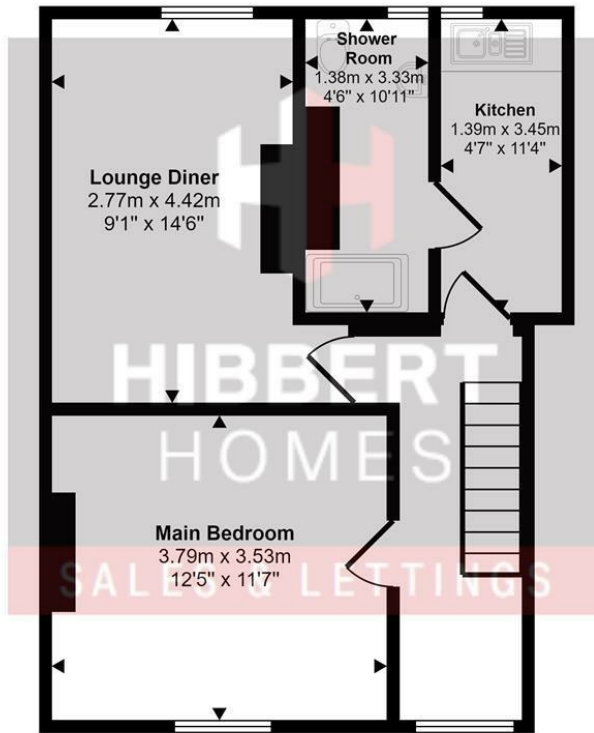

First Floor

This floorplan is only for illustrative purposes and is not to scale. Measurements of rooms, doors, windows, and any items are approximate and no responsibility is taken for any error, omission or mis-statement. Icons of items such as bathroom suites are representations only and may not look like the real items. Made with Made Snappy 360.



Energy Efficiency Rating		Current	Potential
Very energy efficient - lower running costs			
(92 plus) A			
(81-91) B			
(69-80) C			
(55-68) D			
(39-54) E			
(21-38) F			
(1-20) G			
Not energy efficient - higher running costs			
England & Wales		EU Directive 2002/91/EC	

Environmental Impact (CO ₂) Rating		Current	Potential
Very environmentally friendly - lower CO ₂ emissions			
(92 plus) A			
(81-91) B			
(69-80) C			
(55-68) D			
(39-54) E			
(21-38) F			
(1-20) G			
Not environmentally friendly - higher CO ₂ emissions			
England & Wales		EU Directive 2002/91/EC	

