



205 Turncroft Lane, Stockport, Cheshire, SK1 4BN

Situated in this ever-popular residential location and offering deceptively spacious accommodation is this generous mid terrace property. To the ground floor there is a lounge with frontal aspect; dining room with views over the rear garden and access to the cellar; kitchen with a modern range of eye and base level units and integral oven, hob and extractor; downstairs WC and utility room with plumbing for the washing machine and access to the rear garden. To the first floor there are two double bedrooms (one with dressing room/home office) and bulkhead bathroom with a modern three piece white suite comprising low level WC, hand wash basin and panelled bath with shower over. Internally the property is complemented by PVC double glazing and gas central heating. Externally there is a cottage style garden to the front with access to the front door whilst to the rear there is a generous, enclosed garden, flagged for ease.

A internal viewing is strongly recommended to fully appreciate the property.

EPC - D. Council Tax band A.

Available 05/09/2024.

£1,200 Per Calendar Month

Approx Gross Floor Area = 991 Sq. Feet
 = 91.87 Sq. Metres

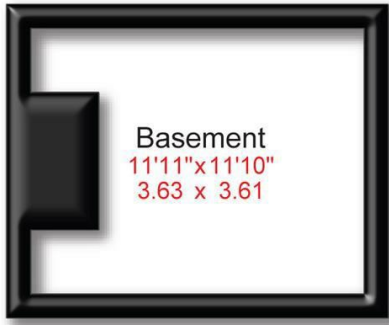

Lower Ground Floor

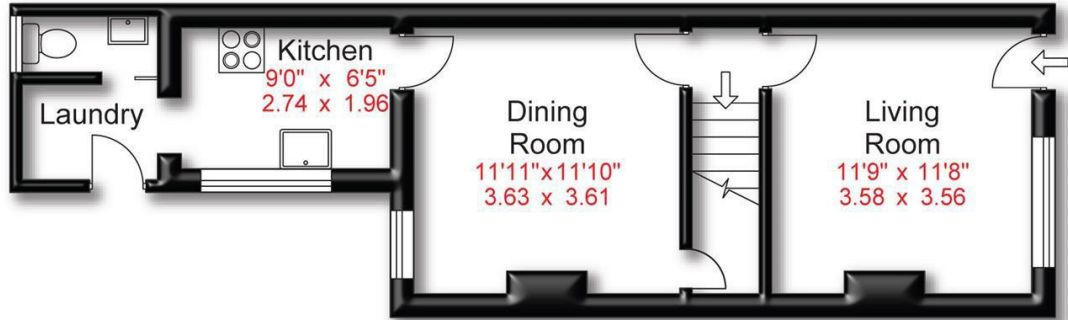

Ground Floor



First Floor



Energy Efficiency Rating	
	Potential
Very energy efficient - lower running costs	
(92 plus) A	
(81-91) B	85
(69-80) C	
(55-68) D	68
(39-54) E	
(21-38) F	
(1-20) G	
Not energy efficient - higher running costs	
England & Wales	EU Directive 2002/91/EC

Environmental Impact (CO ₂) Rating	
	Potential
Very environmentally friendly - lower CO ₂ emissions	
(92 plus) A	
(81-91) B	85
(69-80) C	
(55-68) D	60
(39-54) E	
(21-38) F	
(1-20) G	
Not environmentally friendly - higher CO ₂ emissions	
England & Wales	EU Directive 2002/91/EC

