

Approx Gross Floor Area = 774 Sq. Feet
= 71.9 Sq. Metres

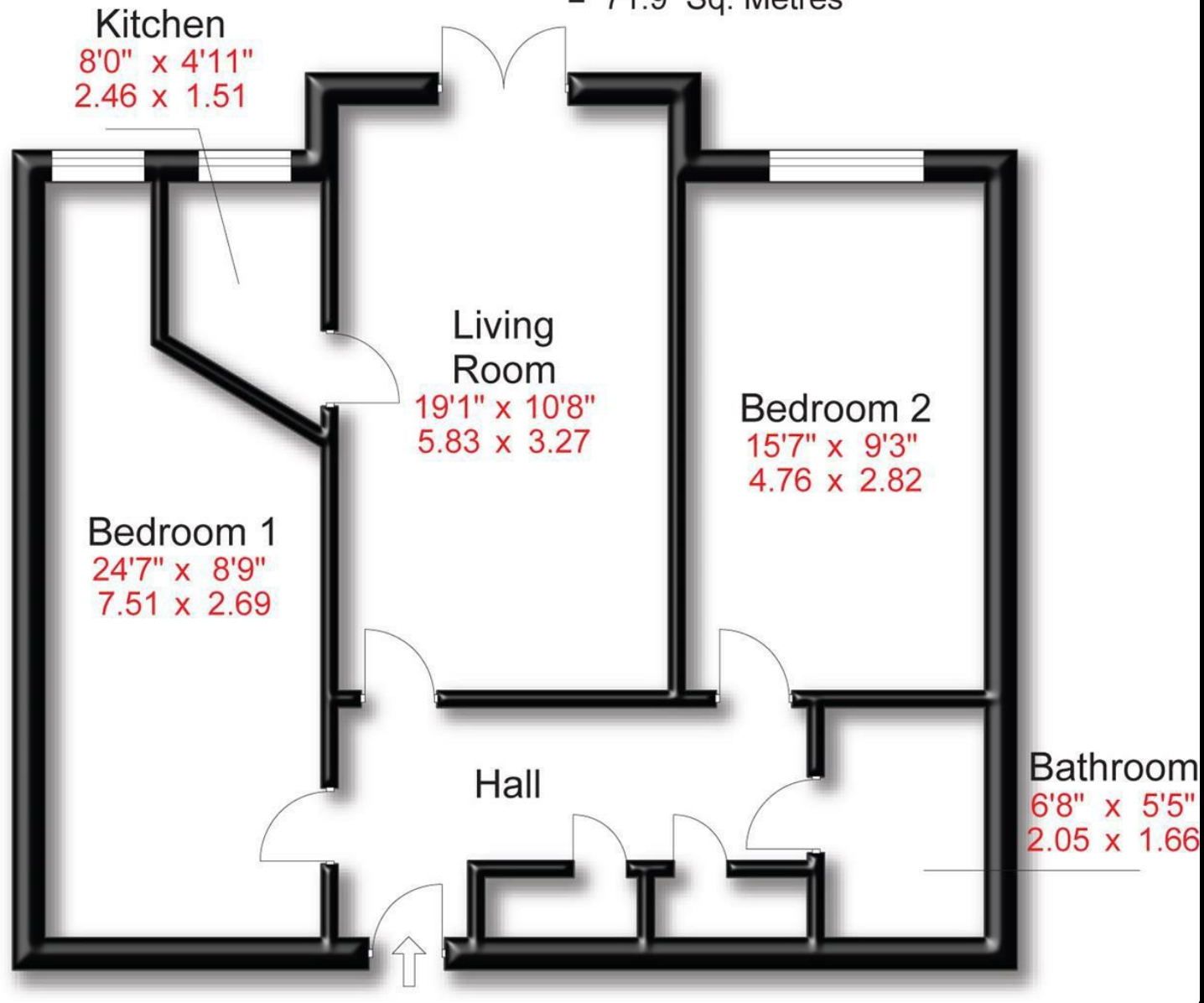

Energy Efficiency Rating		
	Current	Potential
Very energy efficient - lower running costs		
(92 plus) A		
(81-91) B	79	81
(69-80) C		
(55-68) D		
(39-54) E		
(21-38) F		
(1-20) G		
Not energy efficient - higher running costs		
England & Wales	EU Directive 2002/91/EC	



Willow Close | Poynton
Asking Price £250,000



240 Wellington Road South | Stockport | SK2 6NW
t: 0161 480 0099
e: enquiries@hibberthomes.com
www.hibberthomes.com

SALES & LETTINGS

Bedrooms 2

Bath 1

Reception 1

Parking here

Area sq ft

Type here

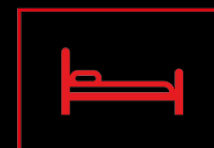

- No Onward Chain
- Stunning Communal Gardens
- 2 Good Sized Bedrooms
- Patio Doors into the Gardens
- McCarthy and Stone Development for over 55's
- Central Poynton Village Location
- Ground Floor

This generous 2 bedroom ground floor apartment offers spacious living accommodation throughout and is located in the heart of Poynton village. Holland Court was constructed by McCarthy and Stone and features a 24 hour house manager, lift access to all floors, a communal lounge area, a laundry room and on site guest rooms for family visits.

The apartment is immaculately presented throughout and comprises of:- Entrance Hall, Lounge with dining area which extends to over 20ft, a kitchen which is comprehensively fitted with a range of wall and base units. Two large double bedrooms with bespoke fitted wardrobes and a contemporary three piece suite shower room.

Externally there are delightful communal gardens to all three sides and in addition a large car park at the front of the apartment block which provides ample off road parking for residents and visitors.

