



King George Close, Cheltenham, GL53 7RF

£1,100 Per Calendar Month





King George Close

Cheltenham, GL53 7RF

- Ground Floor Flat
- Recently Refurbished
- Two Double Bedrooms
- Close to Cox's Meadow

£1,100 Per Calendar Month



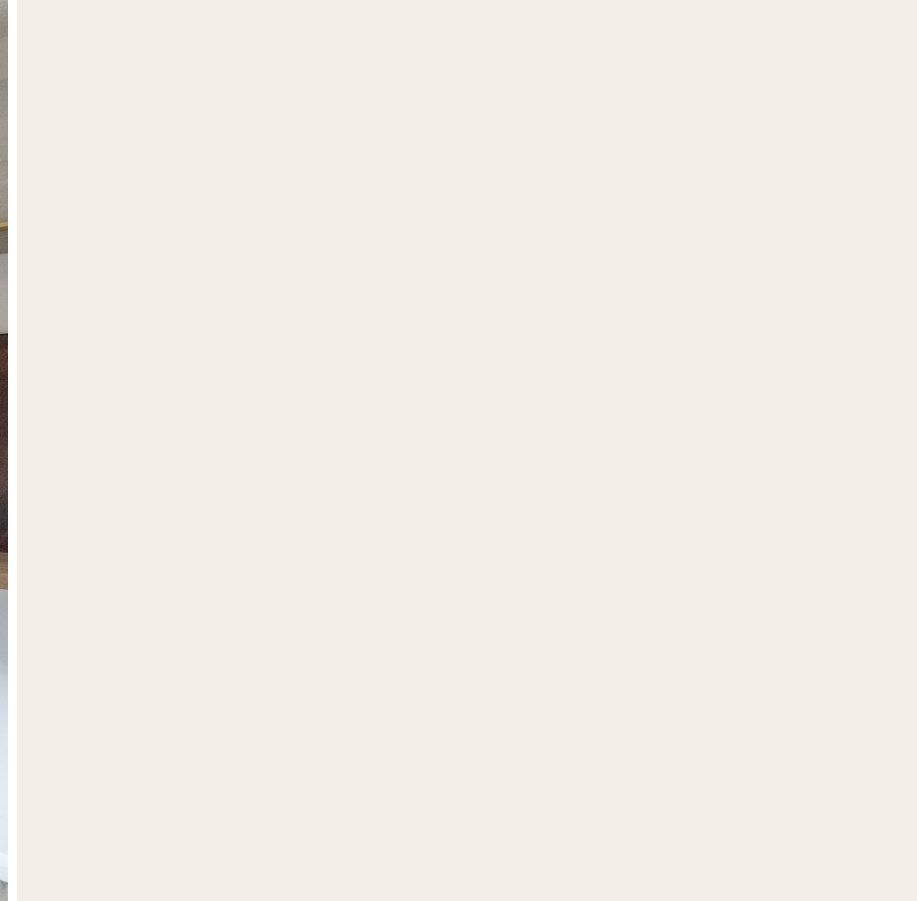

Directions





Floor Plans

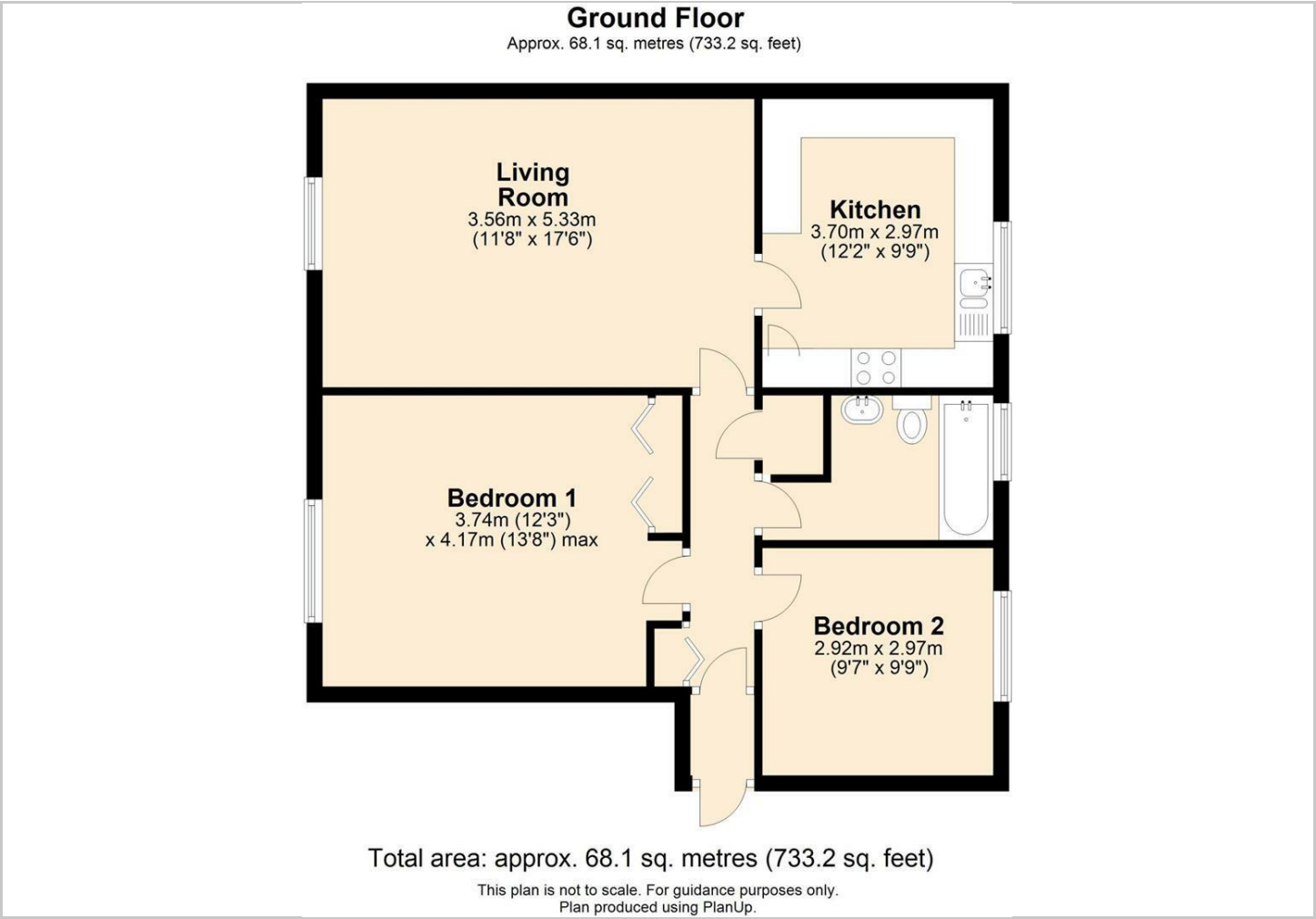

Viewing

Please contact our HMT Office on 01242 521322 if you wish to arrange a viewing appointment for this property or require further information.

The particulars are set out as a general outline only for the guidance of intended purchasers or lessees, and do not constitute, any part of a contract. Nothing in these particulars shall be deemed to be a statement that the property is in good structural condition or otherwise nor that any of the services, appliances, equipment or facilities are in good working order. Purchasers should satisfy themselves of this prior to purchasing.

Location Map

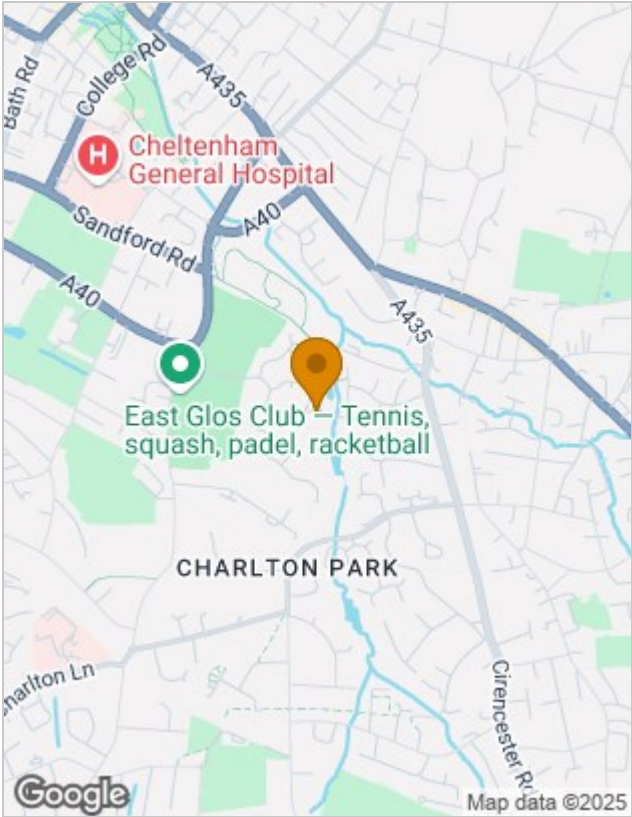

Energy Performance Graph

