

HARDISTY AND CO

GROUND FLOOR
352 sq.ft. (32.7 sq.m.) approx.

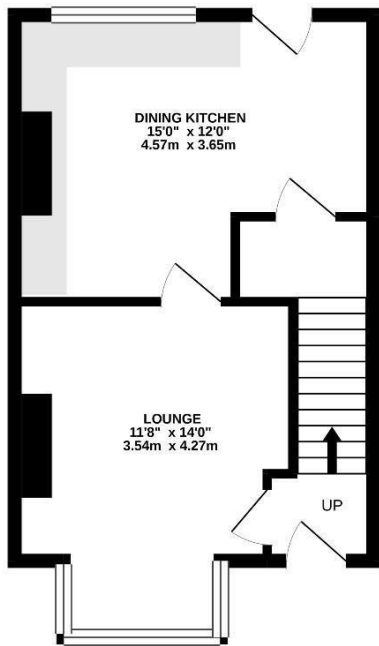

1ST FLOOR
337 sq.ft. (31.3 sq.m.) approx.

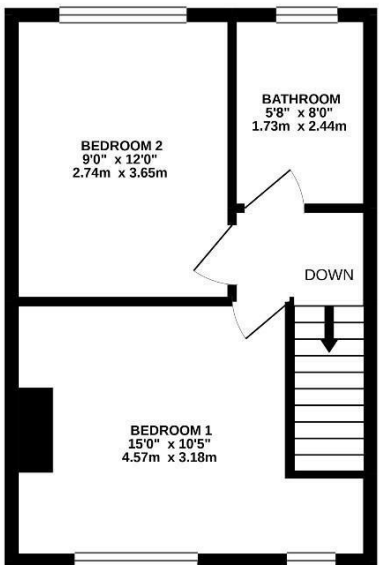

TOTAL FLOOR AREA : 689 sq.ft. (64.0 sq.m.) approx.
Whilst every attempt has been made to ensure the accuracy of the floorplan contained herein, measurements of doors, windows, rooms and any other items are approximate and no responsibility is taken for any error, omission or mis-statement. This plan is for illustrative purposes only and should be used as such for any prospective purchaser. The services, systems and appliances shown have not been tested and no guarantee as to their operability or efficiency can be given.
Made with Metagix ©2020

This computer generated floor plan is intended as a general guide to the layout and design of the property. It is not to scale and should not be relied upon for dimensions, which are only approximate and rounded to either the nearest tenth of a metre or six inches.

Hardisty and Co - Agents note:

Nothing concerning the type of construction is to be implied from the photograph of the property. None of the services, fittings or equipment have been tested and no warranties of any kind can be given. Accordingly, prospective purchasers should bear this in mind when formulating their offers. The seller does not include in the sale any carpets, floor coverings, light fittings, curtains, blinds, furnishings, electric/gas appliances (whether connected or not) or any other fixtures and fittings unless expressly mentioned in these particulars, as forming part of this sale. The extent of the property and its boundaries are subject to verification by inspection of the Deeds by the prospective purchasers. There is a six-inch measurement tolerance, or metric equivalent. The measurements given should not be entirely relied upon and purchasers must take their own measurements if ordering carpets, curtains or any other equipment.

Horsforth
horsforth@hardistyandco.com
0113 2390012

Guiseley
guiseley@hardistyandco.com
01943 870970

Otley
otley@hardistyandco.com
01943 468999



hardistyandco.com

HARDISTY AND CO



Springfield Walk
Horsforth

£195,000
2 BEDROOM HOUSE - TERRACED

hardistyandco.com

INTRODUCTION
Coming soon! Hardisty and Co will soon be launching this two double bedroom terrace home in this popular and convenient location within a walk of many amenities and Horsforth train station. With a modern finish throughout (photos to follow in the next few days) and with garden front and back we expect there to be good interest. Request your viewing now.