



Manor Crescent, Epsom, KT19 7EF



Guide price

£390,000

Freehold

Modern Terraced Home
Driveway for 2 Cars
Southerly Backing Rear Garden
2 Double Bedrooms
Conservatory
Lounge/Diner
Fitted Kitchen
Upstairs Bathroom/Downstairs WC
Walk to Town & Station
Manor Park Location

Located in a popular and accessible position on Epsom's Manor Park this modern home is perfect for young professional and downsizers alike! With 2 off street parking spaces and a sunny, Southerly backing rear garden the property should be viewed first hand to be fully appreciated!.



Description: Homes in Manor Crescent are always popular and this 2 bedroom, terraced property should be no exception. With a Southerly backing rear garden this modern home is arranged over 2 floors. Downstairs an entrance hall leads through to a generous reception room that in turn flows through to the conservatory. There is a fitted kitchen that overlooks the front aspect and a downstairs WC. Upstairs there are 2 double bedrooms and the family bathroom.

Unlike many properties at this price point the property comes with its own driveway providing off street parking for two cars..

Location: Manor Crescent is located on Manor Park to the West of Epsom Town Centre. This wonderful location offers a peaceful environment that is only around a 20 minute walk from Epsom's mainline rail links and bustling High Street. Local amenities, including a Tesco Express, can be found nearby at the Horton Centre and a David Lloyd Health Club, Horton Country Park and local pubs are all within walking distance.





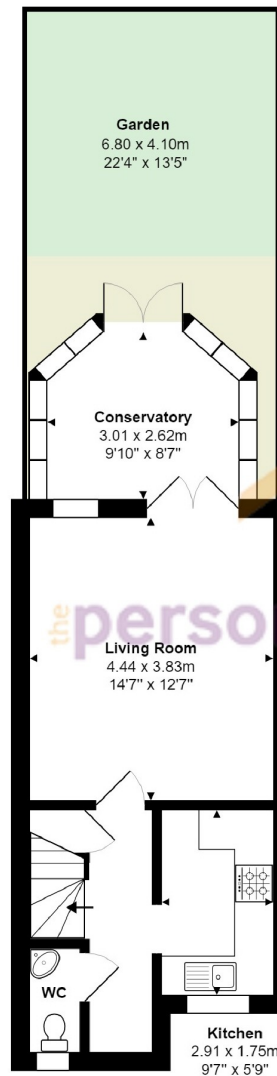

Ground Floor

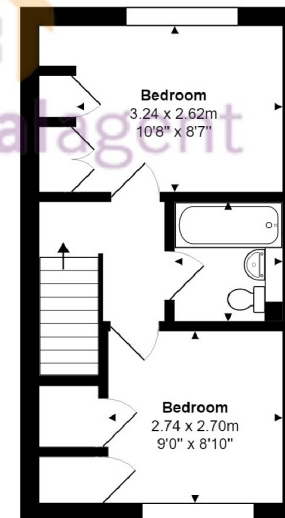

First Floor



Manor Crescent, Epsom

Total Area: 67.4 m² ... 726 ft² (excluding garden)

Floor Plan measurements are approximate and are for illustrative purposes only.

While we do not doubt the floor plans accuracy, we make no guarantee, warranty or representation as to the accuracy and completeness of the floor plan.
www.stillmoving.london © 2018



Please Note: Whilst every attempt has been made to ensure the accuracy of the floorplans contained here, measurements of doors, windows and room areas are approximate and no responsibility is taken for any error, omission or mis-statement. These plans are for representation purposes only and should be used as such by and prospective purchaser. The services, systems and appliances listed in the specification have not been tested by The Personal Agent and no guarantee as to their operating ability or their efficiency can be given. All images and text used to advertise our properties are for the sole use of The Personal Agent Ltd.

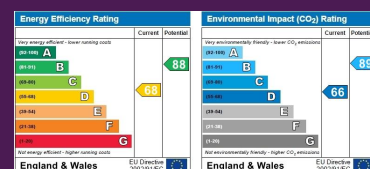

2 West Street, Epsom, Surrey, KT18 7RG, England

Tel: 01372 745850

Email: richard@thepersonalagent.co.uk

www.thepersonalagent.co.uk



