

HUNTERS[®]

HERE TO GET *you* THERE



49 Rosebery Road

Dursley, GL11 4PT

Guide Price £265,000



Council Tax: B



49 Rosebery Road

Dursley, GL11 4PT

Guide Price £265,000



Front

Path from road leading to front door.

Lounge

Wood burner, feature fire place with upvc door and window to front. Ceiling light and access to dining room.

Dining Room

Wood flooring with stairs leading to first floor landing, window into lean to, radiators, ceiling light and built in cupboards.

Utility Room

Laminate flooring and laminate worktops, with plumbing for washer dryer and access into garden.

Kitchen

Space for cooker, fridge freezer and a stainless steel sink, there is wood flooring and base units and shelving, window into lean to and access into bathroom.

Bathroom

Tiled flooring, radiators, frosted glass upvc, wood cladding, with a free standing bath as well as a basin, toilet and spotlights.

Landing

Stairs to attic room, wood flooring.

Bedroom One

Wood flooring throughout, two upvc windows to front, with built in storage.

Bedroom Two

Wood flooring and fire place, Upvc windows to rear as well as shelving.

Attic Room

Upvc windows, built in storage, Velux window to front and views to garden.

Bedroom Three

Carpets, and upvc window to rear, with built in storage.

Outside

Garage leading to private garden.

Hunters are delighted to offer this beautifully presented three bedroom family home with a recently added attic room offering fantastic views to the front and rear. The property briefly comprises of; living room with wood burner, dining room having stairs leading to first floor landing, kitchen, downstairs bathroom, utility, three first floor bedrooms and stairs leading to attic room.

Further benefits include, garage, large rear garden, wood flooring and UPVC windows.

Rosebery Road is an established residential area conveniently located for the Town Centre of Dursley with all its amenities including Sainsbury's supermarket, leisure centre/swimming pool, Rednock Secondary School and excellent Primary schools. Communications to the larger centres of Bristol, Gloucester and Cheltenham can be easily accessed via the A38 and M5 motorway networks and a train station at Box Road, Cam serving Bristol and London (Paddington) via Gloucester

- Beautifully Presented
- Three Bedrooms
- Attic Room
- Seperate Lounge & Dining Room
- Kitchen & Utility
- Garage
- Large Rear Garden
- UPVC Windows
- Wood Burner
- Side Access Available



Road Map

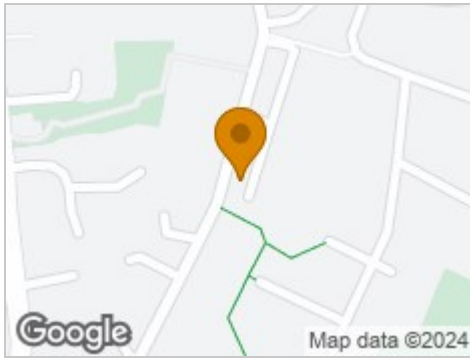

Hybrid Map



Terrain Map



Floor Plan

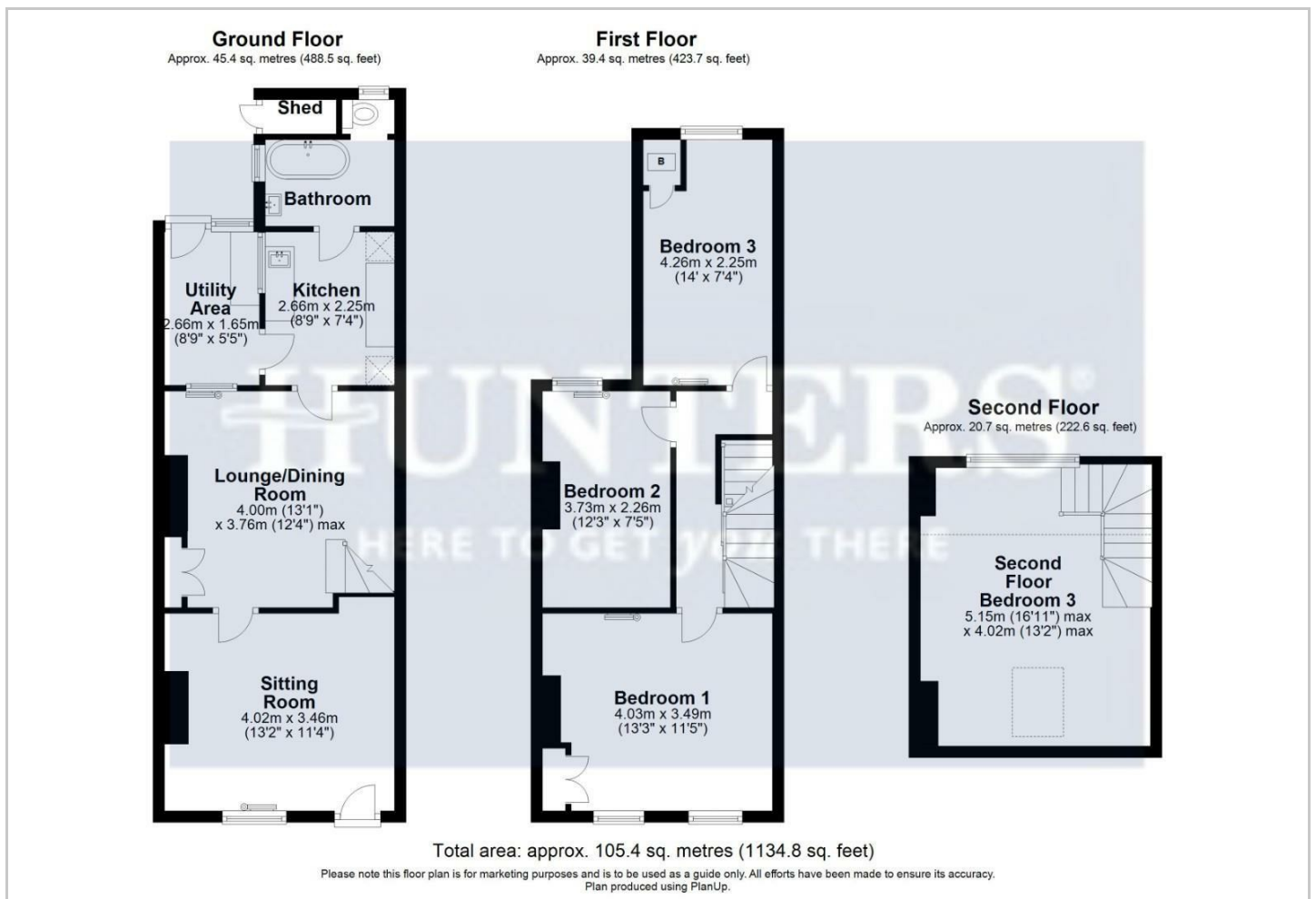

Viewing

Please contact our Hunters Dursley Office on 01453 542 395 if you wish to arrange a viewing appointment for this property or require further information.

Energy Efficiency Graph

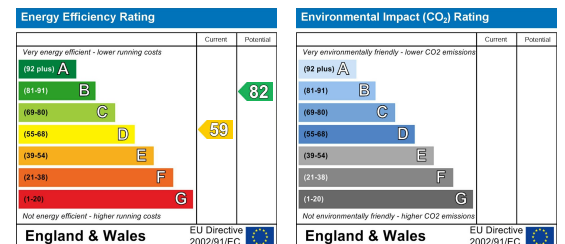

These particulars are intended to give a fair and reliable description of the property but no responsibility for any inaccuracy or error can be accepted and do not constitute an offer or contract. We have not tested any services or appliances (including central heating if fitted) referred to in these particulars and the purchasers are advised to satisfy themselves as to the working order and condition. If a property is unoccupied at any time there may be reconnection charges for any switched off/disconnected or drained services or appliances - All measurements are approximate. **THINKING OF SELLING?** If you are thinking of selling your home or just curious to discover the value of your property, Hunters would be pleased to provide free, no obligation sales and marketing advice. Even if your home is outside the area covered by our local offices we can arrange a Market Appraisal through our national network of Hunters estate agents.