



49 High Street, Hythe, Kent CT21 5AD



## 5 KINGS COURT TWISS ROAD, HYTHE

**£285,000 Leasehold**  
**To Include a share of the Freehold**

A superb second floor purpose built apartment in a sought after location, adjacent to the Royal Military Canal. The property is beautifully presented and finished to a high standard. Comprising an entrance hall, open plan kitchen/living space, two double bedrooms and a bathroom. EPC C.

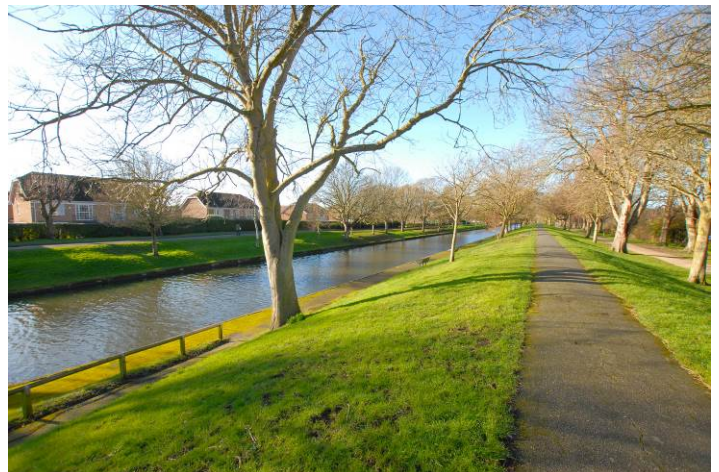

**5 Kings Court  
Twiss Road  
Hythe  
CT21 5NZ**

**Entrance Hall, Open Plan Kitchen/Living Space,  
Two Bedrooms, Bathroom**

**DESCRIPTION**

Kings Court is situated in a desirable location adjacent to the historic Royal Military Canal. This stunning second floor apartment offers impeccably presented, light and airy accommodation. Comprising a welcoming entrance hall, open plan living space which incorporates a sleek modern kitchen with integrated appliances and enjoys pleasant views towards St Leonards Church and Hythe's pretty hillside. There are two double bedrooms and a smart modern bathroom. The property also benefits from an Air Source Heat Pump.

**SITUATION**

Twiss Road is a sought after and convenient central location on level ground, moments from the seafront and the bustling High Street with range of independent shops, boutiques, cafes and restaurants. The town is also well served by four supermarkets (including Waitrose, Aldi and Sainsburys). There are a selection of sports and leisure facilities in the vicinity, including tennis, bowls, cricket, squash and golf clubs, water sports, etc. The larger town of Folkestone is 5 miles and the Cathedral City of Canterbury 15 miles distant.

The area is convenient for commuting to London and the Continent with the M20 motorway (Junction 11) 2½ miles distant, the Channel Tunnel Terminal 3 miles and a mainline railway station at Sandling just over 2 miles away. High Speed trains to London St Pancras are available from both Ashford (10 miles) and Folkestone (Central and West, 5 miles). (All distances are approximate.)

Lawrence & Co for itself and as agent for the vendor or lessor (as appropriate) gives notice that: 1 These particulars are only a general outline for the guidance of intending purchasers or lessees and do not constitute in whole or in part an offer or a Contract. 2 Reasonable endeavours have been made to ensure that the information given in these particulars is materially correct but any intending purchaser or lessee should satisfy themselves by inspection, searches, enquiries and survey as to the correctness of each statement. 3 All statements in these particulars are made without responsibility on the part of Lawrence & Co or the vendor or lessor. 4 No statement in these particulars is to be relied upon as a statement or representation of fact. 5 Neither Lawrence & Co nor anyone in its employment or acting on its behalf has authority to make any representation or warranty in relation to this property. 6 Nothing in these particulars shall be deemed to be a statement that the property is in good repair or condition or otherwise nor that any services or facilities are in good working order. 7 Photographs may show only certain parts and aspects of the property at the time when the photographs were taken and you should rely upon actual inspection. 8 No assumption should be made in respect of parts of the property not shown in photographs. 9 Any areas, measurements or distances are only approximate. 10 Any reference to alterations or use is not intended to be a statement that any necessary planning, building regulation, listed building or any other consent has been obtained. 11 Amounts quoted are exclusive of VAT if applicable. 12 Whilst reasonable endeavours have been made to ensure the accuracy of any floor plan contained in these particulars, all measurements and areas are approximate and no responsibility is taken for any error, omission or mis-statement. This plan is for illustrative purposes only and should be used as such by any prospective purchaser. 12a Any mapping contained within these particulars is for illustrative purposes only and should be used as such by any prospective purchaser. No responsibility is taken for any error, omission or mis-statement.



The accommodation comprises:

### **COMMUNAL ENTRANCE HALL**

Door entry phone system, staircase to second floor.

### **ENTRANCE HALL**

Access to loft space, roof light, wood effect flooring, access to storage cupboard, radiator concealed by decorative cover, recessed lighting, doors to:-

### **KITCHEN/LIVING SPACE**

In two defined areas with wood effect flooring throughout.

#### **Kitchen**

Well fitted with a range of base cupboard and drawer units incorporating integrated dishwasher, washing machine and oven, square edged granite worksurface inset with four burner gas hob with extractor hood above, splashback, coordinating up stands, peninsula breakfast bar with granite worksurface inset with under mounted 1 ½ bowl stainless steel sink with mixer tap and grooved drainer to side, integrated fridge freezer, double glazed window to side with views across Hythe s hillside and of St Leonards Church, recessed lighting.

#### **Living space**

Pair of Velux windows with views over the Royal Military Canal, two radiators concealed by decorative covers, recessed lighting.

### **BEDROOM 1**

Double glazed window to side with views over the Royal Military Canal, recessed lighting, radiator.

### **BEDROOM 2**

Double glazed window to front, Velux window to side with views over the Royal Military Canal, recessed lighting, radiator.

### **BATHROOM**

Panelled bath with mixed tap and shower attachment over, glazed shower screen, low-level WC, pedestal wash basin, Velux window, recessed lighting, extractor fan, heated ladder rack towel rail.

### **LEASE**

We understand that there is the remainder of a 999 year lease which commenced circa 2010, although we understand that the property benefits from a share in the freehold.

### **SERVICE CHARGE**

We understand that the annual service charge is circa £980.00 per annum.

### **EPC Rating C**

### **COUNCIL TAX**

Band C approx. £1952.91 (2023/24)  
Folkestone & Hythe District Council.

### **VIEWING**

Strictly by appointment with **LAWRENCE & CO, 01303 266022.**





# Kings Court, Hythe, CT21

Approximate Gross Internal Area = 58.8 sq m / 633 sq ft

 = Reduced headroom below 1.5m / 5'0

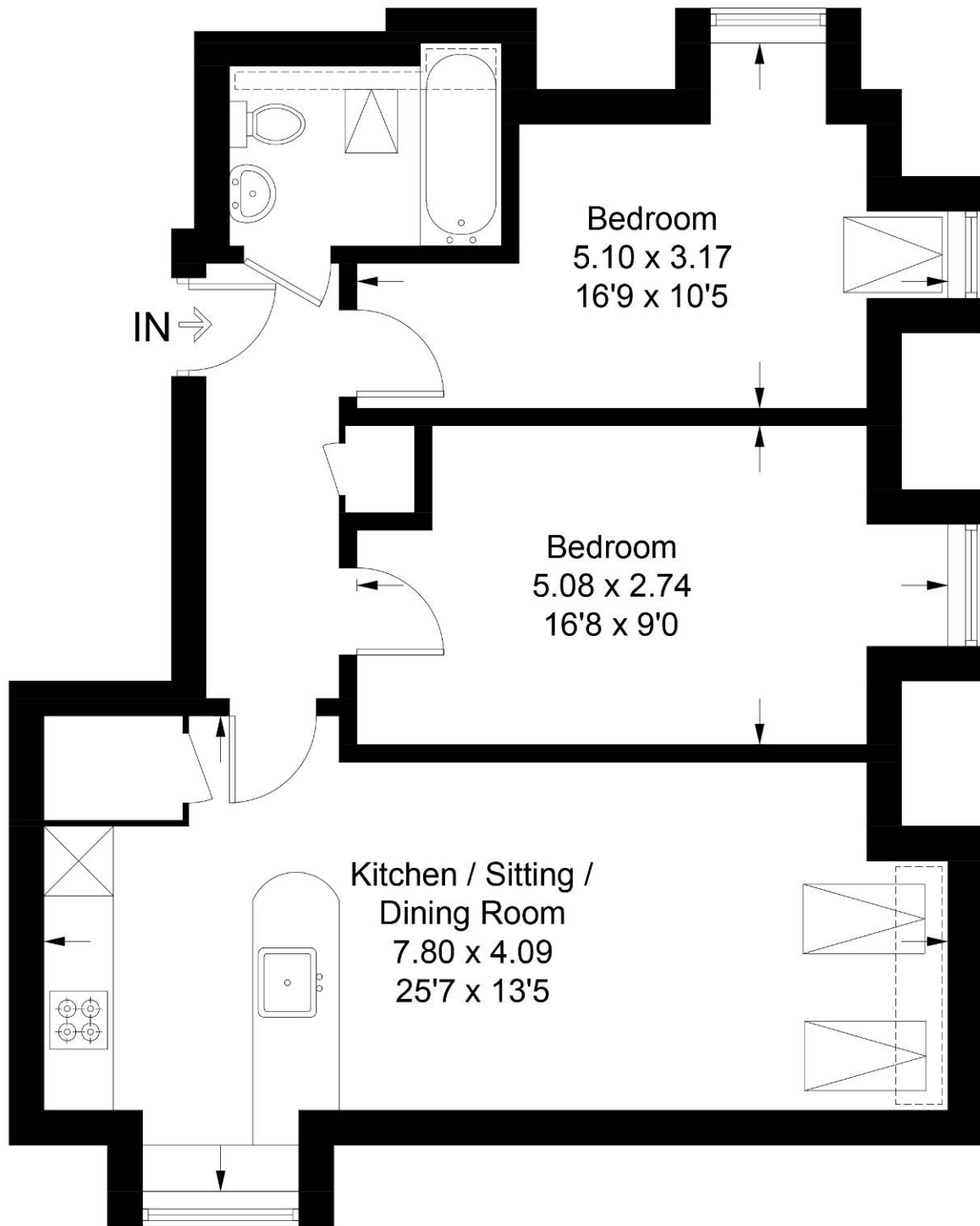

Illustration for identification purposes only, measurements are approximate,  
not to scale. floorplansUsketch.com © (ID1041537)



49 High Street, Hythe, Kent CT21 5AD  
Tel: 01303 266022  
[www.lawrenceandco.co.uk](http://www.lawrenceandco.co.uk)  
[findahome@lawrenceandco.co.uk](mailto:findahome@lawrenceandco.co.uk)