



42 Merton Way, Yarnton, OX5 1NW

Guide Price £335,000 Freehold

THOMAS
MERRIFIELD
SALES LETTINGS



The Property

Situated in the popular village of Yarnton a good sized two double bedroom semi detached home with gardens and driveway parking. No onward chain.

Accommodation comprises entrance hall, living room, kitchen/dining room, two double bedrooms, bathroom.

To the front there is offroad parking, and garden. Rear garden, patio are with remainder laid to lawn with mature shrubs and trees.

No onward chain.

Material information to note.

- Mains electricity, gas and water are connected to this property
- According to OFCOM checker standard, superfast and ultrafast broadband is available at this property.
- According to OFCOM checker coverage is variable outdoor with O2 & Vodafone, Good outdoor and in home with EE and good outdoor and variable in home with Three.
- Properties built pre-2000 may contain asbestos in certain materials used in their construction or in subsequent building work. Examples of these materials are; Artex, vinyl tiles, sheet boards, corrugated roofing, pipework and lagging/insulation. These are generally considered safe unless disturbed but prospective buyers must take their own advice.
- For information on restrictive covenants please contact the office.

EPC Rating:
Council tax: C





Key Features

- Semi detached
- Two bedrooms
- Living room
- Kitchen/dining
- Bathroom
- Front and rear gardens
- Driveway parking
- No onward chain

The Location

Yarnton lies approximately 6 miles North of Oxford and has a well-regarded primary school. There is also a church, village hall, chemist, Doctors' Surgery, supermarket/post office, petrol station, pub, restaurant and garden centre. A more comprehensive range of shops and recreational amenities are available in nearby Woodstock and Kidlington. The School catchment is for Marlborough Secondary School in Woodstock and there is a regular bus service to Oxford with the M40 within 10 miles, giving access to London and The Midlands. The new Oxford Parkway railway station in Water Eaton Kidlington (c3 miles) provides easy access to London Marylebone in approximately 55 mins.

Approximate Gross Internal Area 896 sq ft - 83 sq m

Ground Floor Area 542 sq ft – 50 sq m

First Floor Area 354 sq ft – 33 sq m

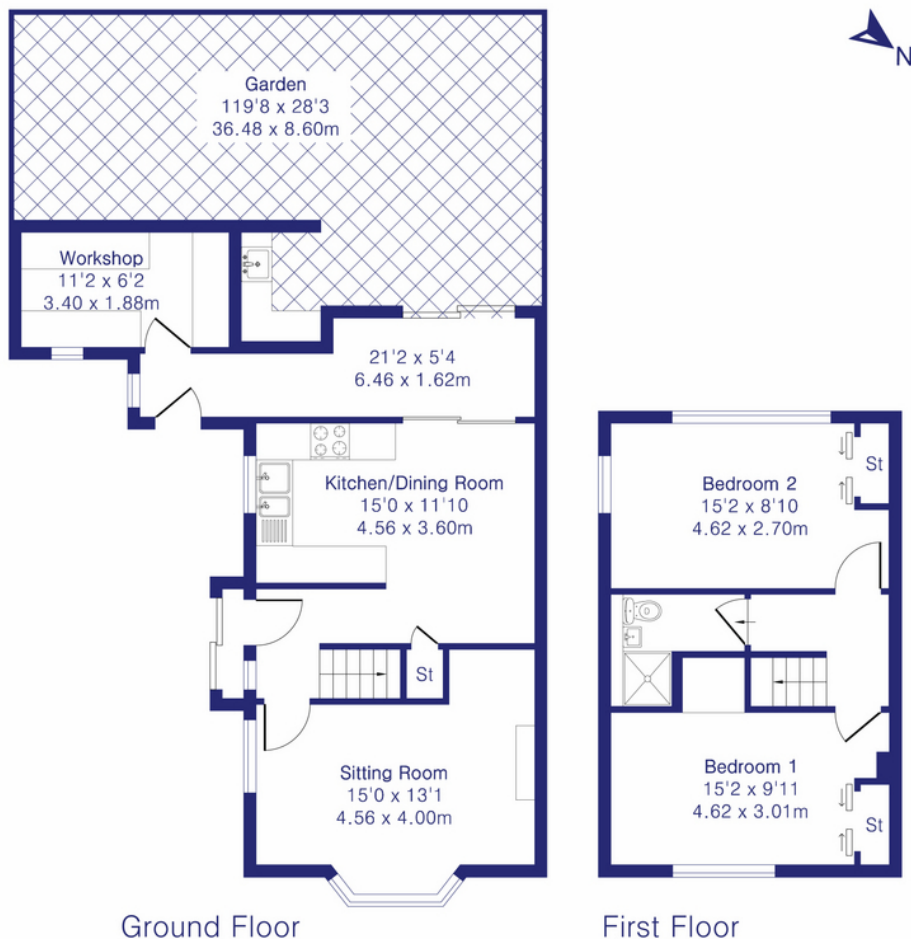

Floor plan produced in accordance with RICS Property Measurement 2nd Edition. Although Pink Plan Ltd ensures the highest level of accuracy, measurements of doors, windows and rooms are approximate and no responsibility is taken for error, omission or misstatement. These plans are for representation purposes only and no guarantee is given on the total square footage of the property within this plan. The figure icon is for initial guidance only and should not be relied on as a basis of valuation.



Thomas Merrifield and their clients give notice that:

1. They are not authorised to make or give any representations or warranties in relation to the property either here or elsewhere, either on their own behalf or on behalf of their client or otherwise. They assume no responsibility for any statement that may be made in these particulars. These particulars do not form any part of any offer or contract and must not be relied upon as statements or representations of fact.

2. Any areas, measurements or distances are approximate. The text, photographs and plans are for guidance only and are not necessarily comprehensive. It should not be assumed that the property has all necessary planning, building regulation or other consents and Thomas Merrifield have not tested any services, equipment or facilities. Purchasers must satisfy themselves by inspection or otherwise.

Kidlington Office

1B The Hampden Building, High Street
Kidlington, Oxfordshire, OX5 2DH

T 01865 379 880

E kidlington@thomasmerrifield.co.uk

W thomasmerrifield.co.uk

