

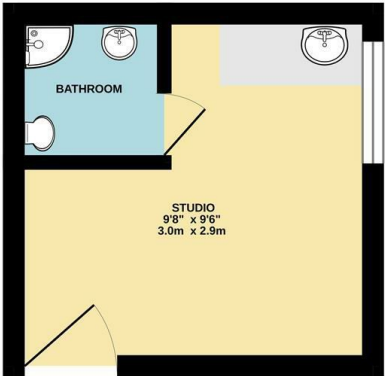

GROUND FLOOR  
92 sq.ft. (8.6 sq.m.) approx.



TOTAL FLOOR AREA: 92 sq.ft. (8.6 sq.m.) approx.  
While every effort has been made to ensure the accuracy of the figures contained herein, measurements of areas, volumes, rooms and any other items are approximate and no responsibility is taken for any error, omission or misstatement. This plan is for illustrative purposes only and should be used as a guide only. Prospective purchasers should verify the accuracy of the figures and measurements with the seller.

Council: | Council Tax Band: | Floor Area: sq ft

Energy Efficiency Rating		
	Current	Potential
Very energy efficient - lower running costs		
(92 plus) <b>A</b>		
(81-91) <b>B</b>		
(69-80) <b>C</b>		
(55-68) <b>D</b>		
(39-54) <b>E</b>		
(21-38) <b>F</b>		
(1-20) <b>G</b>		
Not energy efficient - higher running costs		
<b>England &amp; Wales</b>		
EU Directive 2002/91/EC		

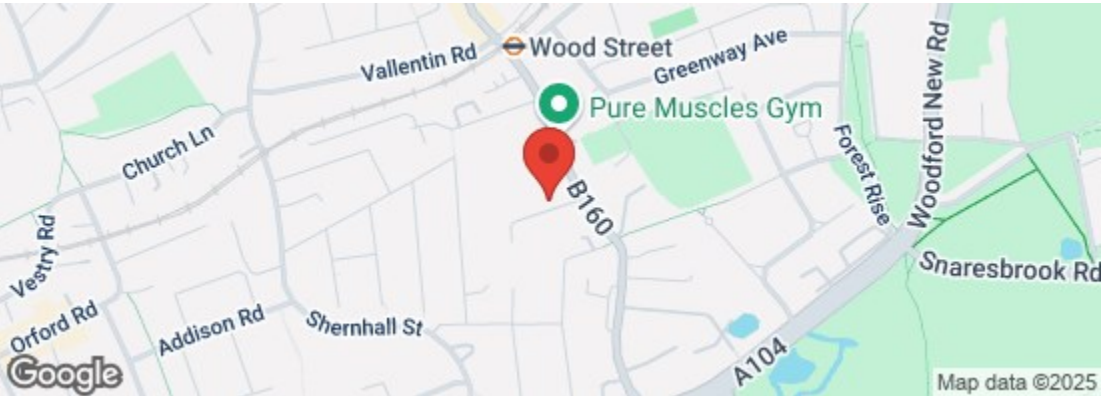

The Agent has not tested any apparatus ,equipment, fixtures and fittings or services and so cannot verify that they are in working order or fit for the purpose. A buyer is advised to obtain verification from their solicitor or surveyor.  
References to the tenure of a property are based on information supplied by the seller. The agent has not had the sight of the title documents. A buyer is advised to obtain verification from their solicitors.

CHURCHILL  
estates



CHURCHILL  
estates

Chestnut Avenue North, London, E17 3NF  
£825 Per Calendar Month

Bedrooms: 1 | Reception Rooms: 1 | Bathrooms: 1



Request a Viewing: **0208 503 6060** Email: **walthamstow@wearechurchills.co.uk**





Available Now - Fully Furnished or Unfurnished - ALL BILLS INCLUDED including WIFI (Washing Machine / Dryer Coin Operated) Churchill Estates are pleased to offer this Self-Contained Studio Apartment within a shared house. The property offers a private bathroom room and kitchenette as well as use of Communal Kitchen & Communal Garden. The property has been recently decorated throughout and offers in-built storage.

The property is well located for access to Wood Street Overground Station as well as Lloyd Park William Morris Gallery, Blackhorse Beer Mile and other local shops / restaurants.

Early Viewings Advised

