

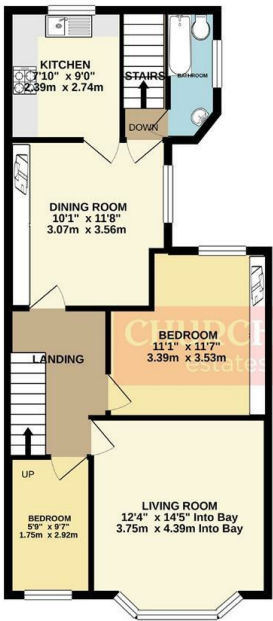

GROUND FLOOR  
655 sq.ft. (60.9 sq.m.) approx.



TOTAL FLOOR AREA - 655 sq.ft. (60.9 sq.m.) approx.  
While every effort has been made to ensure the accuracy of the foregoing information, measurements of items, volumes, rooms and any other items are approximate and no responsibility is taken for any error, omission or misstatement. This plan is for guidance only and should be used in conjunction with the property particulars. The services, repairs and appliances shown on the plan are not to be taken as a guarantee as to their operability or efficiency can be given. Plans are for reference only.

Council: | Council Tax Band: | Floor Area: sq ft

Energy Efficiency Rating		
	Current	Potential
Very energy efficient - lower running costs		
(92 plus) A		
(81-91) B		
(69-80) C		
(55-68) D		
(39-54) E		
(21-38) F		
(1-20) G		
Not energy efficient - higher running costs		
England & Wales	EU Directive 2002/91/EC	



The Agent has not tested any apparatus ,equipment, fixtures and fittings or services and so cannot verify that they are in working order or fit for the purpose. A buyer is advised to obtain verification from their solicitor or surveyor.  
References to the tenure of a property are based on information supplied by the seller. The agent has not had the sight of the title documents. A buyer is advised to obtain verification from their solicitors.



CHURCHILL  
estates

Scotts Road, Leyton, E10 6LN  
£1,650 Per Calendar Month

Bedrooms: 2 | Reception Rooms: 2 | Bathrooms: 1



Request a Viewing: 0208 503 6060 Email: walthamstow@churchill-estates.co.uk

CHURCHILL  
estates





Available 3rd May 2025 - Part Furnished - Churchill Estates are pleased to offer this Two Bedroom First Floor Maisonette with private rear garden located close to Leyton Midland Station, Local Bus/Cycle Routes and Shopping Amenities.

The property is well presented throughout and boasts gas central heating, kitchen with appliances, modern newly fitted bathroom suite, double glazing and private entrance.

Early Viewing Advised.

