

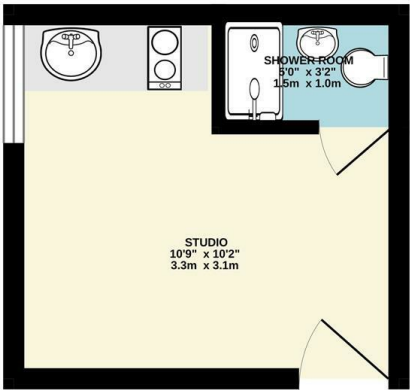

GROUND FLOOR
109 sq.ft. (10.1 sq.m.) approx.



TOTAL FLOOR AREA: 109 sq.ft. (10.1 sq.m.) approx.
Whilst every attempt has been made to ensure the accuracy of the floorplan contained herein, measurements of doors, windows, rooms and any other items are approximate and no responsibility is taken for any errors, omissions or misstatements. This plan is for guidance purposes only and should be used as such for any prospective purchase. The estate agent, Churchill Estates, does not warrant the accuracy of the floorplan or its contents. It is recommended that you obtain a professional survey of the property before purchase. Map data ©2025

Council: Waltham Forest | Council Tax Band: Exempt | Floor Area: 110.00 sq ft

Energy Efficiency Rating		
	Current	Potential
Very energy efficient - lower running costs		
(92 plus) A		84
(81-91) B		
(69-80) C		
(55-68) D		
(39-54) E		
(21-38) F	57	
(1-20) G		
Not energy efficient - higher running costs		
England & Wales		
EU Directive 2002/91/EC		



The Agent has not tested any apparatus ,equipment, fixtures and fittings or services and so cannot verify that they are in working order or fit for the purpose. A buyer is advised to obtain verification from their solicitor or surveyor.
References to the tenure of a property are based on information supplied by the seller. The agent has not had the sight of the title documents. A buyer is advised to obtain verification from their solicitors.

CHURCHILL
estates



CHURCHILL
estates

Forest Road, Walthamstow, E17 5JN
£925 Per Calendar Month

Bedrooms: 1 | Reception Rooms: 1 | Bathrooms: 1



Request a Viewing: 0208 503 6060 Email: walthamstow@churchill-estates.co.uk



Available Now - Fully Furnished or Unfurnished - ALL BILLS INCLUDED including WIFI, Gas Electric, Water and Council Tax (Washing Machine / Dryer Coin Operated) Churchill Estates are pleased to offer this Self-Contained Studio Apartment. The property offers a private shower room and kitchenette. The property has been recently decorated throughout to a modern standard.

The property is well located for access to Blackhorse Road Victoria Line Station as well as Lloyd Park William Morris Gallery, Blackhorse Beer Mile and other local shops / restaurants.

Early Viewings Advised

