

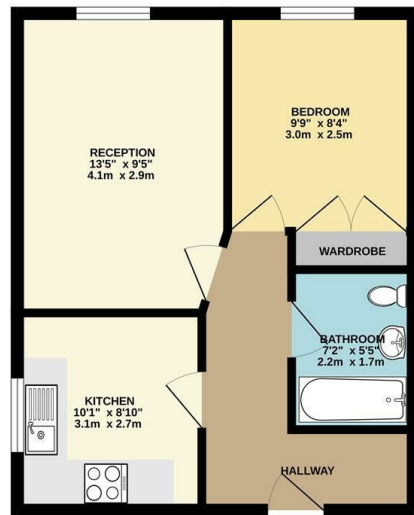

SECOND FLOOR
393 sq.ft. (36.5 sq.m.) approx.



TOTAL FLOOR AREA: 393 sq.ft. (36.5 sq.m.) approx.
While every effort has been made to ensure the accuracy of the floorplan, measurements of doors, windows, stairs and any other items are approximate and the responsibility is taken for any errors, omissions or misstatements. This plan is for illustrative purposes only and should not be used as a legal document. The services, contents and equipment shown are not intended to be guaranteed. All floor space is available for use unless otherwise stated.

Council: Waltham Forest | Council Tax Band: B | Floor Area: 430.00 sq ft

Energy Efficiency Rating		Current	Potential
Very energy efficient - lower running costs			
(92 plus) A			
(81-91) B			
(69-80) C			
(55-68) D			
(39-54) E			
(21-38) F			
(1-20) G			
Not energy efficient - higher running costs			
England & Wales		EU Directive 2002/91/EC	
		78	83



The Agent has not tested any apparatus, equipment, fixtures and fittings or services and so cannot verify that they are in working order or fit for the purpose. A buyer is advised to obtain verification from their solicitor or surveyor. References to the tenure of a property are based on information supplied by the seller. The agent has not had the sight of the title documents. A buyer is advised to obtain verification from their solicitors.



Forest Road, London, E17 6JT
£1,395 Per Calendar Month

Bedrooms: 1 | Reception Rooms: 1 | Bathrooms: 1



Request a Viewing: **0208 503 6060** Email: walthamstow@churchill-estates.co.uk



Available 27th May 2024 - Unfurnished - Churchill Estates are delighted to offer this newly refurbished One Double Bedroom Third floor Flat situated within this modern, purpose built, gated development located moments from Blackhorse Road Station and Local Bus Routes., Local amenities / Restaurants & Blackhorse Beer Mile.

The property boasts access to communal car parking and further benefits include security entry-phone system, double glazing, modern fitted kitchen with appliances, electric heating and a Large Living/Dining room.

Early Viewings Advised.

