

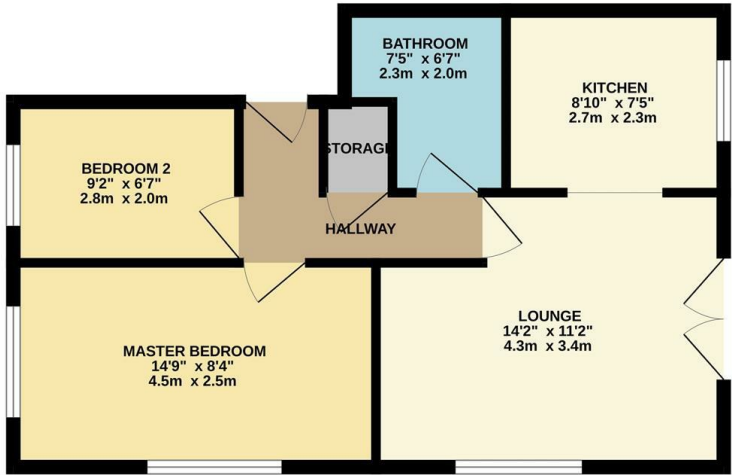



GROUND FLOOR
487 sq.ft. (45.2 sq.m.) approx.



TOTAL FLOOR AREA: 487 sq.ft. (45.2 sq.m.) approx.
Whilst every attempt has been made to ensure the accuracy of the floorplan contained here, measurements of areas, windows, rooms and any other items are approximate and no responsibility is taken for any error, omission or mis-statement. This plan is for illustrative purposes only and should be used as such by any prospective purchaser. The services, systems and appliances shown have not been tested and no guarantee as to their operability or efficiency can be given.
Made with Mapbox ©2025

Council: Waltham Forest Council | Council Tax Band: C | Floor Area: 487.00 sq ft

Energy Efficiency Rating		
	Current	Potential
Very energy efficient - lower running costs		
(92 plus) A		76
(81-91) B		
(69-80) C		
(55-68) D		
(39-54) E		
(21-38) F	65	
(1-20) G		
Not energy efficient - higher running costs		
England & Wales		EU Directive 2002/91/EC 

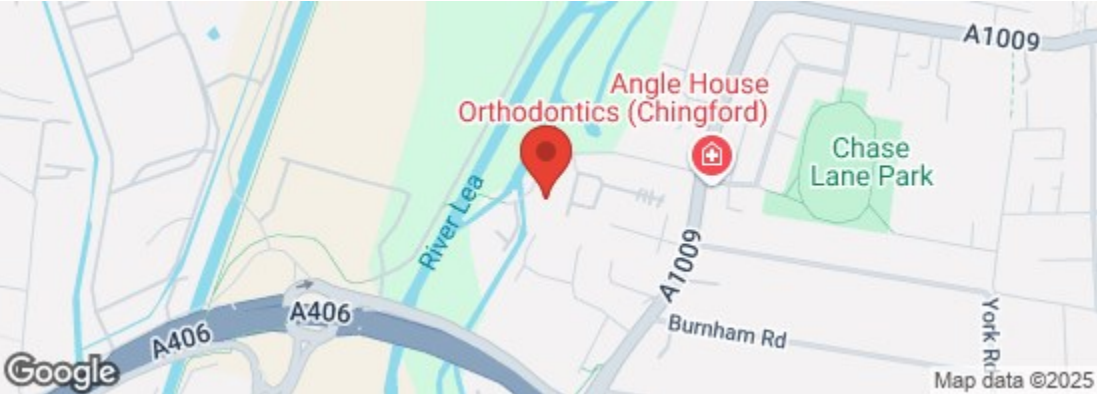

The Agent has not tested any apparatus ,equipment, fixtures and fittings or services and so cannot verify that they are in working order or fit for the purpose. A buyer is advised to obtain verification from their solicitor or surveyor.
References to the tenure of a property are based on information supplied by the seller. The agent has not had the sight of the title documents. A buyer is advised to obtain verification from their solicitors.



Mandeville Court, Chingford, E4 8JD

£1,550 Per Month

Bedrooms: 2 | Reception Rooms: 1 | Bathrooms: 1



Request a Viewing: **020 8529 5500** Email: **northchingford@churchill-estates.co.uk**



Churchill Estates are delighted to offer to rent this exceptional well maintained furnished 2 bedroom ground floor flat located in popular modern development located off Lower Hall Lane accessible to The Mount South Chingford and North Circular A406 the property offers good sized lounge, two bedrooms, fitted kitchen, electric heating, security entry system, available mid February.

