

Bodlonfa Hall Mews, Rhualt, Denbighshire LL17 0TT

£335,000

🛏 4 🚗 2 🛋 1



This attractive four bedroom mews cottage is situated in a private courtyard within easy access of the A55 expressway and is surrounded by stunning countryside views. This property offers immense charm and character and must be viewed internally for the space to be fully appreciated with a large rear garden, additional parking and a useful OUTBUILDING/STUDY.

DIRECTIONS From St Asaph proceed along the A55, continue up Rhualt Hill, exit at the tourist information sign for the camping site. Turn left at the pond and proceed for approximately half a mile, turn left signposted Bodlonfa Hall, follow the lane around the sharp bend and the archway to the courtyard will be seen directly ahead.

Key Features

- ATTRACTIVE MEWS COTTAGE
- SPACIOUS LOUNGE/DINER
- LARGE REAR GARDEN
- CHARM & CHARACTER
- FREEHOLD
- FOUR BEDROOMS
- BATHROOM & ENSUITE
- USEFUL OUTBUILDING/STUDY
- DRIVEWAY
- COUNCIL TAX - F EPC -F

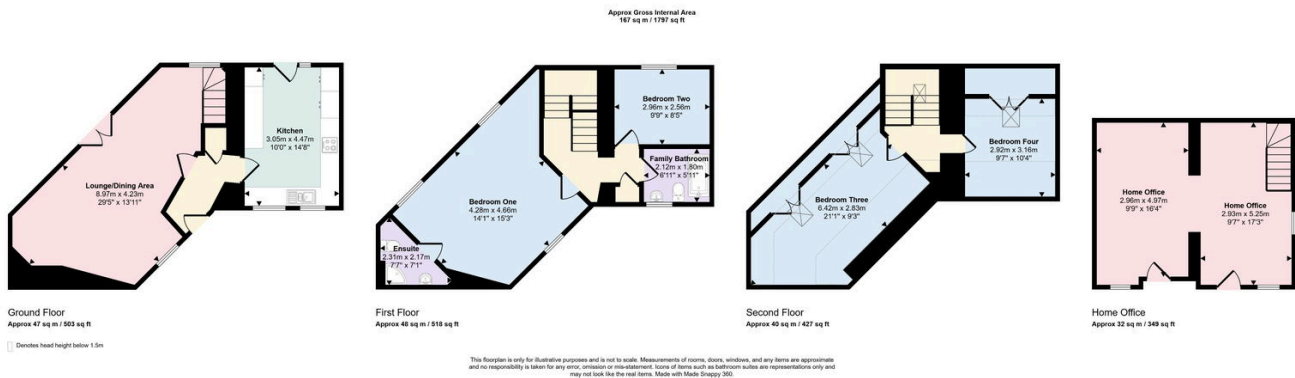

CONSUMER PROTECTION REGULATIONS 2008 AND THE BUSINESS PROTECTION FROM MISLEADING MARKETING REGULATIONS 2008

These particulars, whilst believed to be accurate, are set out for guidance only and do not constitute any part of an offer or contract. Prospective purchasers or tenants should not rely on these particulars as statement or representation of fact, but must satisfy themselves by inspection or otherwise as to their accuracy. No person in the employment of PETER LARGE Estate Agents has the authority to make or give any representation or warranty in relation to the property. Room sizes are approximate and all comments are of the opinion of PETER LARGE Estate agents having carried out a walk through inspection. These sales particulars are prepared under the consumer regulations 2008 and are governed by the business from misleading marketing regulations 2008.