

Bryn Tirion, Berthengam, Trelogan, Flintshire CH8 9BZ

£485,000

🛏 4 🚿 3 🚿 3



This detached house was built approximately nineteen years ago by a local builder of high repute and has been further improved by the current owner to provide a modern family home in a sought after village location with views over open countryside. The property can be described as well presented throughout offering tasteful decoration with Oak flooring, a fantastic kitchen come family/dining room, split level lounge, sitting room come home office, cloakroom, utility and additional boot room with an attached games room. Having four double bedrooms, two of which enjoy ensuite facilities & luxury family bathroom. An enclosed good size lawn garden with seating areas and rear courtyard with useful Store/Workshop.

Key Features

- TASTEFULLY DECORATED THROUGHOUT
- TWO ENSUITES & LUXURY BATHROOM
- UTILITY, CLOAKS & BOOT ROOM
- WRAP AROUND GARDENS
- FREEHOLD
- FOUR DOUBLE BEDROOMS
- FANTASTIC KITCHEN/FAMILY DINING ROOM
- SPLIT LEVEL LOUNGE & SITTING ROOM
- GAMES ROOM, STORE & DRIVEWAY
- COUNCIL TAX - G EPC -E

Approx Gross Internal Area
201 sq m / 2166 sq ft



Ground Floor
Approx 117 sq m / 1260 sq ft

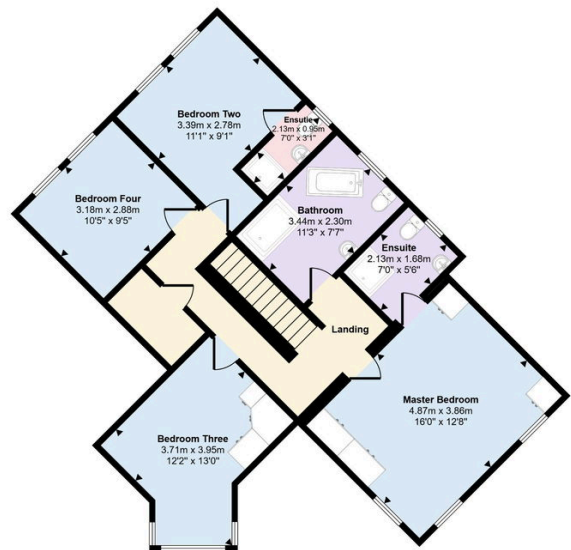

First Floor
Approx 84 sq m / 907 sq ft

This floorplan is only for illustrative purposes and is not to scale. Measurements of rooms, doors, windows, and any items are approximate and no responsibility is taken for any error, omission or mis-statement. Icons of items such as bathroom suites are representations only and may not look like the real items. Made with Made Snappy 360.

CONSUMER PROTECTION REGULATIONS 2008 AND THE BUSINESS PROTECTION FROM MISLEADING MARKETING REGULATIONS 2008

These particulars, whilst believed to be accurate, are set out for guidance only and do not constitute any part of an offer or contract. Prospective purchasers or tenants should not rely on these particulars as statement or representation of fact, but must satisfy themselves by inspection or otherwise as to their accuracy. No person in the employment of PETER LARGE Estate Agents has the authority to make or give any representation or warranty in relation to the property. Room sizes are approximate and all comments are of the opinion of PETER LARGE Estate agents having carried out a walk through inspection. These sales particulars are prepared under the consumer regulations 2008 and are governed by the business from misleading marketing regulations 2008.