

## 15 Rhodfa Glenys, St Asaph, Denbighshire LL17 0DW

£270,000

🛏️ 4 🚗 1 🚲 2



This link detached family home which has been extended to provide four double bedrooms, good size lounge, dining through sitting room, fitted kitchen, cloak room, shower room and garage with off road parking. Having gas fired heating, double glazing and gardens to both front and rear. Situated in a cul-de-sac position viewing is highly recommended.

**DIRECTIONS** from the High St proceed onto Mount Road and take the third right onto Rhodfa Glenys, bear right and the property can be found on the right hand side.

## Key Features

- EXTENDED LINK DETACHED HOUSE
- TWO RECEPTION ROOMS
- EASY ACCESS FOR THE A55
- GARAGE & DRIVEWAY
- FREEHOLD
- FOUR DOUBLE BEDROOMS
- SHOWER ROOM & CLOAKS
- GAS FIRED HEATING & DOUBLE GLAZING
- IDEAL FOR FAMILY OCCUPATION
- EPC - C COUNCIL TAX BAND - D



**Ground Floor**

Floor area 71.9 sq.m. (774 sq.ft.) approx

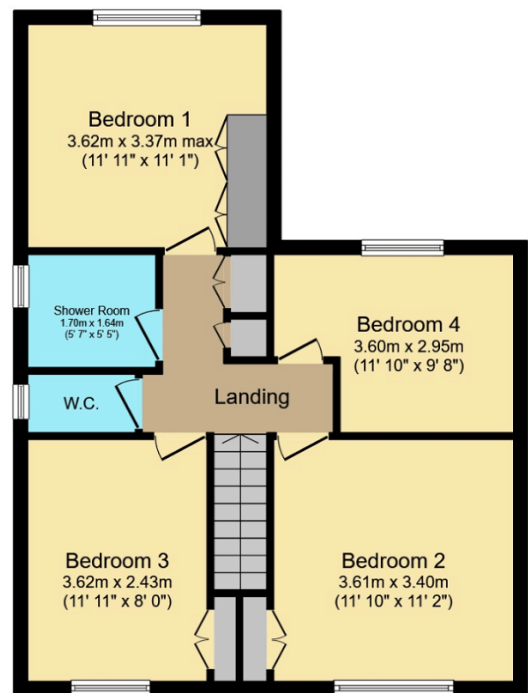

**First Floor**

Floor area 59.4 sq.m. (639 sq.ft.) approx

Total floor area 131.3 sq.m. (1,414 sq.ft.) approx

This plan is for illustration purposes only and may not be representative of the property. Plan not to scale.

Powered by audioagent.com