



FOR SALE

Prittlewell Chase, Westcliff-On-Sea SS0 0PW

Offers In Excess Of £625,000 Freehold Council Tax Band - D

1851.00 sq ft

- Semi-Detached Four Bedroom Property
- Four Double Bedrooms
- Two Reception Rooms
- Large Kitchen Diner
- Attached Garage
- Generously Sized Rear Garden
- Good School Catchments Nearby
- Situated Close To Transport Routes
- Four Piece Bathroom
- Local Amenities Nearby

Selling & letting all types of property in Chalkwell,
Westcliff, Leigh, Southend and the surrounding areas.

appointmoor

Description

****4 LARGE DOUBLE BEDROOMS****

Welcome to Prittlewell Chase, a large four bedroom semi-detached family home situated in the heart of Westcliff On Sea. If you are a growing family looking for a spacious home within catchment for great schools, this is a must view!

Offering two large reception rooms, an impressively sized kitchen/diner, downstairs W/C, four double bedrooms spread across two floors, two bathrooms, garage and large rear garden. With a large driveway you have ample parking space including an electric charging point for your car.

Within catchment for some fantastic schools, easy transport routes and local amenities nearby, you are within a great location for everything needed day to day.

If you are searching for a new home and looking for a property with an impressive space and potential, give us a call now to arrange a viewing!

Entrance Hall

20'1 x 4'9 (6.12m x 1.45m)

UPVC double glazed obscure glass stained door to entrance, wooden flooring, radiator, coving to ceiling, pendant lighting.

Lounge

21'5 x 11'9 (6.53m x 3.58m)

Carpet flooring, radiator, double glazed sliding door to rear, dado rail, coving to ceiling, ceiling mounted lighting.

Dining Room

14'2 x 12'1 (4.32m x 3.68m)

Carpet flooring, radiator, double glazed window to front aspect, coving to ceiling, pendant lighting.

Kitchen/Diner

18'8 x 12'6 (5.69m x 3.81m)

Laminate flooring, radiator, double glazed window to rear aspect, double glazed obscure window to side aspect, double glazed door to rear aspect, base & wall units, rolltop worksurface incorporating stainless steel sink & drainer, space for fridge/freezer, space and plumbing for washing machine and dishwasher, space for cooker with extractor over, dado rail, coving to ceiling, pendant lighting.

Downstairs W/C

10'7 x 10'1 (3.23m x 3.07m)

Wooden flooring, double glazed obscure window to side aspect, tiled walls, space for appliances such as washing machine, hand basin, W/C, ceiling mounted lighting.

Landing

14'7 x 6'1 (4.45m x 1.85m)

Carpet flooring, double glazed window to side aspect, coving to ceiling, pendant lighting.

Bedroom 2

13'3 x 13'6 (4.04m x 4.11m)

Carpet flooring, radiator, double glazed window to front aspect, fitted storage, spotlight lighting.

Bedroom 3

14'3 x 12'4 (4.34m x 3.76m)

Carpet flooring, radiator, double glazed window to front aspect, storage cupboard, pendant lighting.

Bathroom

10'7 x 10'1 (3.23m x 3.07m)

Laminate flooring, radiator, double glazed window to rear aspect, double glazed obscure window to side aspect, partially tiled walls, storage cupboard, panelled bath, shower cubicle, hand basin, W/C, bidet, ceiling mounted lighting.

Bedroom 4

12'5 x 12'8 (3.78m x 3.86m)

Carpet flooring, radiator, double glazed window to rear aspect, fitted storage, ceiling mounted lighting.

Landing

9'7 x 2'8 (2.92m x 0.81m)

Double glazed window to side aspect, eaves storage, pendant lighting.

Bedroom 1

18'1 x 15'3 (5.51m x 4.65m)

Wooden flooring, eaves storage, double glazed window to rear aspect, double glazed Velux window to front aspect, ceiling mounted lighting.

En-Suite

8'5 x 8'2 (2.57m x 2.49m)

Tiled flooring, radiator, double glazed Velux window to front aspect, tiled walls, shower cubicle, W/C, hand basin, spotlight lighting.

Garage

17'4 x 8'4 (5.28m x 2.54m)

Concrete flooring, up and over door, power & lighting.

Rear Garden

Concrete patio area, laid lawn, side access, outside water tap.

Front Of Property & Parking

Block paved pathway with space for several vehicles, Electric car charging port, laid lawn.

School Catchments

Chase High School

St Thomas More High School

Earls Hall Primary School



GROUND FLOOR

1ST FLOOR

2ND FLOOR

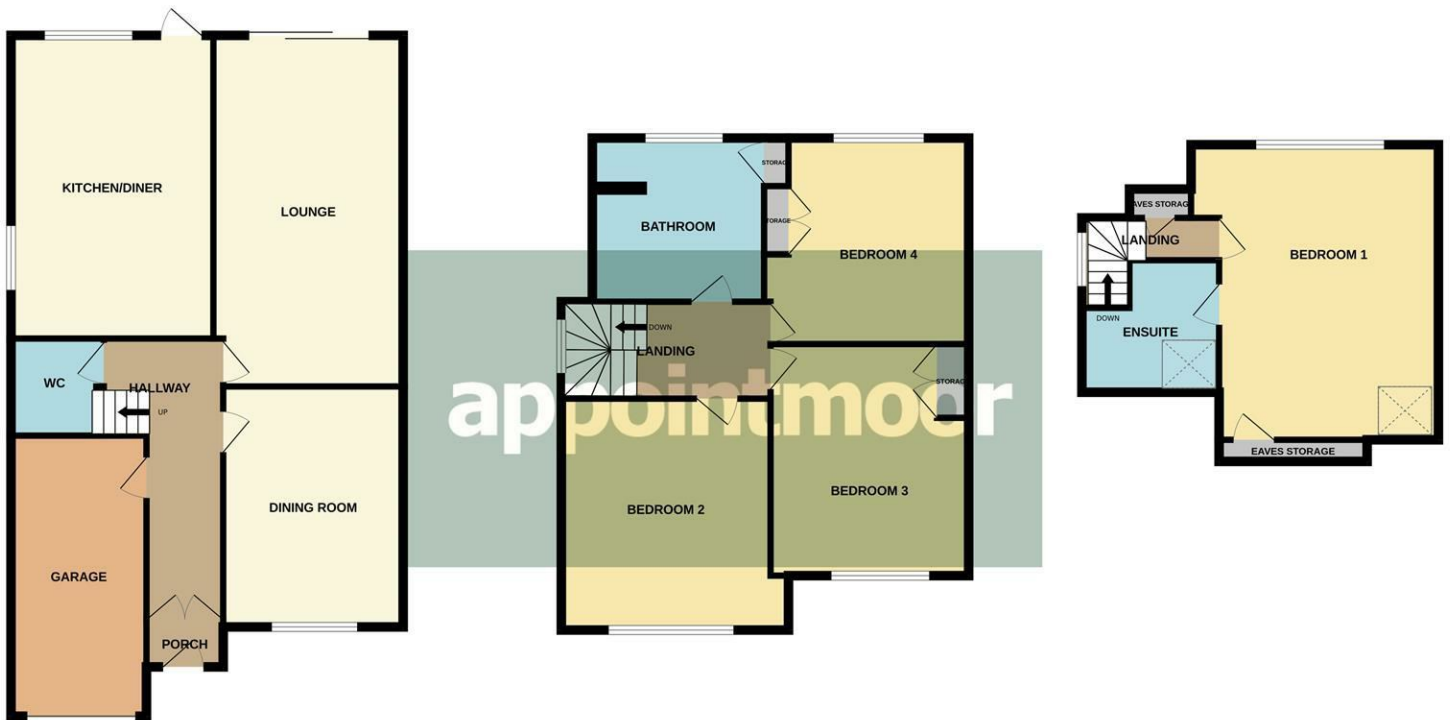

Whilst every attempt has been made to ensure the accuracy of the floorplan contained here, measurements of doors, windows, rooms and any other items are approximate and no responsibility is taken for any error, omission or mis-statement. This plan is for illustrative purposes only and should be used as such by any prospective purchaser. The services, systems and appliances shown have not been tested and no guarantee as to their operability or efficiency can be given.
Made with Metropix ©2025

Energy Efficiency Rating

	Current	Potential
Very energy efficient - lower running costs		
(92 plus) A		
(81-91) B		
(69-80) C		
(55-68) D		
(39-54) E		
(21-38) F		
(1-20) G		
Not energy efficient - higher running costs		
England & Wales	EU Directive 2002/91/EC	79

Environmental Impact (CO₂) Rating

	Current	Potential
Very environmentally friendly - lower CO ₂ emissions		
(92 plus) A		
(81-91) B		
(69-80) C		
(55-68) D		
(39-54) E		
(21-38) F		
(1-20) G		
Not environmentally friendly - higher CO ₂ emissions		
England & Wales	EU Directive 2002/91/EC	

AGENTS NOTES: Appointmoor Estates Ltd as our Vendors Agents have endeavoured to check the accuracy of these sales particulars, but however, can offer no guarantee. These details are prepared as a general guide only, including details regarding lease, service charge, lease length and ground rent/review periods, council tax and deposit amount, and should not be relied upon as a basis to enter into a legal contract, or commit expenditure. An interested party should consult their own independent experts to verify the statements contained herein and before committing themselves to any expenditure or other legal commitments. The agent will not be responsible for any verbal statement made by any member of staff, as only a specific written confirmation should be relied upon. The agent will not be responsible for any loss other than when specific written confirmation has been requested. Floor plans are not to scale and only provide an indication of the layout. All measurements are approximate and should not be relied upon. We have not tested any apparatus, equipment, fixture, fittings or service and so cannot verify they are in working order, fit for their purpose, or within ownership of the sellers. Items shown in photographs are NOT included unless specifically mentioned in writing within the sales particulars.

VIEWINGS: BY APPOINTMOOR ESTATES ONLY

appointmoor

Appointmoor Sales 72 The Ridgeway,
Chalkwell, Westcliff-on-Sea, Essex, SS0 8NU
T. 01702 719966 W. appointmoor.co.uk



facebook.com/appointmoor



Instagram.com/appointmoor_estate_agents



twitter.com/appointmoor



linkedin.com/company/appointmoor