

Jonathan Hunt

ESTATE AGENCY

20 High Street Ware SG12 9BX

Tel: 01920 411090

8 High Street Buntingford SG9 9AG

Tel: 01763 272727

info@jonathan-hunt.co.uk

www.jonathanhunt.co.uk



33 Whiteley Close, Dane End, Hertfordshire, SG12 0NB

£389,995

JONATHAN HUNT are pleased to offer this spacious three bedroom family home located within a small quiet cul de sac. The property features THREE RECEPTION ROOMS, Cloakroom, Kitchen/Breakfast room and a large driveway for FOUR CARS. Viewing recommended

Buntingford Branch - Company No. 10303541 VAT No. 10303541

Ware Branch - Company No. 4759215 VAT No. 700174975

33 Whiteley Close, Dane End, Hertfordshire, SG12 0NB

ENTRANCE HALLWAY



STUDY 8'11" x 7'10" (2.74 x 2.39)



CLOAKROOM

KITCHEN 15'3" x 7'4" (4.65 x 2.24)



CONSERVATORY 12'4" x 9'10" (3.76 x 3)



LIVING ROOM 20'11" x 10'7" (6.4 x 3.23)



FIRST FLOOR

BEDROOM 12'0" x 8'6" (3.66 x 2.6)



33 Whiteley Close, Dane End, Hertfordshire, SG12 0NB

BEDROOM 10'9" x 8'5" (3.3 x 2.59)



BEDROOM 12'0" x 8'7" (3.66 x 2.64)

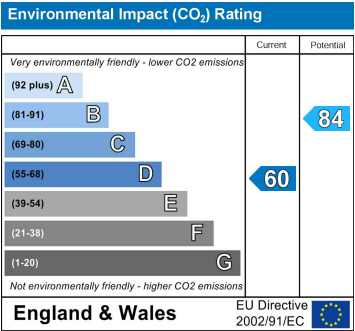
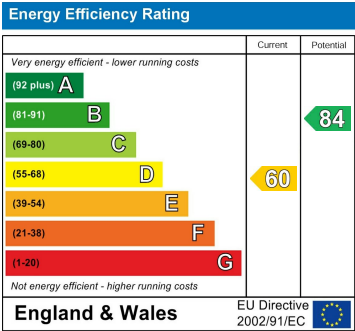

BATHROOM



EXTERIOR

REAR GARDEN

DRIVEWAY FOR FOUR CARS

Ground Floor

Approx. 60.5 sq. metres (651.7 sq. feet)



First Floor

Approx. 36.6 sq. metres (394.1 sq. feet)

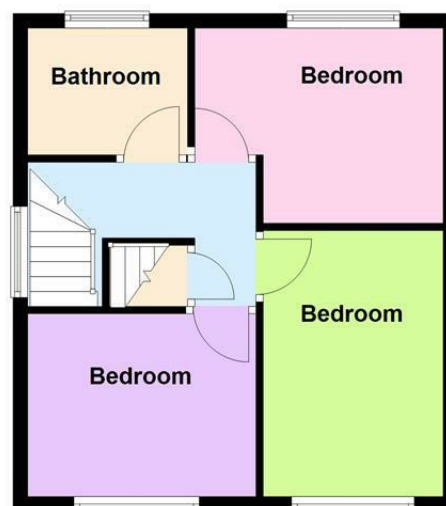

Total area: approx. 97.2 sq. metres (1045.8 sq. feet)

Whilst every attempt has been made to ensure the accuracy of the floor plan contained here, measurements of doors, windows, rooms and any other item are approximate and no responsibility is taken for any error, omission, or misstatement. This plan is for illustrative purposes only and should only be used as such by any prospective purchaser.
Plan produced using PlanUp.