

Jonathan Hunt

ESTATE AGENCY

20 High Street Ware SG12 9BX

Tel: 01920 411090

8 High Street Buntingford SG9 9AG

Tel: 01763 272727

info@jonathan-hunt.co.uk

www.jonathanhunt.co.uk

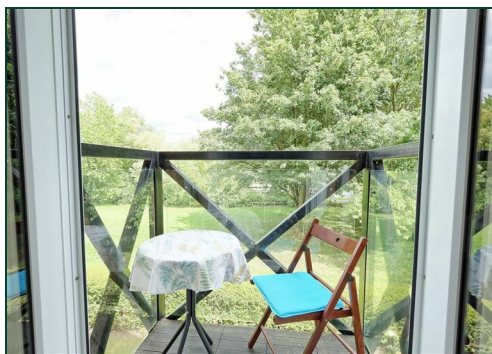

29 Lee Close, Stanstead Abbots, SG12 8JN

£275,000

LEASE EXTENSION APPLIED FOR - JONATHAN HUNT are pleased to offer this TWO BEDROOM FIRST FLOOR APARTMENT located within this riverside development close to amenities and St Margarets rail link to London Liverpool Street. The property features a refitted Kitchen and Bathroom and balcony to the Living room with river views.

Buntingford Branch - Company No. 10303541 VAT No. 10303541

Ware Branch - Company No. 4759215 VAT No. 700174975

29 Lee Close, Stanstead Abbots, SG12 8JN

ENTRANCE HALLWAY



BEDROOM ONE 13'1" x 9'6" (4 x 2.9)



BEDROOM TWO 9'6" x 7'2" (2.9 x 2.2)



LIVING DINING ROOM 18'6" x 9'10" (5.64 x 3)



KITCHEN 10'6" x 7'2" (3.21 x 2.19)



BATHROOM



29 Lee Close, Stanstead Abbots, SG12 8JN

BALCONY



EXTERIOR



COMMUNAL GARDENS



PARKING

COUNCIL TAX BAND C



Energy Efficiency Rating		
	Current	Potential
Very energy efficient - lower running costs		
(92 plus) A		
(81-91) B		
(69-80) C		
(55-68) D		
(39-54) E		
(21-38) F		
(1-20) G		
Not energy efficient - higher running costs		
England & Wales	EU Directive 2002/91/EC	EU Directive 2002/91/EC

Environmental Impact (CO ₂) Rating		
	Current	Potential
Very environmentally friendly - lower CO ₂ emissions		
(92 plus) A		
(81-91) B		
(69-80) C		
(55-68) D		
(39-54) E		
(21-38) F		
(1-20) G		
Not environmentally friendly - higher CO ₂ emissions		
England & Wales	EU Directive 2002/91/EC	EU Directive 2002/91/EC

Approx. 54.6 sq. metres (587.5 sq. feet)

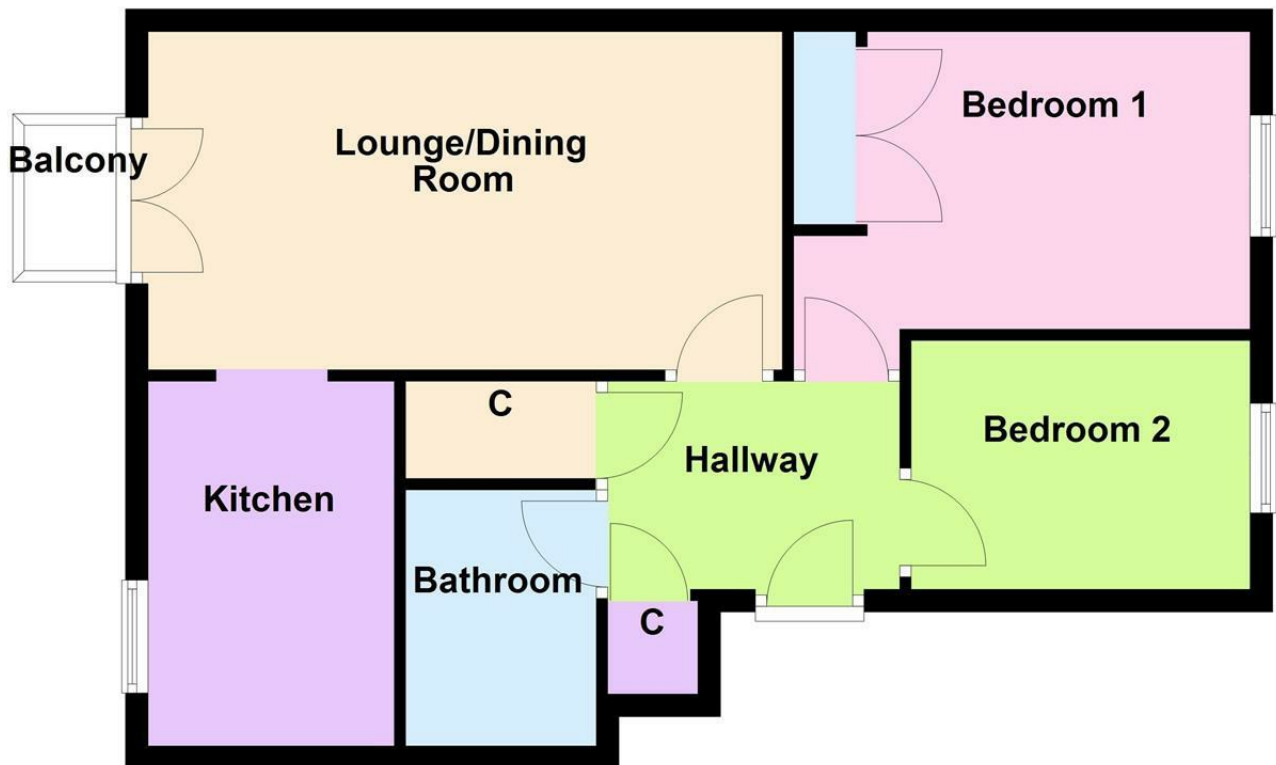

Total area: approx. 54.6 sq. metres (587.5 sq. feet)

Whilst every attempt has been made to ensure the accuracy of the floor plan contained here, measurements of doors, windows, rooms and any other item are approximate and no responsibility is taken for any error, omission, or misstatement. This plan is for illustrative purposes only and should only be used as such by any prospective purchaser.

Plan produced using PlanUp.