

Jonathan Hunt

ESTATE AGENCY

20 High Street Ware SG12 9BX

Tel: 01920 411090

8 High Street Buntingford SG9 9AG

Tel: 01763 272727

info@jonathan-hunt.co.uk

www.jonathanhunt.co.uk



11 Downfield Road, Hertford Heath, SG13 7RX

Offers In Excess Of £600,000

JONATHAN HUNT are please to offer FULLY REFURBISHED AND EXTENDED three bedroom family home. The property has undergone extensive works to include a wonderful Kitchen extension with Bi-Folding doors to the LANDSCAPED GARDENS. The property benefits from a ground floor Cloakroom, Utility room, family bathroom and Ensuite to the master. The property is positioned within the highly desirable village location and is OFFERED CHAIN FREE.

Buntingford Branch - Company No. 10303541 VAT No. 10303541

Ware Branch - Company No. 4759215 VAT No. 700174975

11 Downfield Road, Hertford Heath, SG13 7RX

ENTRANCE HALL

LIVING ROOM 13'10" x 11'9" (4.24 x 3.6)



DINING ROOM 12'4" x 8'8" (3.78 x 2.66)



KITCHEN/BREAKFAST ROOM 15'7" x 14'5" (4.75 x 4.4)



UTILITY



FIRST FLOOR

BEDROOM ONE 14'0" x 10'9" (4.27 x 3.3)



ENSUITE



BEDROOM TWO 10'2" x 9'4" (3.12 x 2.86)



11 Downfield Road, Hertford Heath, SG13 7RX

BEDROOM THREE 9'10" x 6'11" (3 x 2.11)



EXTERIOR



BATHROOM



DRIVEWAY



REAR GARDEN



COUNCIL TAX BAND - D

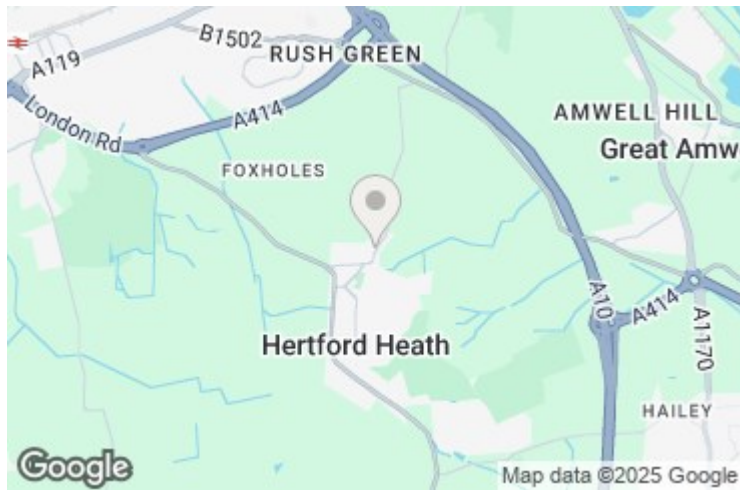

11 Downfield Road, Hertford Heath, SG13 7RX

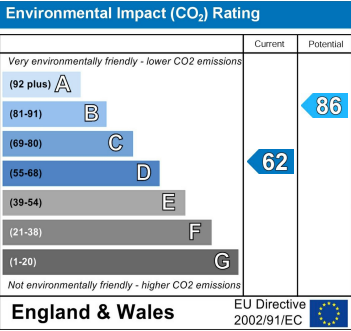
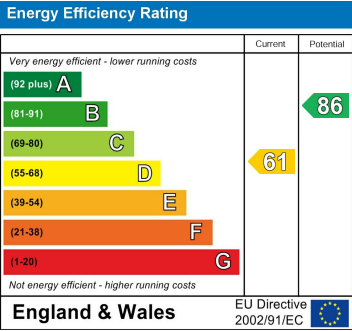

Ground Floor

Approx. 55.4 sq. metres (596.8 sq. feet)

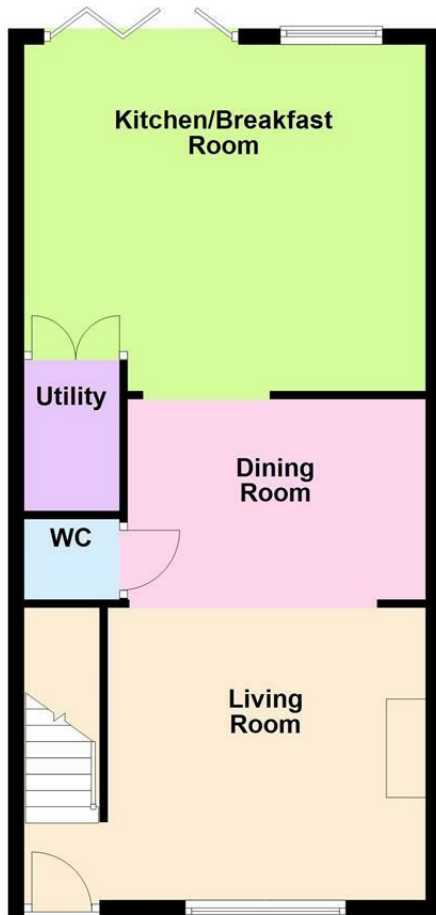

First Floor

Approx. 42.1 sq. metres (453.4 sq. feet)



Total area: approx. 97.6 sq. metres (1050.3 sq. feet)

Whilst every attempt has been made to ensure the accuracy of the floor plan contained here, measurements of doors, windows, rooms and any other item are approximate and no responsibility is taken for any error, omission, or misstatement. This plan is for illustrative purposes only and should only be used as such by any prospective purchaser.

Plan produced using PlanUp.