

# Jonathan Hunt

ESTATE AGENCY

20 High Street Ware SG12 9BX

Tel: 01920 411090

8 High Street Buntingford SG9 9AG

Tel: 01763 272727

info@jonathan-hunt.co.uk

www.jonathanhunt.co.uk



**84 Kingsway, Ware, Hertfordshire, SG12 0QJ**

**£575,000**

JONATHAN HUNT are pleased to offer this well presented three bedroom semi detached family home located on the sought after Kingshill development. The property offers a spacious Living room with Conservatory, Kitchen/Dining room and a refitted Bathroom. Externally the property features south facing gardens and off street parking to the front.

Buntingford Branch - Company No. 10303541 VAT No. 10303541

Ware Branch - Company No. 4759215 VAT No. 700174975

**84 Kingsway, Ware, Hertfordshire, SG12 0QJ**

**ENTRANCE HALL**

**LIVING ROOM 20'9" x 13'9" (6.35 x 4.2)**



**CONSERVATORY 11'7" x 8'3" (3.55 x 2.52)**



**FIRST FLOOR LANDING**

**KITCHEN/DINING ROOM 23'10" x 11'1" narr to 7'7" (7.28 x 3.38 narr to 2.33)**



**BEDROOM ONE 13'11" x 11'7" (4.25 x 3.55)**



**DINING**



**BEDROOM TWO 14'11" x 8'3" (4.57 x 2.53)**



84 Kingsway, Ware, Hertfordshire, SG12 0QJ

BEDROOM THREE 11'0" x 9'6" (3.36 x 2.9)



REAR GARDEN



BATHROOM



EXTERIOR



W. C.

FRONT DRIVEWAY



COUNCIL TAX BAND - E

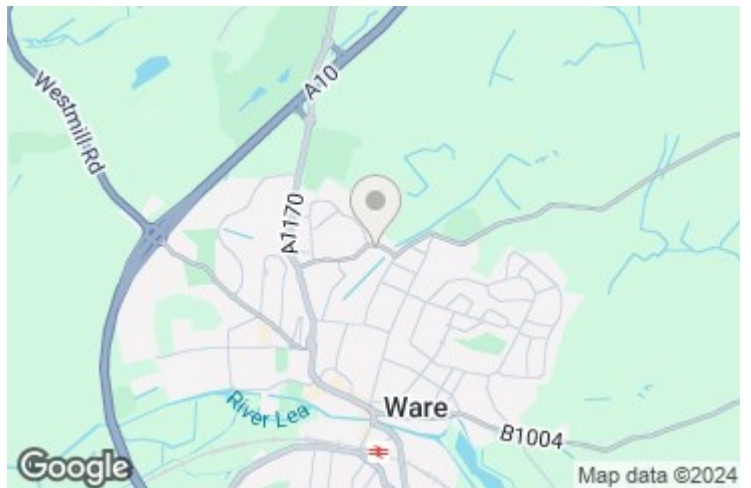

# 84 Kingsway, Ware, Hertfordshire, SG12 0QJ

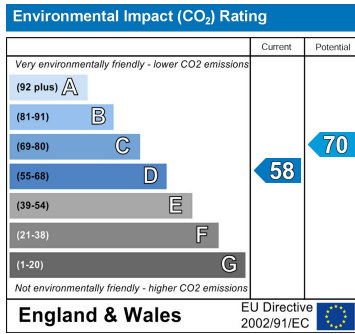
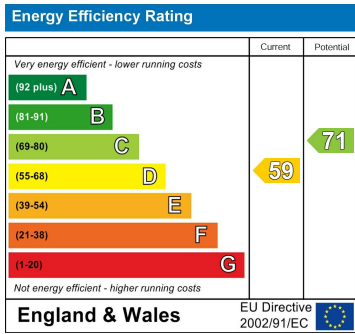

GROUND FLOOR

1ST FLOOR

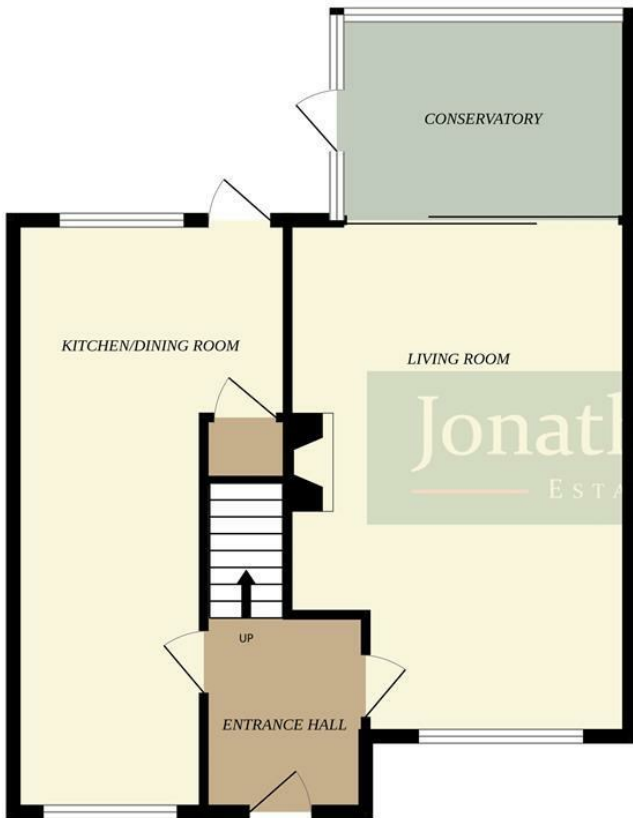

Whilst every attempt has been made to ensure the accuracy of the floorplan contained here, measurements of doors, windows, rooms and any other items are approximate and no responsibility is taken for any error, omission or mis-statement. This plan is for illustrative purposes only and should be used as such by any prospective purchaser. The services, systems and appliances shown have not been tested and no guarantee as to their operability or efficiency can be given.  
Made with MetroPix ©2024