

Jonathan Hunt

ESTATE AGENCY

20 High Street Ware SG12 9BX

Tel: 01920 411090

8 High Street Buntingford SG9 9AG

Tel: 01763 272727

info@jonathan-hunt.co.uk

www.jonathanhunt.co.uk



20 Redan Road, Ware, SG12 7NJ

Offers In Excess Of £440,000

JONATHAN HUNT are pleased to offer this traditional THREE BEDROOM VICTORIAN HOME featuring a newly converted loft offering a master bedroom with dressing and ensuite. The ground floor offers two reception rooms with wood flooring and a recently fitted Kitchen. The first floor offers two further bedrooms and a family bathroom. Externally the property features courtyard front gardens and enclosed gardens to the rear.

Buntingford Branch - Company No. 10303541 VAT No. 10303541

Ware Branch - Company No. 4759215 VAT No. 700174975

20 Redan Road, Ware, SG12 7NJ

ENTRANCE PORCH

LIVING ROOM 12'0" x 11'10" (3.68 x 3.63)



KITCHEN 11'8" x 6'6" (3.56 x 2)



FEATURE FIREPLACE



FIRST FLOOR



DINING ROOM 12'0" x 12'0" narr to 9'2" (3.67 x 3.67 narr to 2.8)



BEDROOM TWO 12'0" x 12'0" (3.67 x 3.67)

BEDROOM THREE 12'3" x 5'6" (3.75 x 1.7)



20 Redan Road, Ware, SG12 7NJ

BATHROOM



ENSUITE



SECOND FLOOR



REAR GARDENS

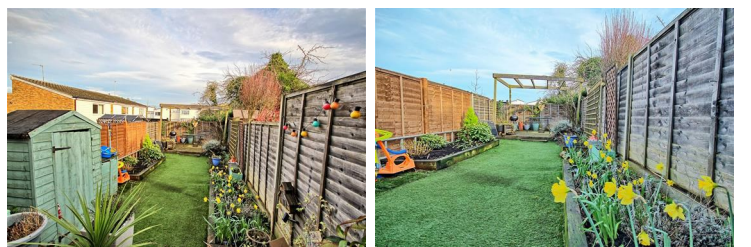

EXTERIOR



MASTER BEDROOM 18'4" x 9'10" narr to 7'8" (5.6 x 3 narr to 2.36)



FRONT

COUNCIL TAX BAND - C

DRESSING AREA

20 Redan Road, Ware, SG12 7NJ



Energy Efficiency Rating		Current	Potential
Very energy efficient - lower running costs			
(92 plus) A			85
(81-91) B			
(69-80) C			
(55-68) D		65	
(39-54) E			
(21-38) F			
(1-20) G			
Not energy efficient - higher running costs			
England & Wales		EU Directive 2002/91/EC	

Environmental Impact (CO ₂) Rating		
	Current	Potential
Very environmentally friendly - lower CO ₂ emissions		
(92 plus) A		85
(81-91) B		
(69-80) C		
(55-68) D	65	
(39-54) E		
(21-38) F		
(1-20) G		
Not environmentally friendly - higher CO ₂ emissions		
England & Wales		EU Directive 2002/91/EC 

GROUND FLOOR

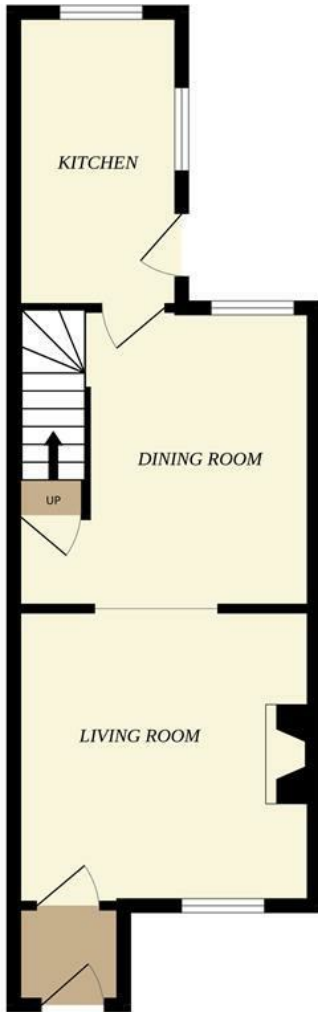

1ST FLOOR

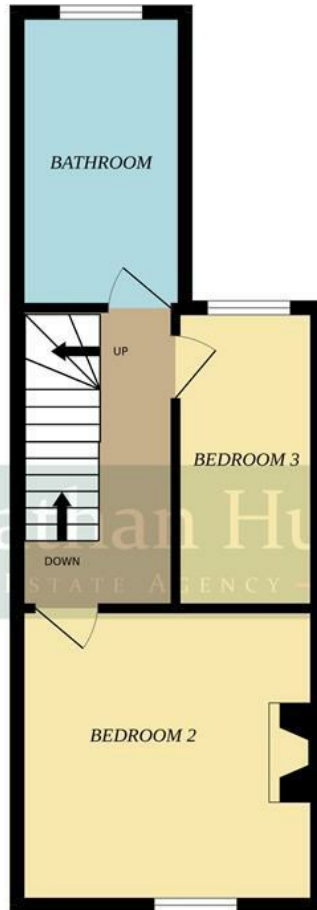

2ND FLOOR

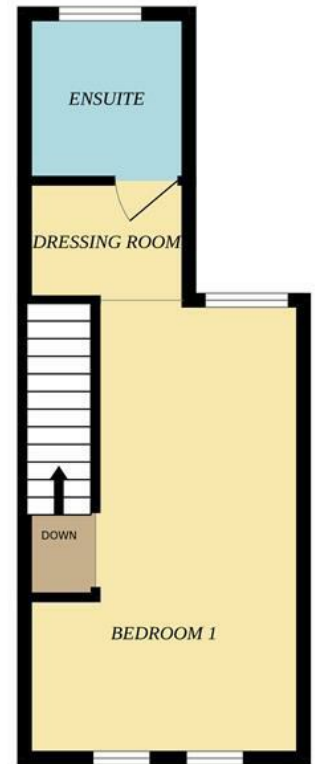

Whilst every attempt has been made to ensure the accuracy of the floorplan contained here, measurements of doors, windows, rooms and any other items are approximate and no responsibility is taken for any error, omission or mis-statement. This plan is for illustrative purposes only and should be used as such by any prospective purchaser. The services, systems and appliances shown have not been tested and no guarantee as to their operability or efficiency can be given.
Made with Metropix ©2024