

Jonathan Hunt

ESTATE AGENCY

20 High Street Ware SG12 9BX

Tel: 01920 411090

8 High Street Buntingford SG9 9AG

Tel: 01763 272727

info@jonathan-hunt.co.uk

www.jonathanhunt.co.uk



21 Hartfield Court, Ware, SG12 7LT

£189,950

JONATHAN HUNT are pleased to offer this two bedroom GROUND FLOOR GARDEN APARTMENT located within this retirement development. The property features updated accommodation to include a refitted Kitchen and shower room. The Living room features patio doors leading on to the gardens which enjoy a south westerly aspect.
EXTENDED LEASE AND CHAIN FREE

21 Hartfield Court, Ware, SG12 7LT

ENTRANCE HALLWAY

LIVING ROOM 14'3" x 9'5" (4.36 x 2.89)



BEDROOM TWO 10'9" x 5'8" (3.30 x 1.75)



KITCHEN 9'8" x 5'11" (2.97 x 1.82)



SHOWER ROOM 8'4" x 5'9" (2.56 x 1.76)



BEDROOM ONE 13'6" x 8'4" (4.14 x 2.56)



EXTERIOR



21 Hartfield Court, Ware, SG12 7LT

GARDENS



COUNCIL TAX BAND - B



Energy Efficiency Rating		Current	Potential
Very energy efficient - lower running costs			
(92 plus) A			
(81-91) B			
(69-80) C			
(55-68) D			
(39-54) E			
(21-38) F			
(1-20) G			
Not energy efficient - higher running costs			
		74	81
England & Wales		EU Directive 2002/91/EC	

Environmental Impact (CO ₂) Rating		Current	Potential
Very environmentally friendly - lower CO ₂ emissions			
(92 plus) A			
(81-91) B			
(69-80) C			
(55-68) D			
(39-54) E			
(21-38) F			
(1-20) G			
Not environmentally friendly - higher CO ₂ emissions			
		75	81
England & Wales		EU Directive 2002/91/EC	

GROUND FLOOR
472 sq.ft. (43.9 sq.m.) approx.

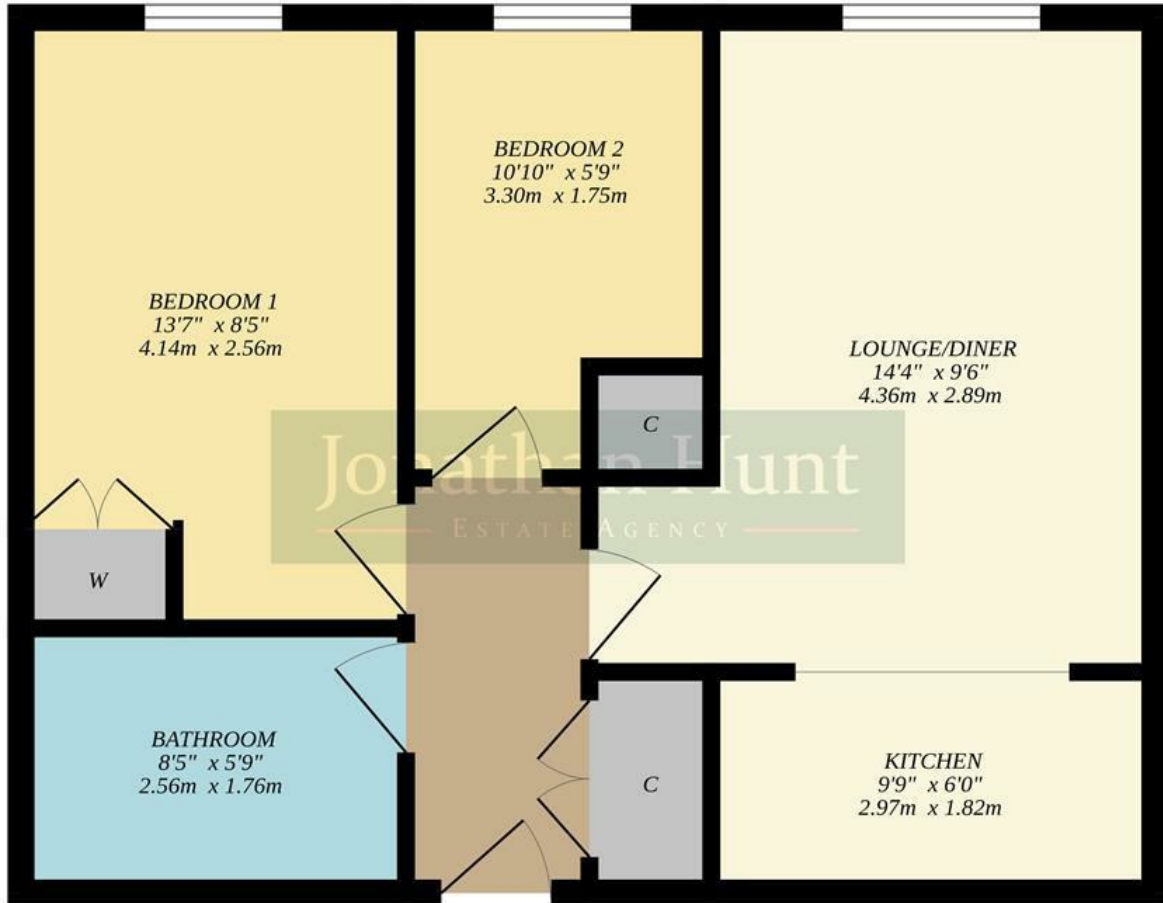

TOTAL FLOOR AREA: 472 sq.ft. (43.9 sq.m.) approx.

Whilst every attempt has been made to ensure the accuracy of the floorplan contained here, measurements of doors, windows, rooms and any other items are approximate and no responsibility is taken for any error, omission or mis-statement. This plan is for illustrative purposes only and should be used as such by any prospective purchaser. The services, systems and appliances shown have not been tested and no guarantee as to their operability or efficiency can be given.
Made with Metropix ©2023