

Jonathan Hunt

ESTATE AGENCY

20 High Street Ware SG12 9BX

Tel: 01920 411090

8 High Street Buntingford SG9 9AG

Tel: 01763 272727

info@jonathan-hunt.co.uk

www.jonathanhunt.co.uk



99 Musley Hill, Ware, SG12 7NQ

Offers In Excess Of £625,000

JONATHAN HUNT are pleased to offer this deceptively spacious FOUR BEDROOM VICTORIAN home located just 10 minutes walk from Ware town centre. This rarely available character home offers many original features and in particular 100ft + rear garden with a Westerly aspect. An internal viewing is highly recommended to appreciate this fabulous home.

Buntingford Branch - Company No. 10303541 VAT No. 10303541

Ware Branch - Company No. 4759215 VAT No. 700174975

99 Musley Hill, Ware, SG12 7NQ

ENTRANCE HALLWAY

LIVING ROOM 11'11" x 11'11" (3.65 x 3.64)



FIRST FLOOR



BEDROOM ONE 15'5" x 12'1" (4.72 x 3.69)



DINING ROOM 15'6" x 11'10" (4.74 x 3.62)



FAMILY BATHROOM 9'10" x 9'6" (3.01 x 2.91)



KITCHEN/BREAKFAST ROOM 13'6" x 10'2" (4.12 x 3.11)



SHOWER ROOM 4'9" x 4'3" (1.47 x 1.30)

SECOND FLOOR



BEDROOM TWO 12'5" x 11'11" (3.79 x 3.64)



BEDROOM THREE 10'2" x 10'1" (3.10 x 3.08)



BEDROOM FOUR 8'10" x 6'5" (2.71 x 1.97)



EXTERIOR



REAR GARDENS



HOME OFFICE/SUMMER HOUSE



FRONT

COUNCIL TAX BAND - D

99 Musley Hill, Ware, SG12 7NQ

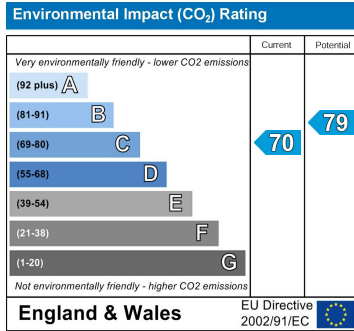
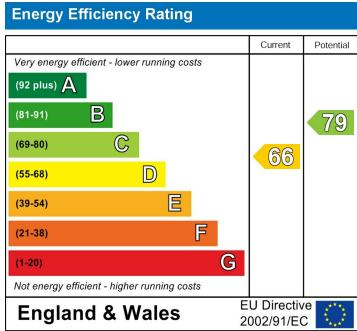

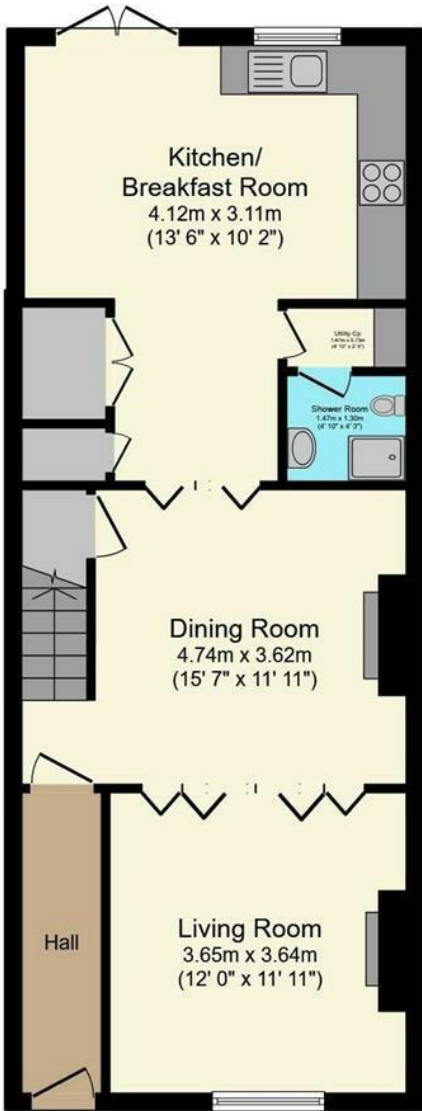

Ground Floor



First Floor

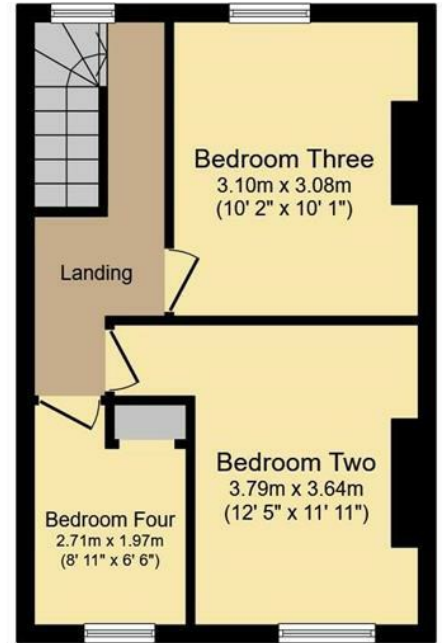

Second Floor

Total floor area 130.6 sq.m. (1,405 sq.ft.) approx

This floor plan is for illustrative purposes only. It is not drawn to scale. Any measurements, floor areas (including any total floor area), openings and orientation are approximate. No details are guaranteed, they cannot be relied upon for any purpose and they do not form part of any agreement. No liability is taken for any error, omission