



**EPC - D**

These particulars are prepared diligently and all reasonable steps are taken to ensure their accuracy. Neither the company or a seller will however be under any liability to any purchaser or prospective purchaser in respect of them. The description, Dimensions and all other information is believed to be correct, but their accuracy is no way guaranteed. The services have not been tested.

**Any floor plans shown are for identification purposes only and are not to scale**

Directors: Paul Carruthers Stephen Luck

7 Longridge Avenue  
Saltdean. BN2 8LG  
Tel: **01273 303064**  
e:saltdean@carruthersandluck.co.uk

Also at:  
233a South Coast Road, Peacehaven. BN10 8LD  
e:peacehaven@carruthersandluck.co.uk

Lettings department:  
233a South Coast Road, BN10 8LD  
e: lettings@carruthersandluck.co.uk  
Company registration no: 08884155



Find us on Facebook  
Carruthers Luck



Follow us on Twitter!  
@CarruthersLuck



# C&L

**carruthersandluck**  
salesandlettings

**72 Chichester Drive West, Saltdean, BN2 8SF**  
**£595,000**



[www.carruthersandluck.co.uk](http://www.carruthersandluck.co.uk)

A very spacious and extremely well presented detached 3 bedroom bungalow situated in one of Saltdean's sought after roads, just a few yards from Lustrells vale's shops, bus services giving frequent access to Brighton City Centre and close to Saltdean Primary School. Saltdean Park is also just around the corner and the seafront with beach access is about a 10 minute walk.

The present owner has completely modernised the property to a high standard to include new Gas central heating including a Worcester Bosch boiler, a superb Kitchen, refitted bathroom, replastered walls and beautifully kept newly landscaped gardens. The property offers exceptionally bright and spacious rooms and an internal viewing is highly recommended.

The Spacious Entrance hall runs from front to back and gives the property an immediate feeling of light and space. The lounge is to the rear of the property and opens up into a nice dining area with full width windows and doors to the rear garden. The Kitchen/Dining room has been refitted with white high gloss handless base units finished with solid natural wood work surfaces. There are 'Neff' integrated appliances to include an oven, hob, cooker hood, dishwasher, washing machine and fridge/freezer. There is plenty of space for a large table and the kitchen is finished with a high quality porcelain tiled floor. There are 3 windows with fitted blinds and a door to the garden.

The 3 bedrooms are all double rooms and have oak flooring and windows with fitted blinds. The bathroom has again been fitted to a high standard and has fully tiled walls and a tiled floor. Outside, the property has a garage to one side with power and light and its own private driveway. The front garden is very neatly laid to lawn with a central path to the front door. The rear garden is south facing and very private. The current owners have invested a lot of time into the garden and it has well stocked borders and a neat lawn area.

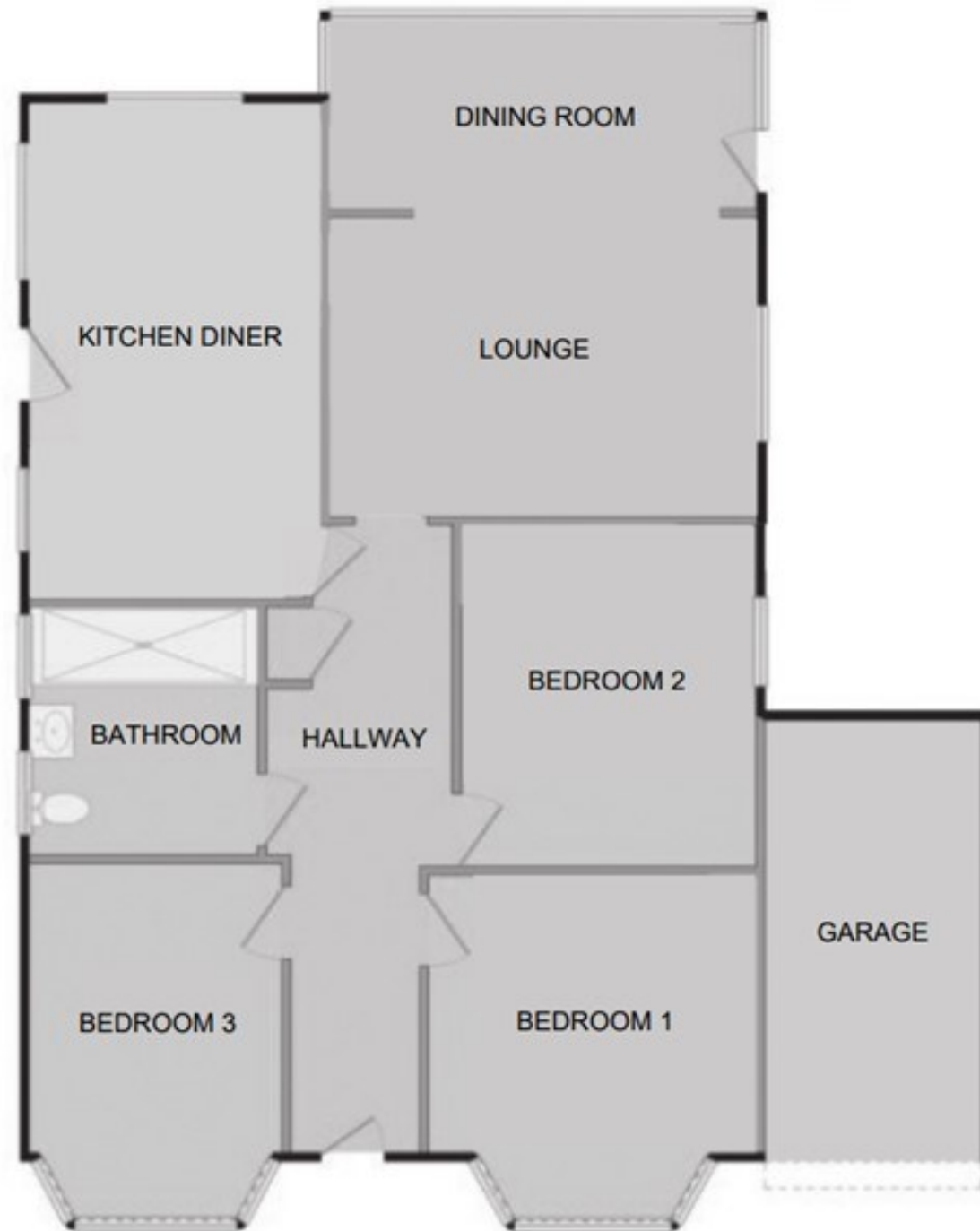

#### ENTRANCE HALL

**LOUNGE 18'4" x 11' (5.59m x 3.35m)**

**DINING ROOM 18'4" x 7' (5.59m x 2.13m)**

**KITCHEN/DINING ROOM 18' x 10'9" (5.49m x 3.28m)**

**BEDROOM 1 12'8" x 10'11" (3.86m x 3.33m)**

**BEDROOM 2 12'1" x 10'3" (3.68m x 3.12m)**

**BEDROOM 3 10'8" x 9'4" (3.25m x 2.84m)**

**BATHROOM 9'2" x 8'5" (2.79m x 2.56m)**

**GARAGE 16' x 8' (4.88m x 2.44m)**