



Liverpool Road, N7

£750,000

A three double bedroom Maisonette overlooking St. Mary Magdalene Gardens on Liverpool road. This property has an eat-in kitchen leading onto a private roof terrace, a family bathroom and a separate living room with space for Dining area.

Ideally located under half a mile from Highbury and Islington Station on Victoria Line. This maisonette has a wealth of restaurants and shops very close by on Upper Street and Holloway road.

Features

Maisonette
Terrace
Three Double Bedrooms
Family Bathroom
Close to transport

Liverpool Road, London, N7

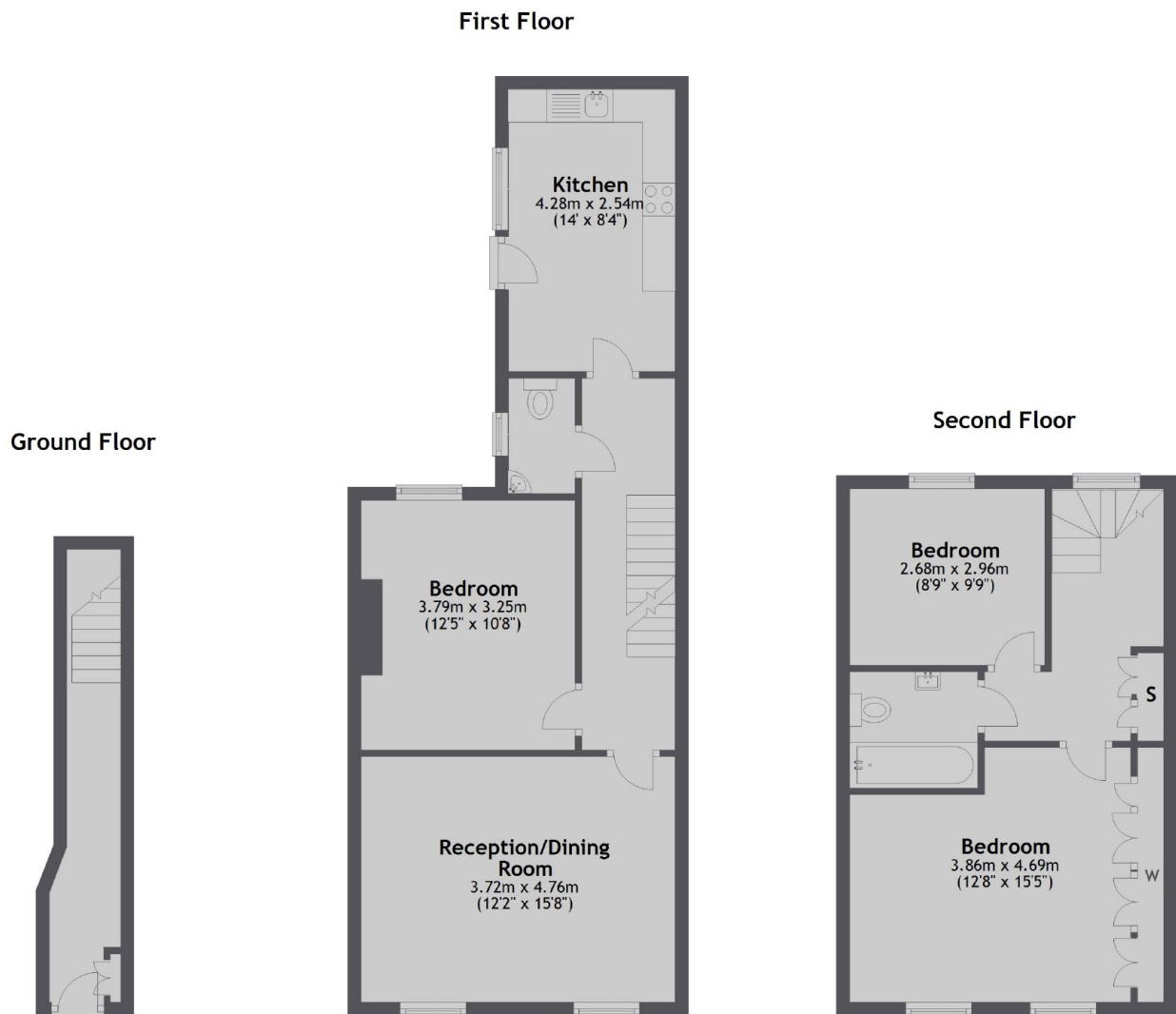

Total area: approx. 95.3 sq. metres (1026.1 sq. feet)

Contact

To arrange a viewing call our office on the number below or visit our website.



Energy Rating: E. We aim to make our particulars both accurate and reliable. However they are not guaranteed; nor do they form part of an offer or contract. If you require clarification on any points then please contact us, especially if you're traveling some distance to view. Please note that appliances and heating systems have not been tested and therefore no warranties can be given as to their good working order.