

Queensland Road, N7

£392 Per week

A well presented one bedroom apartment in a new build development with access to a communal garden. This flat has a semi open plan living room/kitchen, a large private balcony and a good sized modern bathroom.

Located just a short walk to Holloway Road Station (Piccadilly line) which is just two stops to King's Cross. Drayton Park station is located 0.4miles away, providing access to the City.

Features

- One Bedroom
- Wooden Flooring
- Private Balcony
- Modern Development
- Lift Access
- Secure Bike Storage

Queensland Road, London, N7

Third Floor

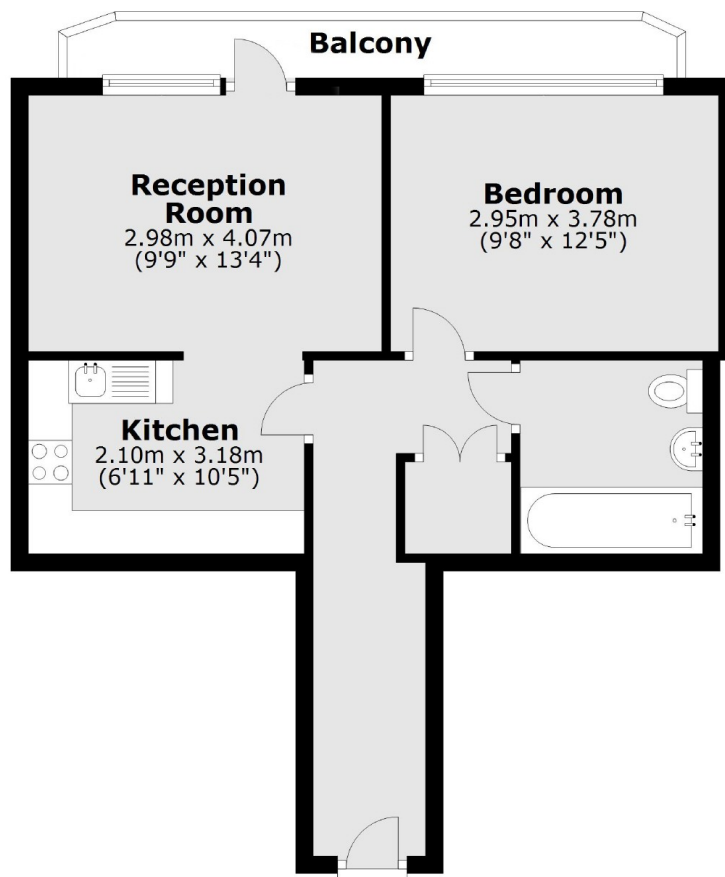

Main area: Approx. 46.2 sq. metres (497.0 sq. feet)
Plus balconies, approx. 5.3 sq. metres (56.6 sq. feet)

Contact

To arrange a viewing call our office on the number below or visit our website.



Energy Rating: . We aim to make our particulars both accurate and reliable. However they are not guaranteed; nor do they form part of an offer or contract. If you require clarification on any points then please contact us, especially if you're traveling some distance to view. Please note that appliances and heating systems have not been tested and therefore no warranties can be given as to their good working order.