



Naoroji Street, WC1X

£825,000

This spacious, first floor lateral apartment comprises; Entrance hall, two double bedrooms with built-in wardrobes, ample storage space, and two bathrooms (ensuite to master).

The large reception/diner with semi-open plan kitchen annexed to the rear, offers integrated appliances, including dishwasher and washing machine. There is also a private west-facing balcony directly accessed via the living area.

This apartment also comes with a secure underground parking space.

Features

- Three Bedrooms
- Secured Underground Parking
- Private Terrace
- Concierge
- Underfloor Heating

West City One is a private, portered development positioned just north of Rosebery Avenue on the upper end of Margery Street. Sadlers Wells theatre and the eateries of Exmouth Market are within a short walk. Angel tube station and the popular Upper Street are also under ten minutes walk away, whilst Kings Cross St Pancras is within easy

Naoroji Street, London, WC1X

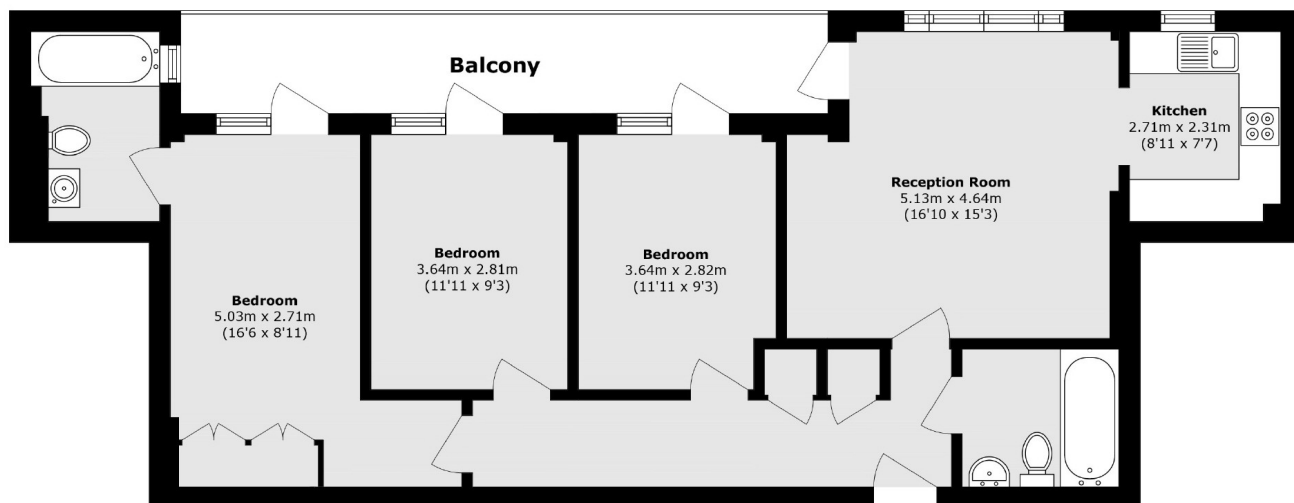

Total area (approx.): 85.1 sq. m (916.0 sq. ft)
Balcony area (approx.): 11.1 sq. m (119.4 sq. ft)