



Coleman Fields, N1

£575,000

A well presented two bedroom flat located on a quiet street and conveniently located near transport and green space. This property benefits from open plan living, lots of light and is being offered chain free.

Island Apartments offers superb transport links at approximately three quarters of a mile between both Angel and Highbury & Islington stations. The boutiques, bars and restaurants provided by Upper Street and Essex Road are also within walking distance.

Features

Two Bedroom
Wooden Floors
Open Plan
Bright Interiors
Chain Free
SOF

Coleman Fields, London, N1

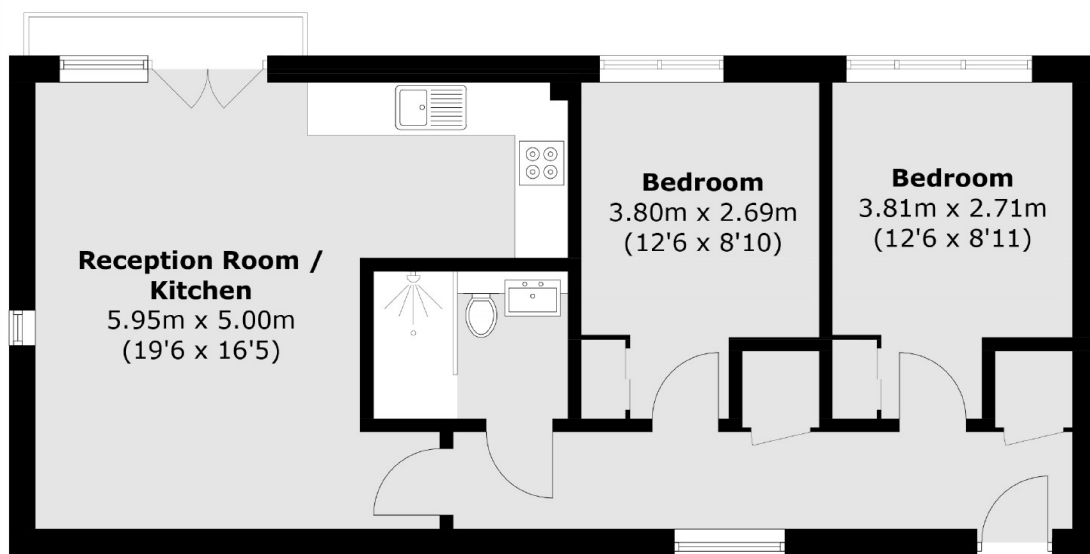

Total area (approx.): 59.6 sq. m (641.5 sq. ft)