



John Campbell Road, N16

£850,000

Immaculately presented, this three bedroom home is split across the top two floors of a Victorian conversion. There are hard wood floors throughout, and the south facing reception room is flooded with natural light. The separate kitchen to the rear of the property leads directly out to a private garden. Being offered with a share of the freehold.

John Campbell Road is a tree lined, no through road which is ideally located between the many shops, restaurants and bars that both Dalston and Newington Green have to offer. Dalston Kingsland Overground is a short walk away, which links you to the Victoria line in just under 5 minutes, and the many bus routes that link you to the City.

Features

- Three Bedrooms
- Private Garden
- Share of Freehold
- No Through Road
- Top Floors
- Victorian Conversion

John Campbell Road, London, N16

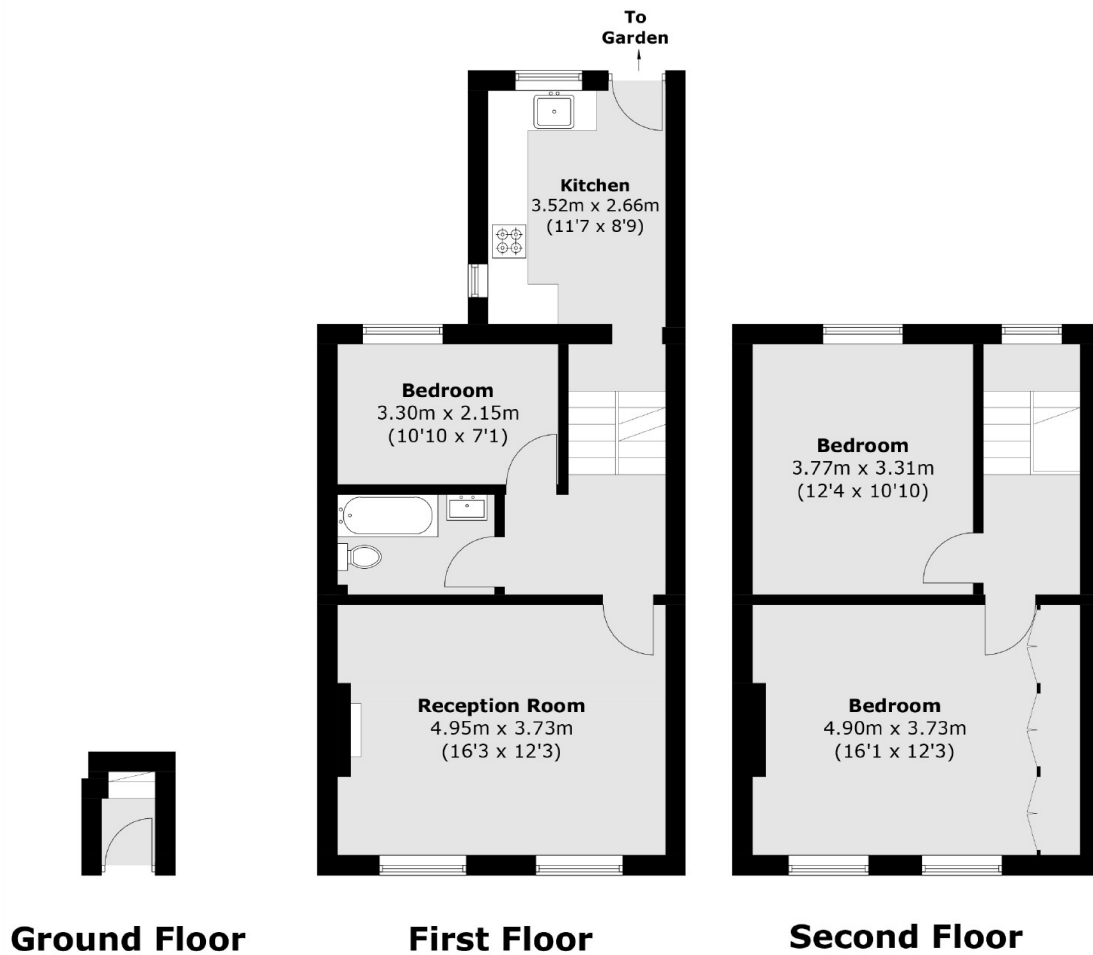

Total area (approx.): 86.3 sq. m (928.8 sq. ft)